

10. Rear Crossmember (FWD Model)

A: REMOVAL

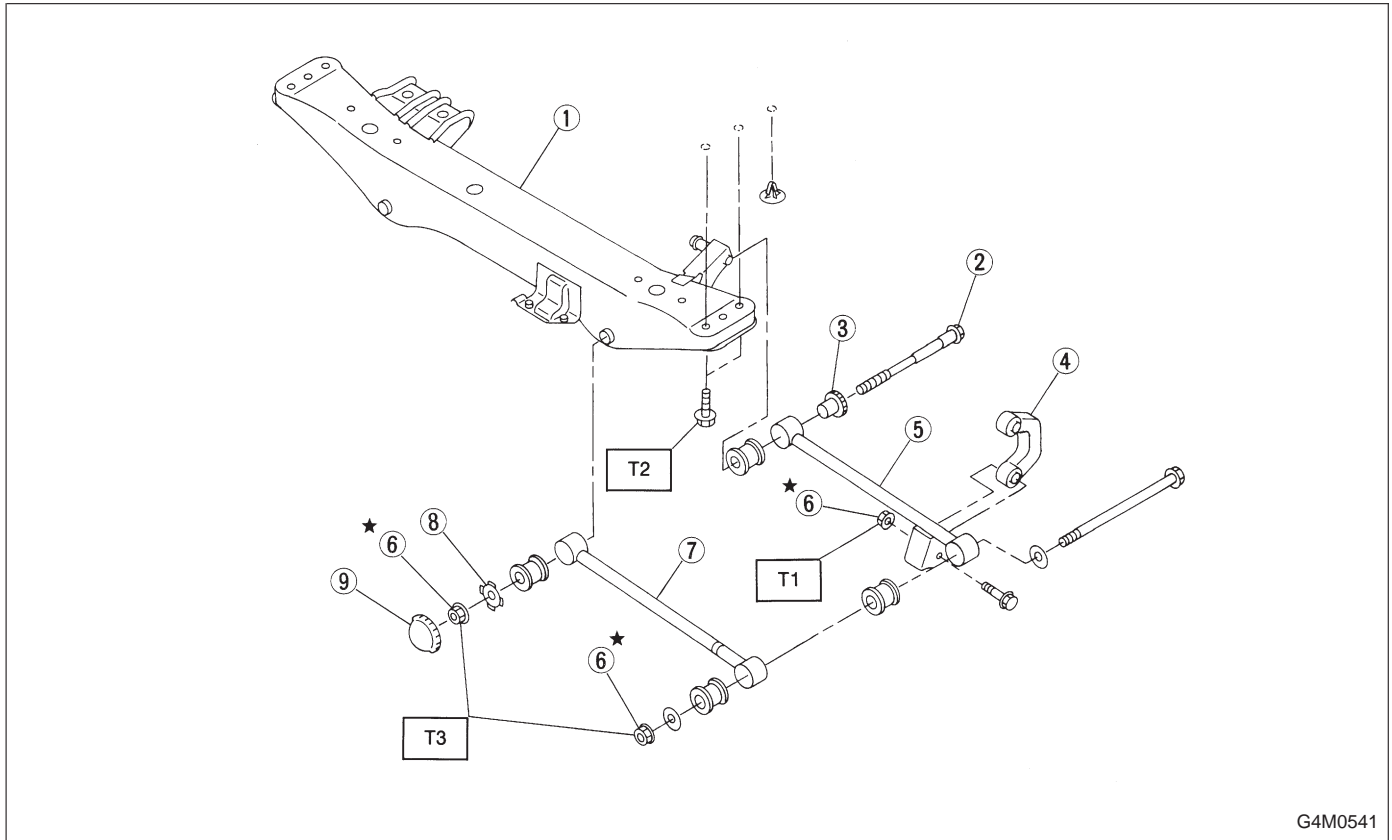

- | | |
|---------------------|----------------------|
| ① Crossmember | ⑥ Self-locking nut |
| ② Adjusting bolt | ⑦ Front lateral link |
| ③ Adjusting wheel | ⑧ Washer |
| ④ Stabilizer link | ⑨ Cap (Protection) |
| ⑤ Rear lateral link | |

Tightening torque: N·m (kg·m, ft·lb)

T1: 44±6 (4.5±0.6, 32.5±4.3)

T2: 127±20 (13.0±2.0, 94±14)

T3: 137±20 (14.0±2.0, 101±14)

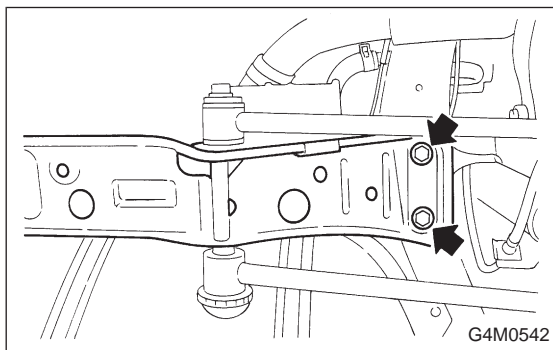

- 1) Disconnect lateral links from housing.
- 2) Remove rear exhaust pipe and muffler.
- 3) Remove heat-shield cover.
- 4) Remove four bolts securing crossmember to body.

B: INSPECTION

Check removed parts for wear, damage and cracks, and correct or replace if defective.

C: INSTALLATION

Installation is in reverse order of removal procedure.

CAUTION:

- **Discard loosened self-locking nut and replace with a new one.**
- **Always tighten nut (not adjusting bolt), when tightening adjusting bolt.**
- **Always tighten rubber bushing when wheels are in full contact with the ground and vehicle is at curb weight condition.**

NOTE:

Check wheel alignment and adjust if necessary.