

### 5. Transmission Case, Transmission Cover and Control Device

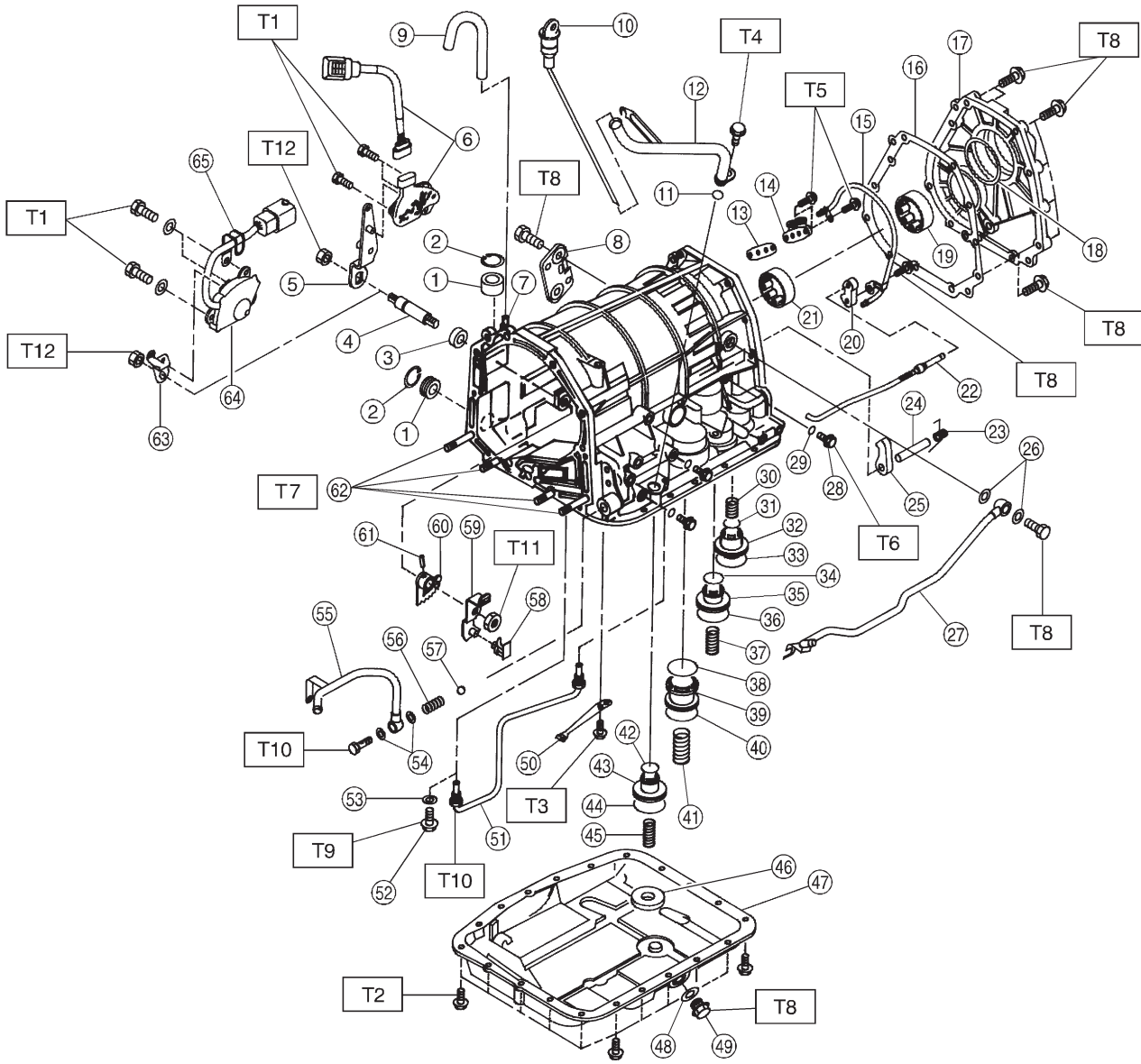

- ① Plug
- ② Snap ring
- ③ Oil seal
- ④ Manual shaft
- ⑤ Range select lever (Plastic body type)
- ⑥ Inhibitor switch ASSY (Plastic body type)
- ⑦ Nipple
- ⑧ Plate ASSY
- ⑨ Air breather hose
- ⑩ Oil level gauge
- ⑪ O-ring
- ⑫ Oil charger pipe
- ⑬ Gasket
- ⑭ Relief valve
- ⑮ Pipe
- ⑯ Gasket
- ⑰ Transmission cover (FWD model)
- ⑱ Shim
- ⑲ Roller bearing
- ⑳ Parking support
- ㉑ Ball bearing
- ㉒ Parking rod
- ㉓ Return spring
- ㉔ Shaft
- ㉕ Parking pawl
- ㉖ Gasket
- ㉗ Inlet pipe
- ㉘ Test plug
- ㉙ O-ring
- ㉚ Spring
- ㉛ O-ring
- ㉜ Accumulator piston (N-D)
- ㉝ O-ring
- ㉞ O-ring
- ㉟ Accumulator piston (2-3)
- ㊱ O-ring
- ㊲ Spring
- ㊳ O-ring
- ㊴ Accumulator piston (1-2)
- ㊵ O-ring

- ㊶ Spring
- ㊷ O-ring
- ㊸ Accumulator piston (3-4)
- ㊹ O-ring
- ㊺ Spring
- ㊻ Magnet
- ㊼ Oil pan
- ㊽ Gasket
- ㊾ Drain plug
- ㊿ Detention spring
- ① Pipe (AWD model)
- ② Plug (FWD model)
- ③ Gasket (FWD model)
- ④ Gasket
- ⑤ Outlet pipe
- ⑥ Spring
- ⑦ Ball
- ⑧ Stopper
- ⑨ Manual lever
- ⑩ Manual plate
- ⑪ Spring pin
- ⑫ Stud bolt
- ⑬ Range select lever (Aluminum body type)
- ⑭ Inhibitor switch (Aluminum body type)
- ⑮ Clip (Aluminum body type)

---

**Tightening torque: N·m (kg·m, ft·lb)**

- T1: 3.4±0.5 (0.35±0.05, 2.5±0.4)**
  - T2: 4.9±0.5 (0.50±0.05, 3.6±0.4)**
  - T3: 5.9±1.0 (0.60±0.10, 4.3±0.7)**
  - T4: 6.4±0.5 (0.65±0.05, 4.7±0.4)**
  - T5: 7.8±1.0 (0.80±0.10, 5.8±0.7)**
  - T6: 12.7±1.0 (1.30±0.10, 9.4±0.7)**
  - T7: 17.7±2.9 (1.80±0.30, 13.0±2.2)**
  - T8: 24.5±2.0 (2.50±0.20, 18.1±1.4)**
  - T9: 30.9±3.4 (3.15±0.35, 22.8±2.5)**
  - T10: 34.3±2.9 (3.50±0.30, 25.3±2.2)**
  - T11: 47.1±2.0 (4.80±0.20, 34.7±1.4)**
  - T12: 47.1±4.9 (4.80±0.50, 34.7±3.6)**
-