

6. Rear Gate and Glass

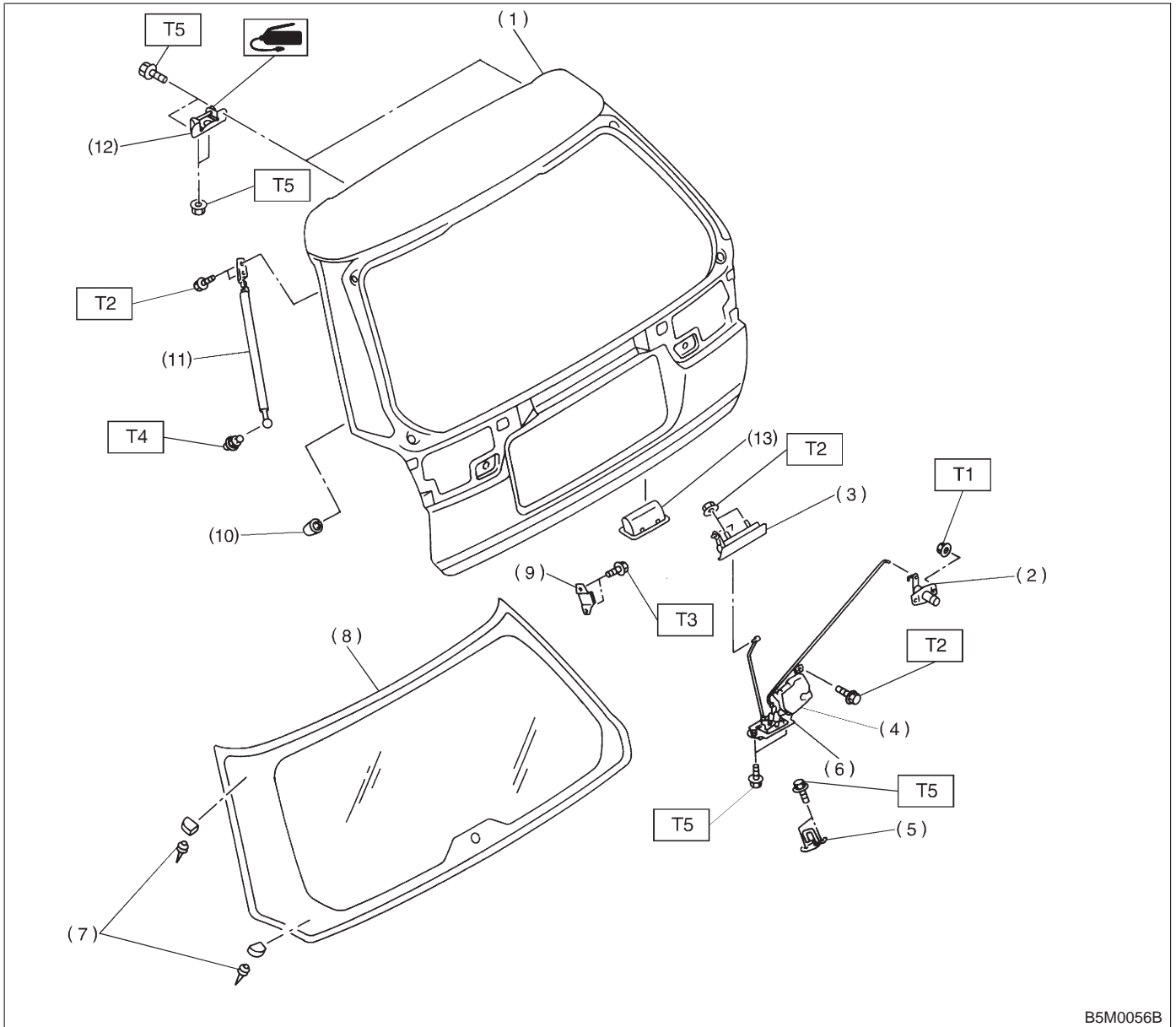

B5M0056B

- |                        |                       |
|------------------------|-----------------------|
| (1) Rear gate          | (8) Glass             |
| (2) Key cylinder       | (9) Buffer            |
| (3) Outer handle       | (10) Stopper          |
| (4) Door lock actuator | (11) Gas stay         |
| (5) Striker            | (12) Hinge            |
| (6) Latch              | (13) Rear gate handle |
| (7) Glass pin          |                       |

**Tightening torque: N-m (kg-m, ft-lb)**

**T1: 4.4±1.5 (0.45±0.15, 3.3±1.1)**

**T2: 7.4±2.0 (0.75±0.2, 5.4±1.4)**

**T3: 13±3 (1.3±0.3, 9.4±2.2)**

**T4: 14±4 (1.4±0.4, 10.1±2.9)**

**T5: 25±5 (2.5±0.5, 18.1±3.6)**