

9) Disconnect connector from main relay.

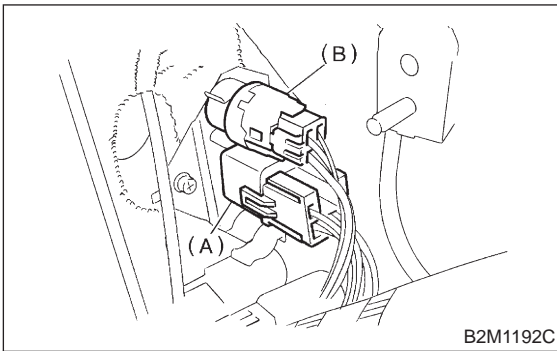

- (A) Main relay
- (B) Fuel pump relay

10) Installation is in the reverse order of removal.

17. Fuel Pump Relay

A: REMOVAL AND INSTALLATION

1) Disconnect battery ground cable.

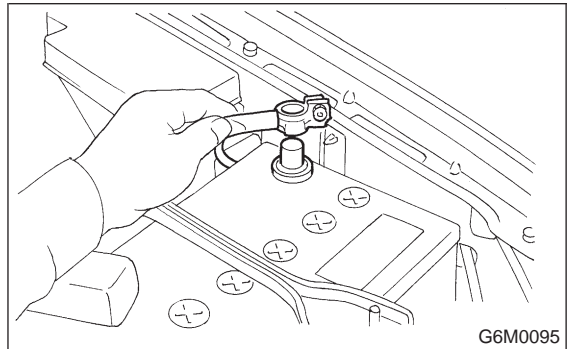

2) Remove lower cover and then disconnect connectors.

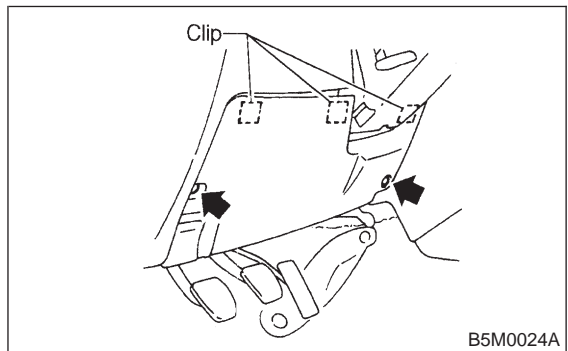

- 3) Lower transmission control module.
- 4) Remove the front pillar lower trim.
<Ref. to 5-3 [W5A1].>
- 5) Remove fuse box mounting nuts.
- 6) Lower fuse box.
- 7) Remove fuse box mounting bracket.
- 8) Remove fuel pump relay (A) from main relay and fuel pump relay mounting bracket.

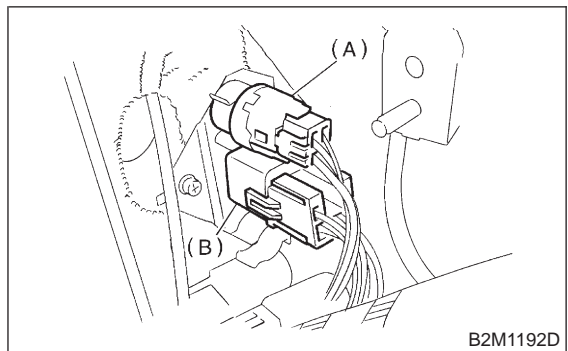

- (A) Fuel pump relay
- (B) Main relay

- 9) Disconnect connector from fuel pump relay.

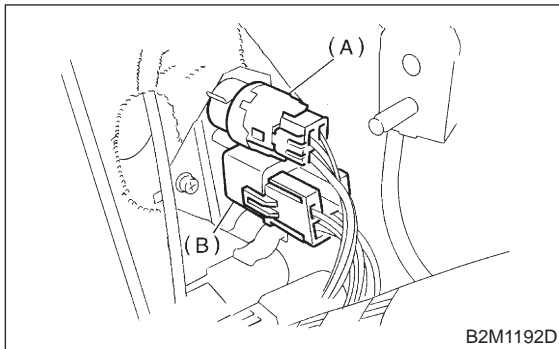

- (A) Fuel pump relay
(B) Main relay

- 10) Installation is in the reverse order of removal.

18. Air Intake Chamber

A: REMOVAL AND INSTALLATION

- 1) Loosen clamps which connect air intake chamber to throttle body and air intake duct.

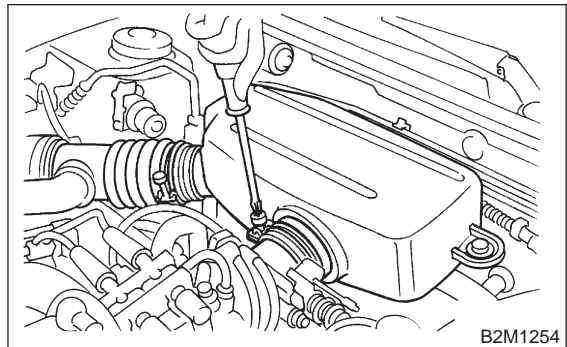

- 2) Disconnect air hoses from air intake chamber.
3) Remove bolts which secure air intake chamber to stays.
4) Remove air intake chamber.
5) Installation is in the reverse order of removal.

Tightening torque:

$4.9 \pm 0.5 \text{ N}\cdot\text{m}$ ($0.5 \pm 0.05 \text{ kg}\cdot\text{m}$, $3.6 \pm 0.4 \text{ ft}\cdot\text{lb}$)