

2. Power Steering System

A: LHD MODEL

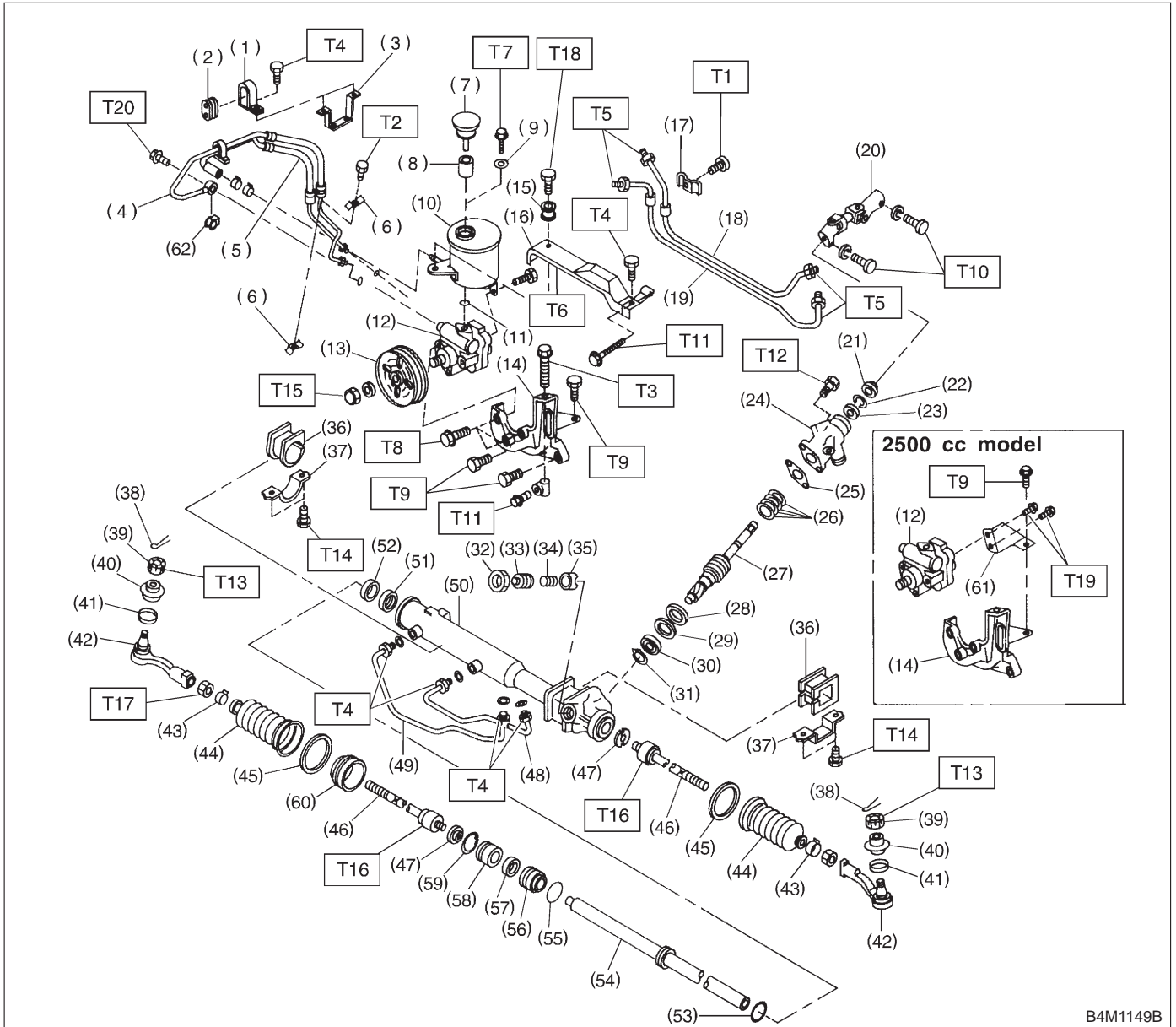

B4M1149B

- |                  |                            |                      |
|------------------|----------------------------|----------------------|
| (1) Clamp        | (16) Belt cover            | (31) Snap ring       |
| (2) Adapter      | (17) Clamp plate           | (32) Lock nut        |
| (3) Hose bracket | (18) Pipe F                | (33) Adjusting screw |
| (4) Pipe C       | (19) Pipe E                | (34) Spring          |
| (5) Pipe D       | (20) Universal joint       | (35) Sleeve          |
| (6) Clamp E      | (21) Dust seal             | (36) Adapter         |
| (7) Cap          | (22) C-ring                | (37) Clamp           |
| (8) Strainer     | (23) Oil seal              | (38) Cotter pin      |
| (9) Seal washer  | (24) Valve housing         | (39) Castle nut      |
| (10) Tank        | (25) Packing               | (40) Dust seal       |
| (11) O-ring      | (26) Seal ring             | (41) Clip            |
| (12) Oil pump    | (27) Pinion and valve ASSY | (42) Tie-rod end     |
| (13) Pulley      | (28) Oil seal              | (43) Small clip      |
| (14) Bracket     | (29) Back-up washer        | (44) Boot            |
| (15) Bush        | (30) Ball bearing          | (45) Large clip      |

## 4-3 [C2A0]

### 2. Power Steering System

---

## COMPONENT PARTS

- (46) Tie-rod
- (47) Lock washer
- (48) Pipe B
- (49) Pipe A
- (50) Housing ASSY
- (51) Back-up washer
- (52) Oil seal
- (53) Piston ring
- (54) Rack
- (55) O-ring
- (56) Rack bushing
- (57) Oil seal
- (58) Rack stopper
- (59) Circlip
- (60) Spacer
- (61) Stay (2500 cc model only)
- (62) Gasket

---

**Tightening torque: N-m (kg-m, ft-lb)**

- T1: 5.4±1.5 (0.55±0.15, 4.0±1.1)**
  - T2: 7.4±2.0 (0.75±0.20, 5.4±1.4)**
  - T3: 8±2 (0.8±0.2, 5.8±1.4)**
  - T4: 13±3 (1.3±0.3, 9.4±2.2)**
  - T5: 15±5 (1.5±0.5, 10.8±3.6)**
  - T6: 15.7±2.4 (1.60±0.24, 11.58±1.77)**
  - T7: 18.1±2.5 (1.85±0.25, 13.35±1.84)**
  - T8: 20.1±2.5 (2.05±0.25, 14.8±1.8)**
  - T9: 22±2 (2.2±0.2, 15.9±1.4)**
  - T10: 24±3 (2.4±0.3, 17.4±2.2)**
  - T11: 24.5±2.0 (2.50±0.2, 18.07±1.48)**
  - T12: 25±5 (2.5±0.5, 18.1±3.6)**
  - T13: 27.0±2.5 (2.75±0.25, 19.92±1.84)**
  - T14: 59±12 (6.0±1.2, 43±9)**
  - T15: 60.8±6.9 (6.2±0.7, 44.8±5.1)**
  - T16: 78±10 (8.0±1.0, 58±7)**
  - T17: 83±5 (8.5±0.5, 61.5±3.6)**
  - T18: 6.35±1.0 (0.65±0.1, 4.7±0.7)**
  - T19: 15.7±2.5 (1.6±0.25, 11.6±1.8)**
  - T20: 34±5 (3.5±0.5, 25.3±3.6)**
-

## B: RHD MODEL

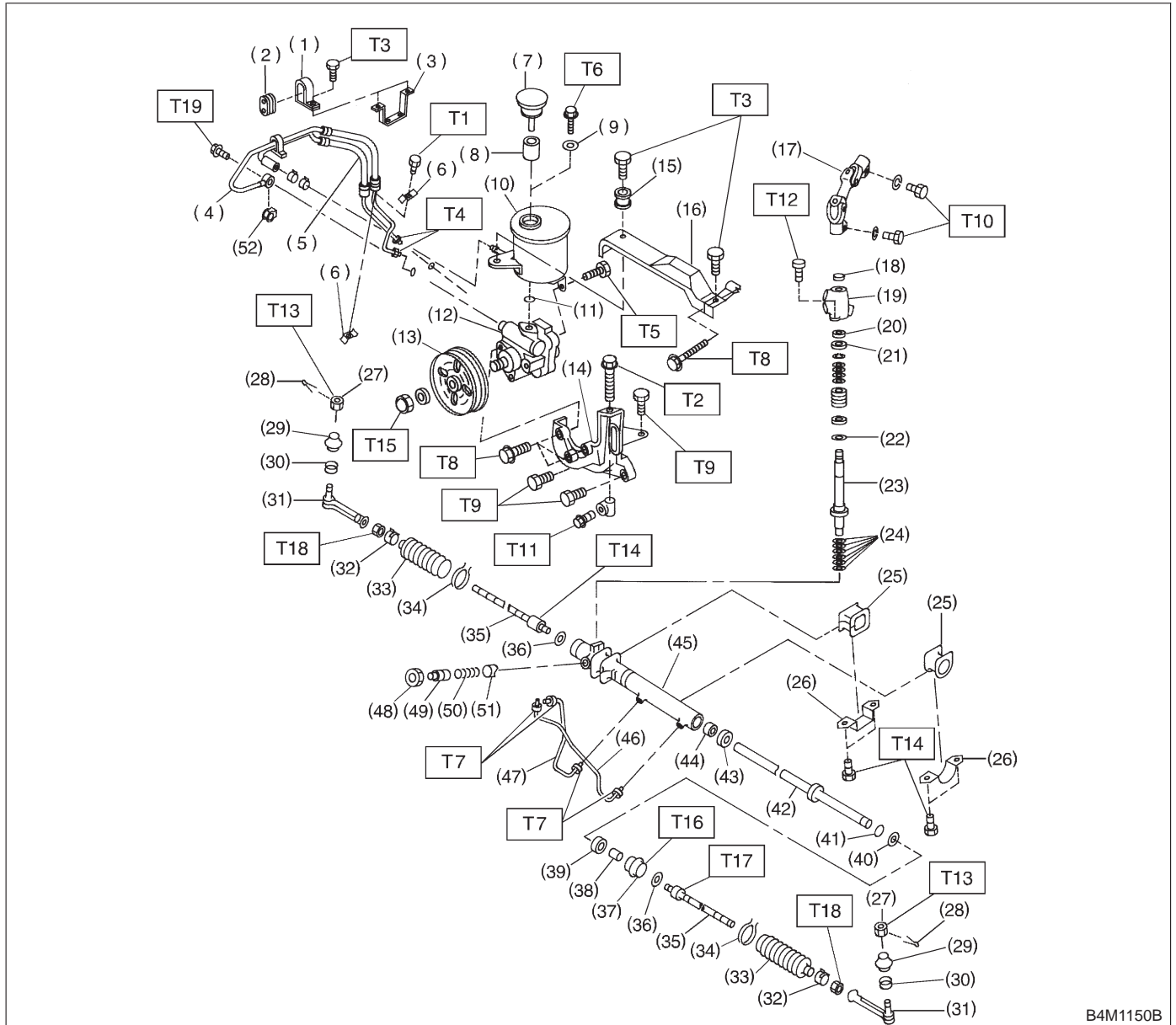

B4M1150B

- |                      |                    |                      |
|----------------------|--------------------|----------------------|
| (1) Clamp            | (18) Dust cover    | (35) Tie-rod         |
| (2) Adapter          | (19) Valve housing | (36) Lock washer     |
| (3) Hose bracket     | (20) Y-packing     | (37) Holder          |
| (4) Pipe C           | (21) Ball bearing  | (38) Bush            |
| (5) Pipe D           | (22) Spacer        | (39) Y-packing       |
| (6) Clamp E          | (23) Pinion        | (40) Oil seal        |
| (7) Cap              | (24) Shim          | (41) O-ring          |
| (8) Strainer         | (25) Adapter       | (42) Rack            |
| (9) Seal washer      | (26) Clamp         | (43) Oil seal        |
| (10) Tank            | (27) Castle nut    | (44) Back-up washer  |
| (11) O-ring          | (28) Cotter pin    | (45) Housing ASSY    |
| (12) Oil pump        | (29) Dust seal     | (46) Pipe A          |
| (13) Pulley          | (30) Clip          | (47) Pipe B          |
| (14) Bracket         | (31) Tie-rod end   | (48) Lock nut        |
| (15) Bush            |                    | (49) Adjusting screw |
| (16) Belt cover      |                    | (50) Spring          |
| (17) Universal joint |                    | (51) Sleeve          |

## 4-3 [C2B0]

### 2. Power Steering System

---

## COMPONENT PARTS

(52) Gasket

---

**Tightening torque: N-m (kg-m, ft-lb)**

**T1: 7.4±2.0 (0.75±0.2, 5.4±1.4)**

**T2: 8±2 (0.8±0.2, 5.8±1.4)**

**T3: 13±3 (1.3±0.3, 9.4±2.2)**

**T4: 15±5 (1.5±0.5, 10.8±3.6)**

**T5: 15.7±2.4 (1.60±0.24,  
11.58±1.77)**

**T6: 18.1±2.5 (1.85±0.26,  
13.35±1.84)**

**T7: 20±4 (2.0±0.4, 14±2.9)**

**T8: 20.1±2.5 (2.05±0.25, 14.8±1.8)**

**T9: 22±2 (2.2±0.2, 15.9±1.4)**

**T10: 24±3 (2.4±0.3, 17.4±2.2)**

**T11: 24.5±2.0 (2.50±0.20,  
18.07±1.48)**

**T12: 25±5 (2.5±0.5, 18.1±3.6)**

**T13: 27.0±2.5 (2.75±0.26,  
19.92±1.84)**

**T14: 59±12 (6.0±1.2, 43±9)**

**T15: 61±7 (6.2±0.7, 44.8±5.1)**

**T16: 64±10 (6.5±1.0, 47±7)**

**T17: 78±10 (8.0±1.0, 58±7)**

**T18: 83±5 (8.5±0.5, 61.5±3.6)**

**T19: 34±5 (3.5±0.5, 25.3±3.6)**

---