

1. Manual Transmission

A: AWD MODEL

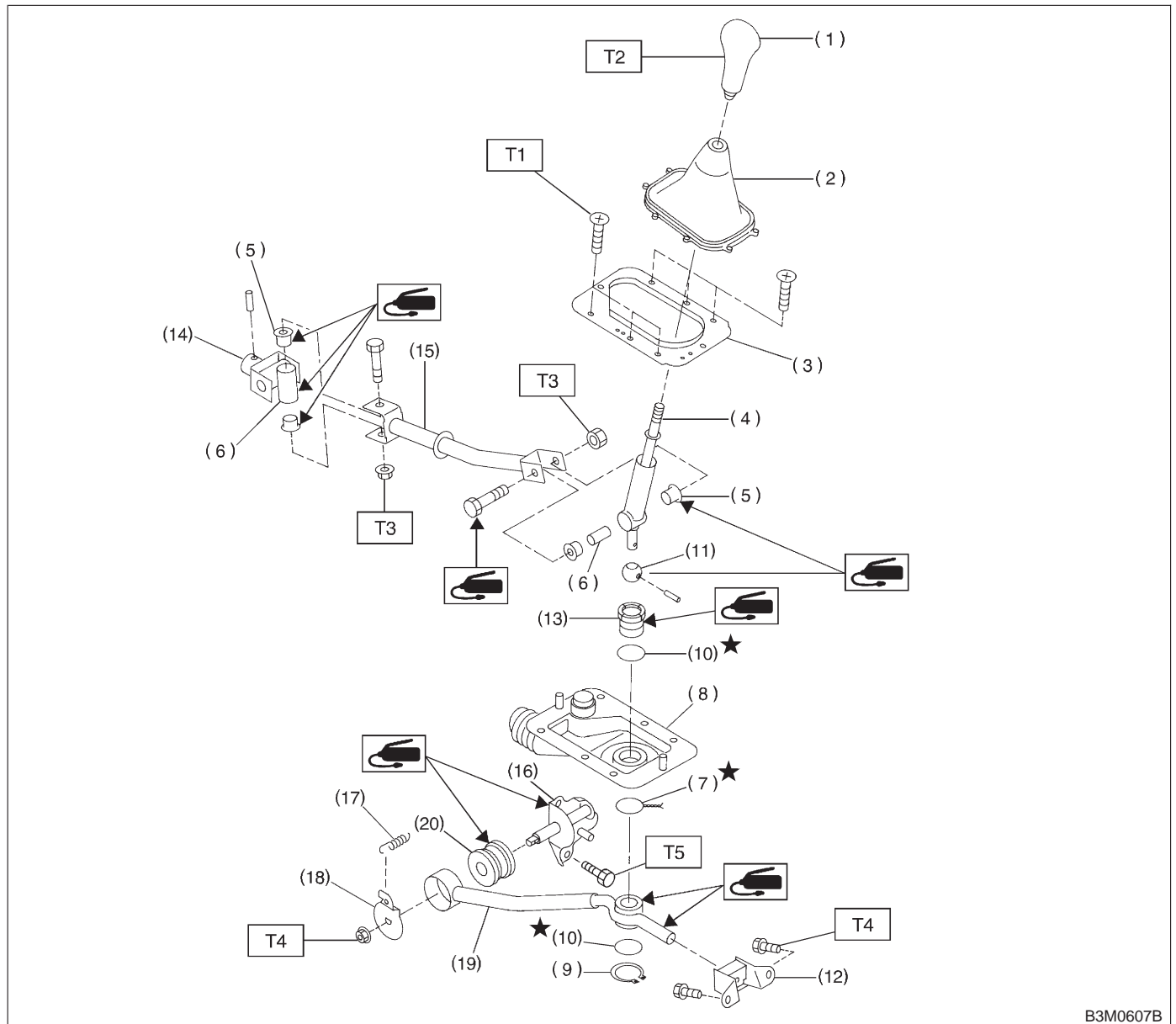

B3M0607B

- | | |
|----------------------|-------------------------|
| (1) Gear shift knob | (11) Bush (Shift lever) |
| (2) Console boot | (12) Cushion rubber |
| (3) Boot plate | (13) Bush (Stay rear) |
| (4) Gear shift lever | (14) Joint |
| (5) Bush | (15) Rod |
| (6) Spacer | (16) Bracket |
| (7) Locking wire | (17) Spring |
| (8) Boot | (18) Washer |
| (9) Snap ring | (19) Stay |
| (10) O-ring | (20) Bush (Stay front) |

Tightening torque: N·m (kg-m, ft-lb)

T1: 4.4±1.5 (0.45±0.15, 3.3±1.1)

T2: 5 (0.51, 3.7)

T3: 12±3 (1.2±0.3, 8.7±2.2)

T4: 18±5 (1.8±0.5, 13.0±3.6)

T5: 24.5±2 (2.50±0.20, 18.07±1.48)

B: FWD MODEL

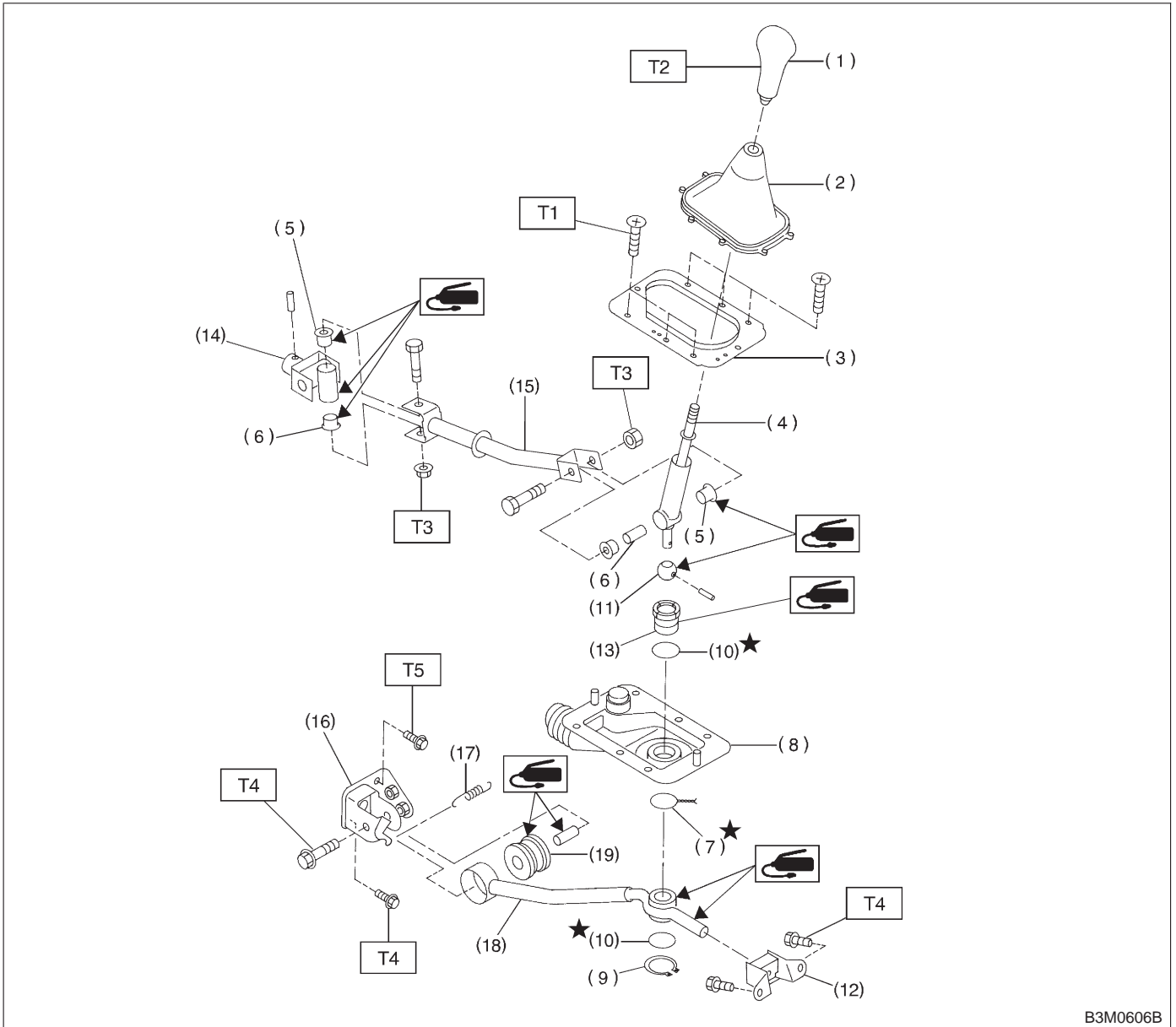

B3M0606B

- (1) Gear shift knob
- (2) Console boot
- (3) Boot plate
- (4) Gear shift lever
- (5) Bush
- (6) Spacer
- (7) Locking wire
- (8) Boot
- (9) Snap ring

- (10) O-ring
- (11) Bush (Shift lever)
- (12) Cushion rubber
- (13) Bush (Stay rear)
- (14) Joint
- (15) Rod
- (16) Bracket
- (17) Spring
- (18) Stay

- (19) Bush (Stay front)

Tightening torque: N-m (kg-m, ft-lb)

T1: 4.4±1.5 (0.45±0.15, 3.3±1.1)

T2: 5 (0.51, 3.7)

T3: 12±3 (1.2±0.3, 8.7±2.2)

T4: 18±5 (1.8±0.5, 13.0±3.6)

T5: 29±5 (3.0±0.5, 21.7±3.6)