

1. Front Hood and Hood Lock

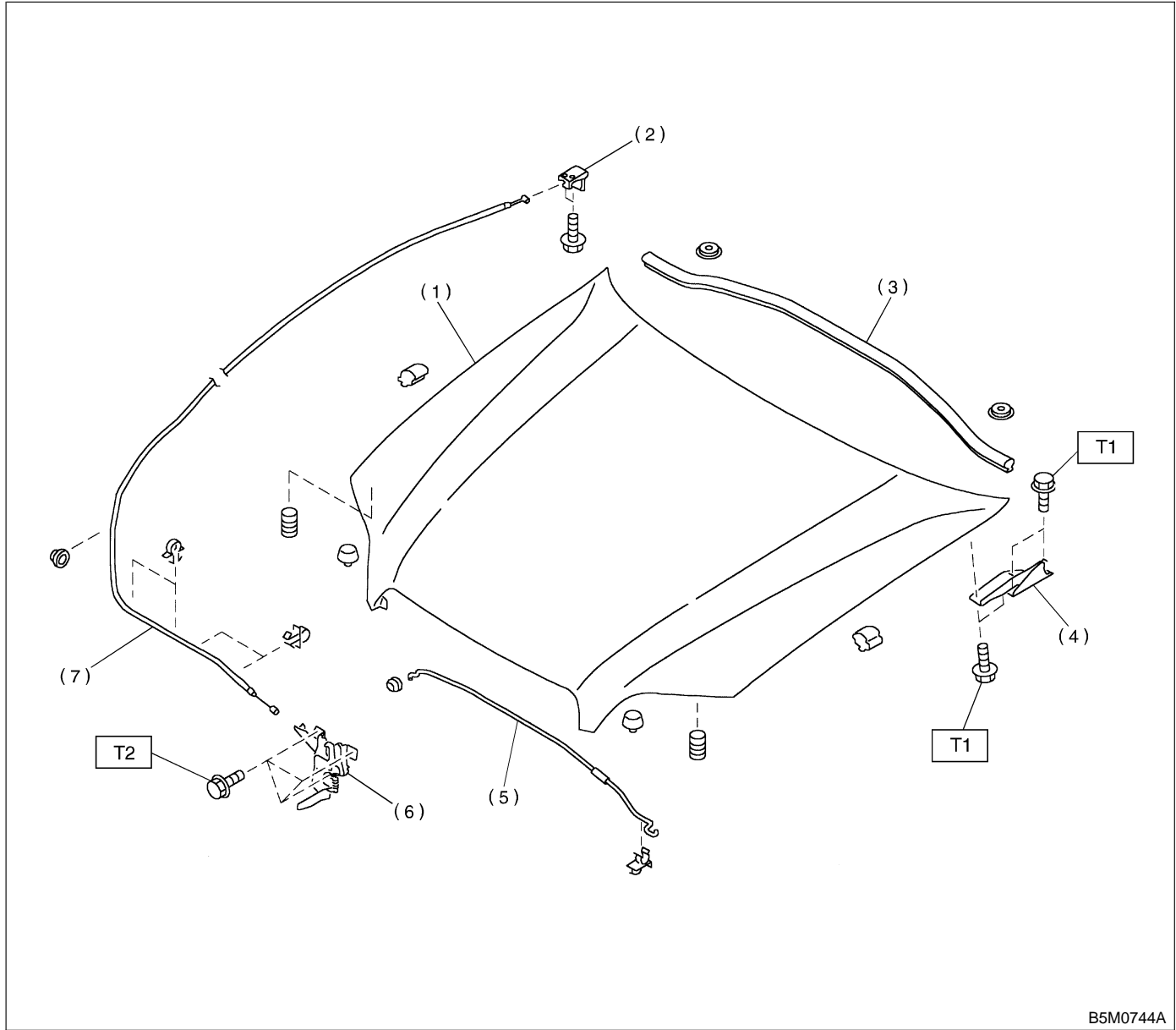

- (1) Front hood
- (2) Lever ASSY
- (3) Seal (Front hood)
- (4) Hinge
- (5) Front hood stay
- (6) Hood lock ASSY
- (7) Cable

Tightening torque: N·m (kg·m, ft·lb)
T1: 14±1 (1.4±0.1, 10.1±0.7)
T2: 32±1 (3.3±0.1, 23.9±0.7)