

1. Instrument Panel **AIRBAG**

A: REMOVAL

Airbag system wiring harness is routed near combination meter.

CAUTION:

- All Airbag system wiring harness and connectors are colored yellow and blue. Do not use electrical test equipment on these circuits.
- Be careful not to damage Airbag system wiring harness when servicing the instrument panel.

- 1) Disconnect GND cable from battery.
- 2) Remove shift knob (A) (MT model) and front cover (B).

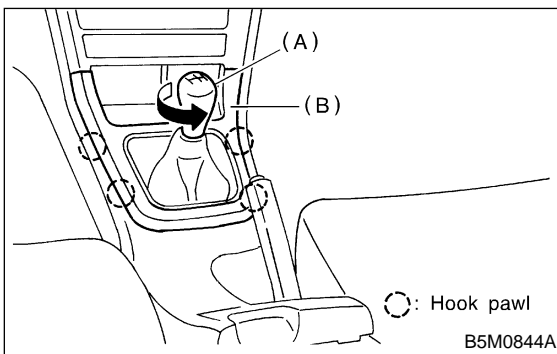

- 3) Remove lower cover and then disconnect connector.

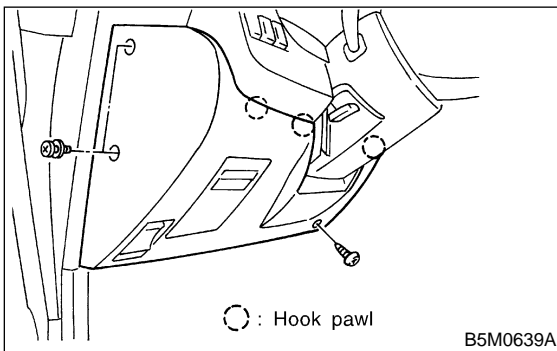

- 4) Remove knee pad.

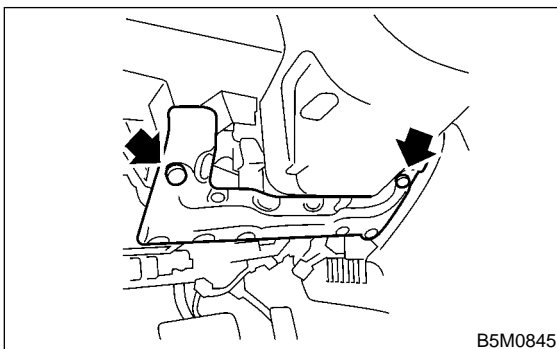

- 5) Remove stopper (A) and then remove glove box.

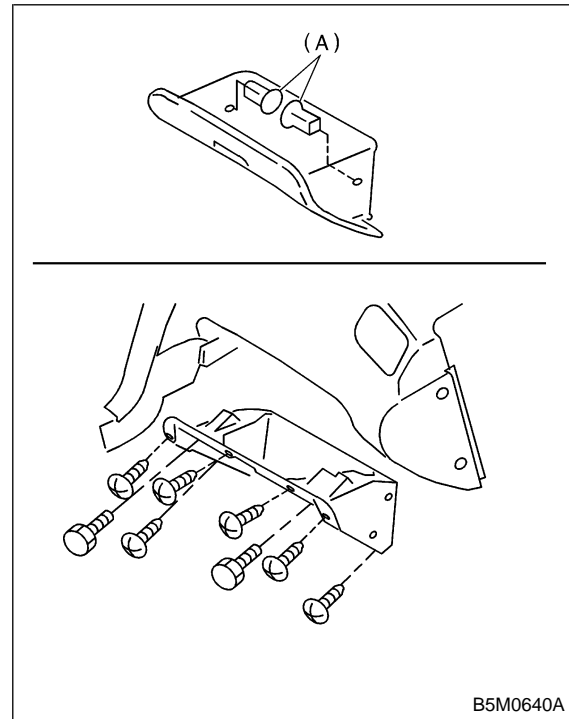

- 6) Remove center panel side of both sides.

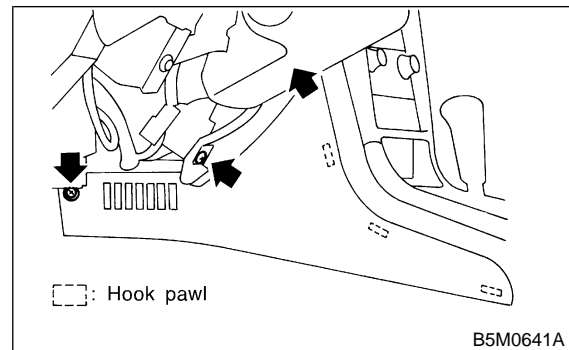

7) Remove tray (A) and console cover (B) while disconnecting connector.

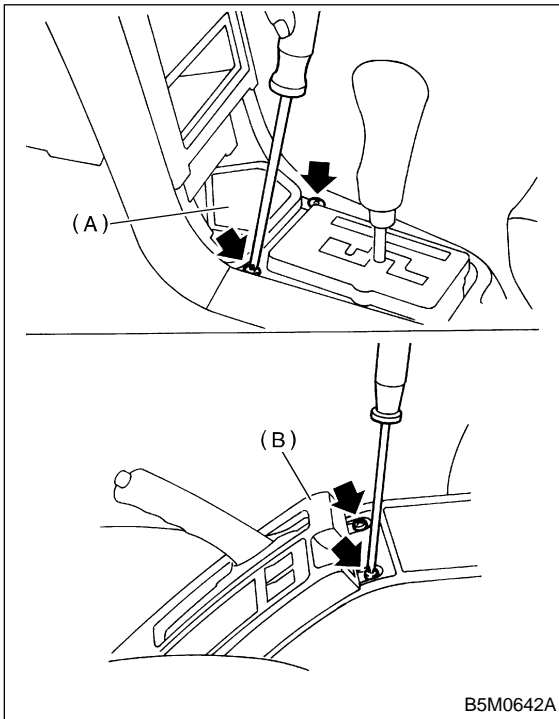

8) Remove console box (A).

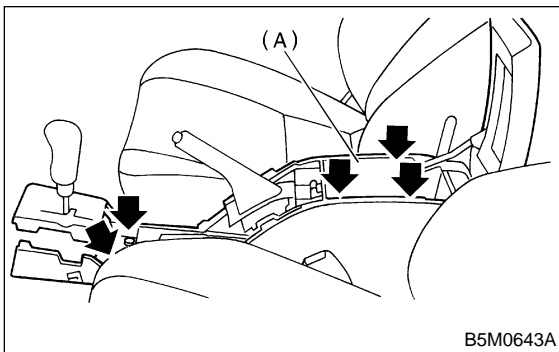

9) Remove front pillar upper trim of both sides.

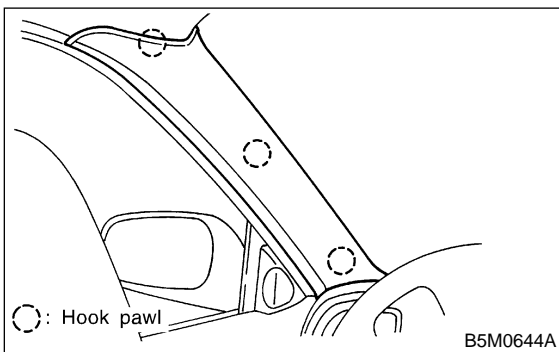

10) Remove front pillar lower trim (A) of passenger side.

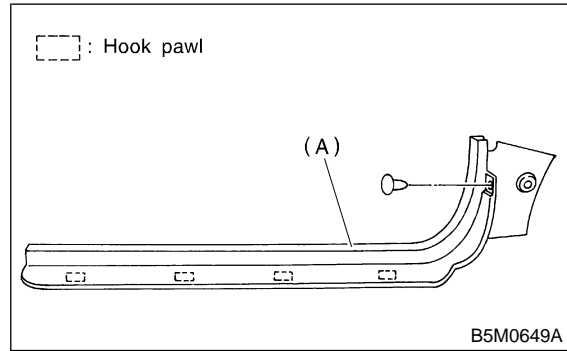

11) Remove passenger side airbag module. <Ref. to 5-5 [W3A2].>

12) Remove two bolts and lower steering column.

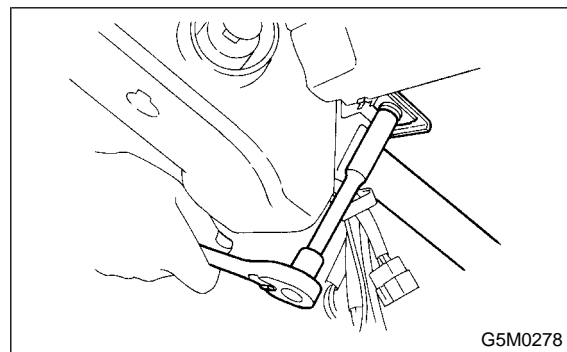

13) Set temperature control switch (A) to "FULL HOT" and then disconnect temperature control cable from bottom of heater unit.

NOTE:

Do not move switch and link when installing.

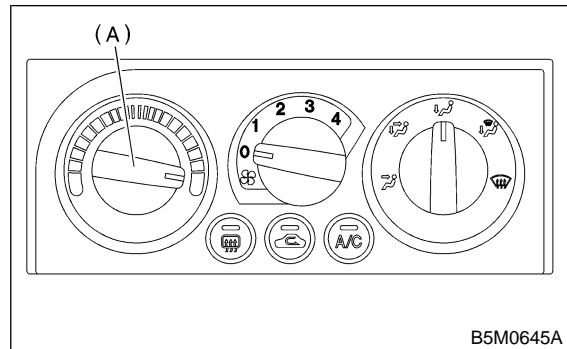

14) Remove the installing bolts and screw.

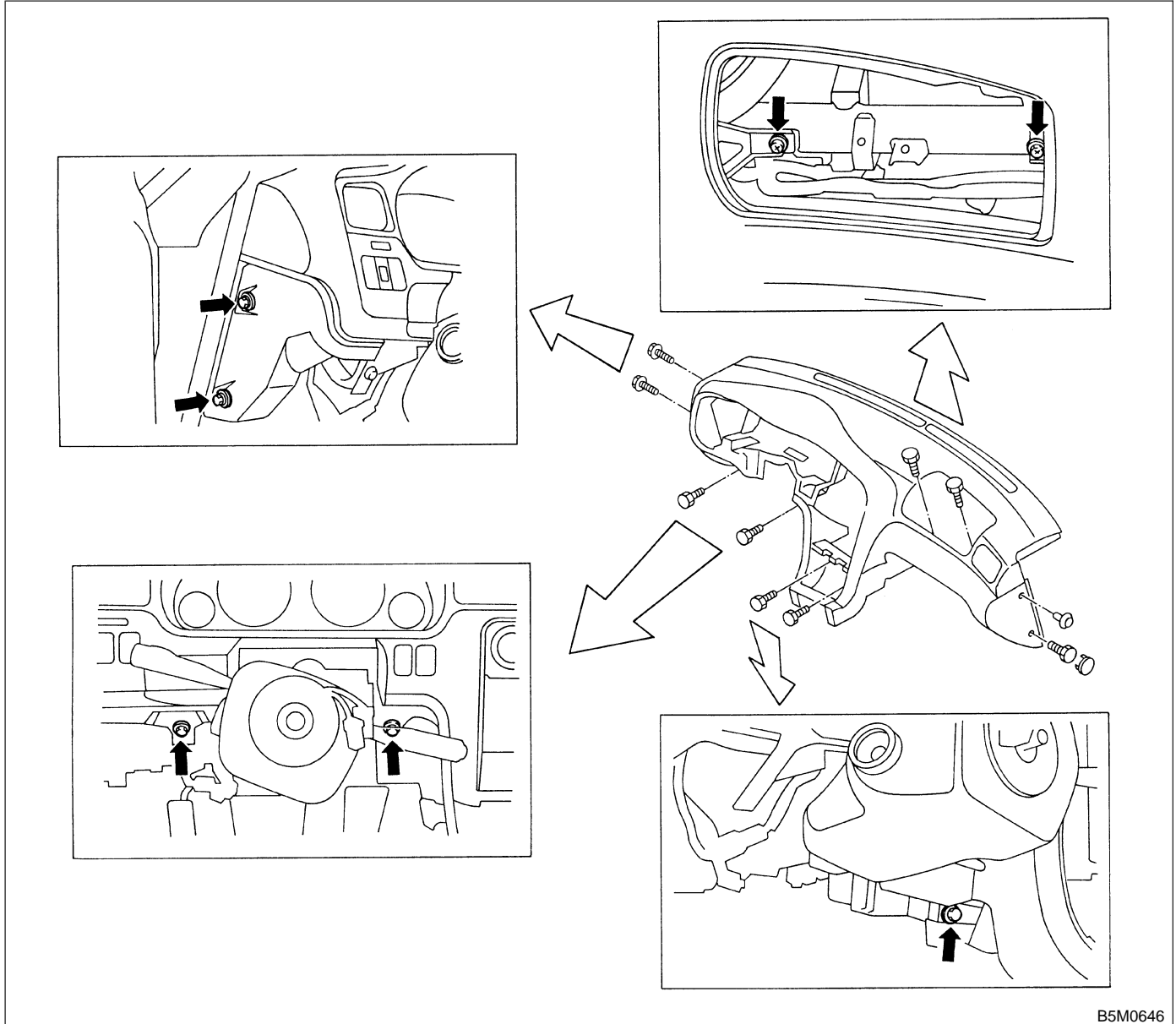

B5M0646

15) Remove instrument panel carefully from the body while disconnecting connectors.

CAUTION:

Be sure to hold socket section and not harness when disconnecting.

NOTE:

Put matching mark, if necessary, for easy reassembly.

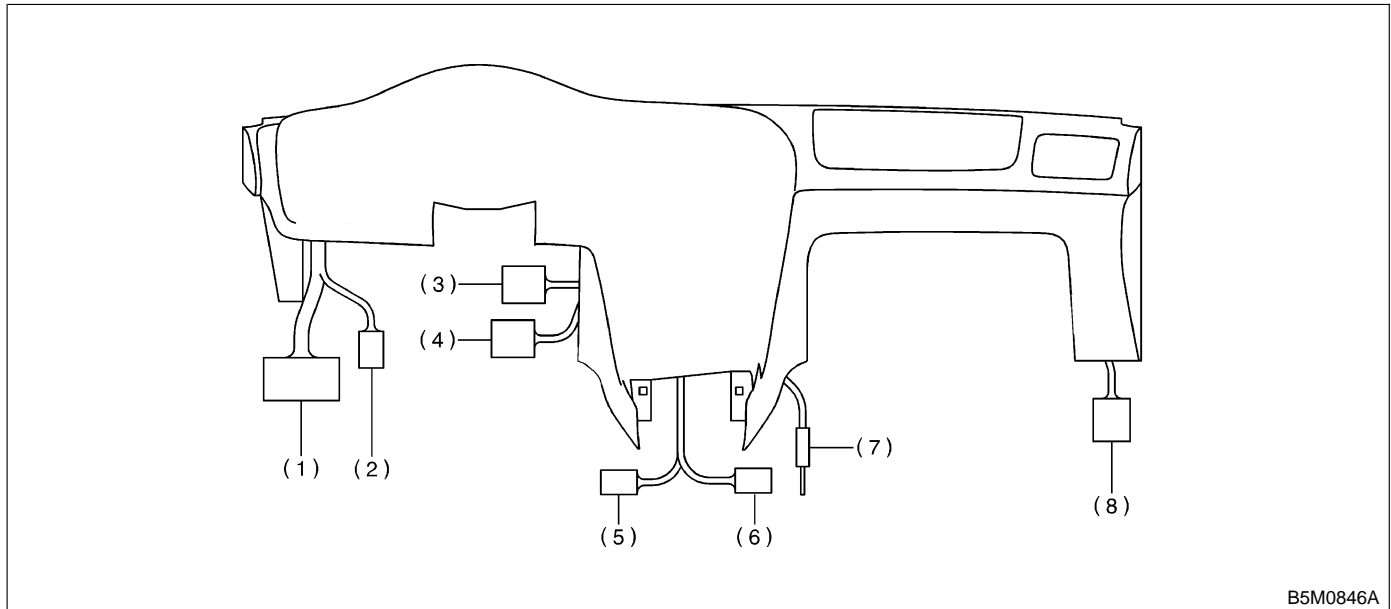

- (1) SMJ/White
- (2) 12P/Blue
- (3) 10P/White

- (4) 8P/White
- (5) 1P/Black
- (6) 1P/Black

- (7) Antenna feeder
- (8) 16P/Blue

CAUTION:

- Take care not to scratch the instrument panel and related parts.
- When storing removed instrument panel, place it standing up on the floor.

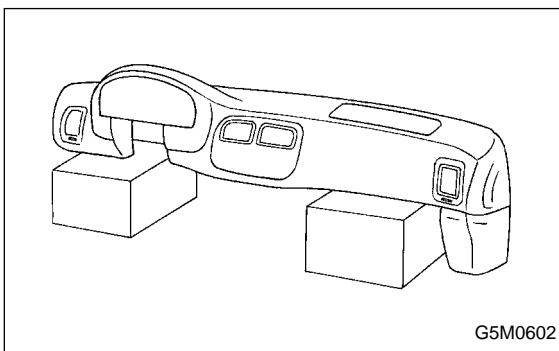

B: INSTALLATION

Installation is in the reverse order of removal.

CAUTION:

- Be careful not to snag the harness.
- Make sure to connect harness connectors.
- Take care not to scratch the instrument panel and related parts.

NOTE:

When setting instrument panel into position, push three hooks into grommet (A) on body panel.

