

1. Intake Manifold

A: MT VEHICLES

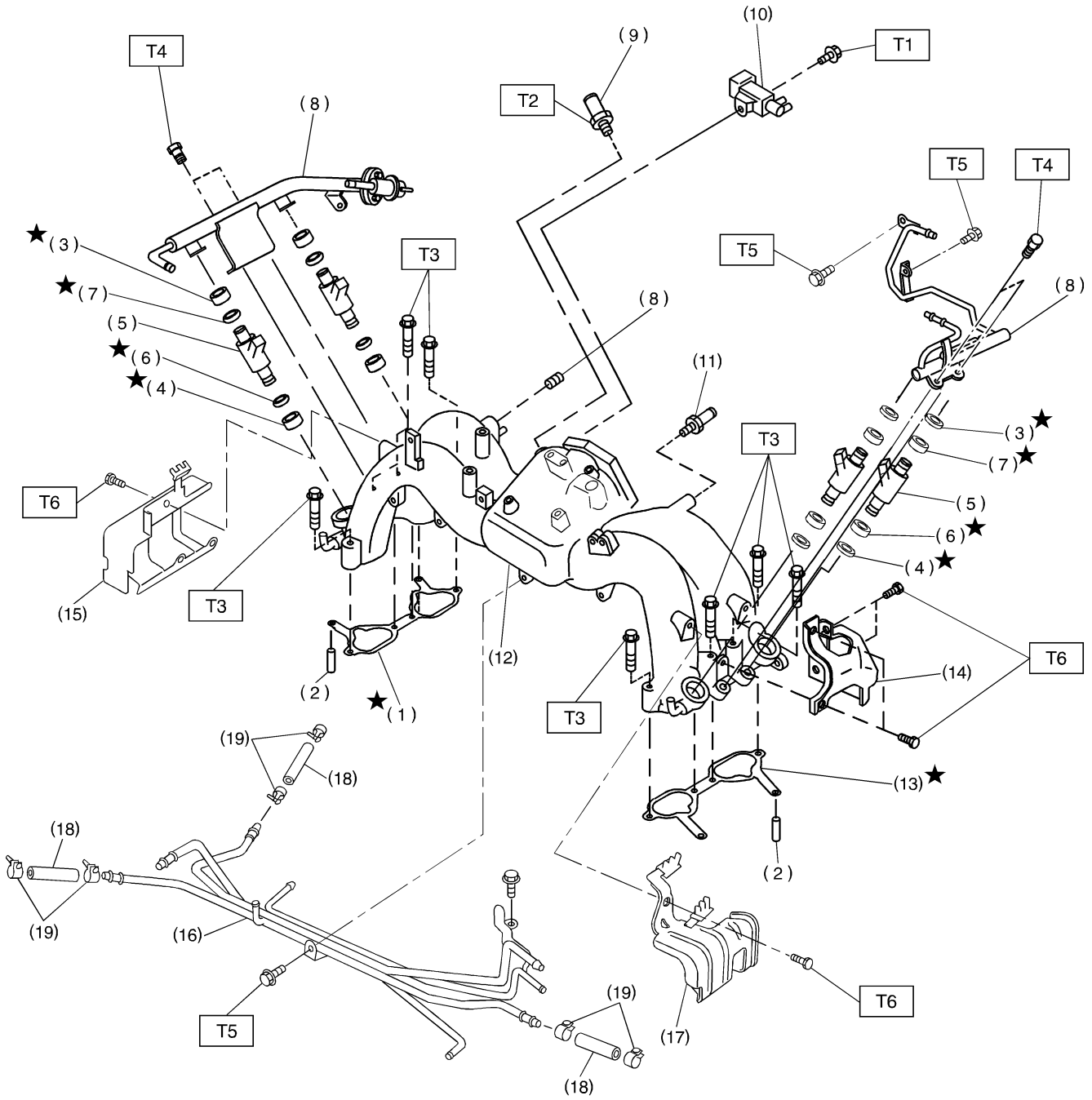

B2M3453A

- | | |
|-----------------------------------|--------------------------------|
| (1) Intake manifold gasket RH | (11) Nipple |
| (2) Guide pin | (12) Intake manifold |
| (3) Insulator A | (13) Intake manifold gasket LH |
| (4) Insulator B | (14) Fuel pipe protector LH |
| (5) Fuel injector | (15) Fuel pipe protector RH |
| (6) O-ring B | (16) Fuel pipe ASSY |
| (7) O-ring A | (17) Fuel pipe protector LH |
| (8) Plug | (18) Fuel hose |
| (9) PCV valve | (19) Clip |
| (10) Purge control solenoid valve | |

Tightening torque: N·m (kg·m, ft·lb)

T1: 16±1.5 (1.6±0.15, 11.6±1.1)

T2: 23±3 (2.3±0.3, 16.6±2.2)

T3: 25±2 (2.5±0.2, 18.1±1.4)

T4: 3.4±0.5 (0.35±0.05, 2.5±0.4)

T5: 4.9±0.5 (0.5±0.05, 3.6±0.4)

T6: 18.6±1.5 (1.9±0.15, 13.7±1.1)

B: AT VEHICLES

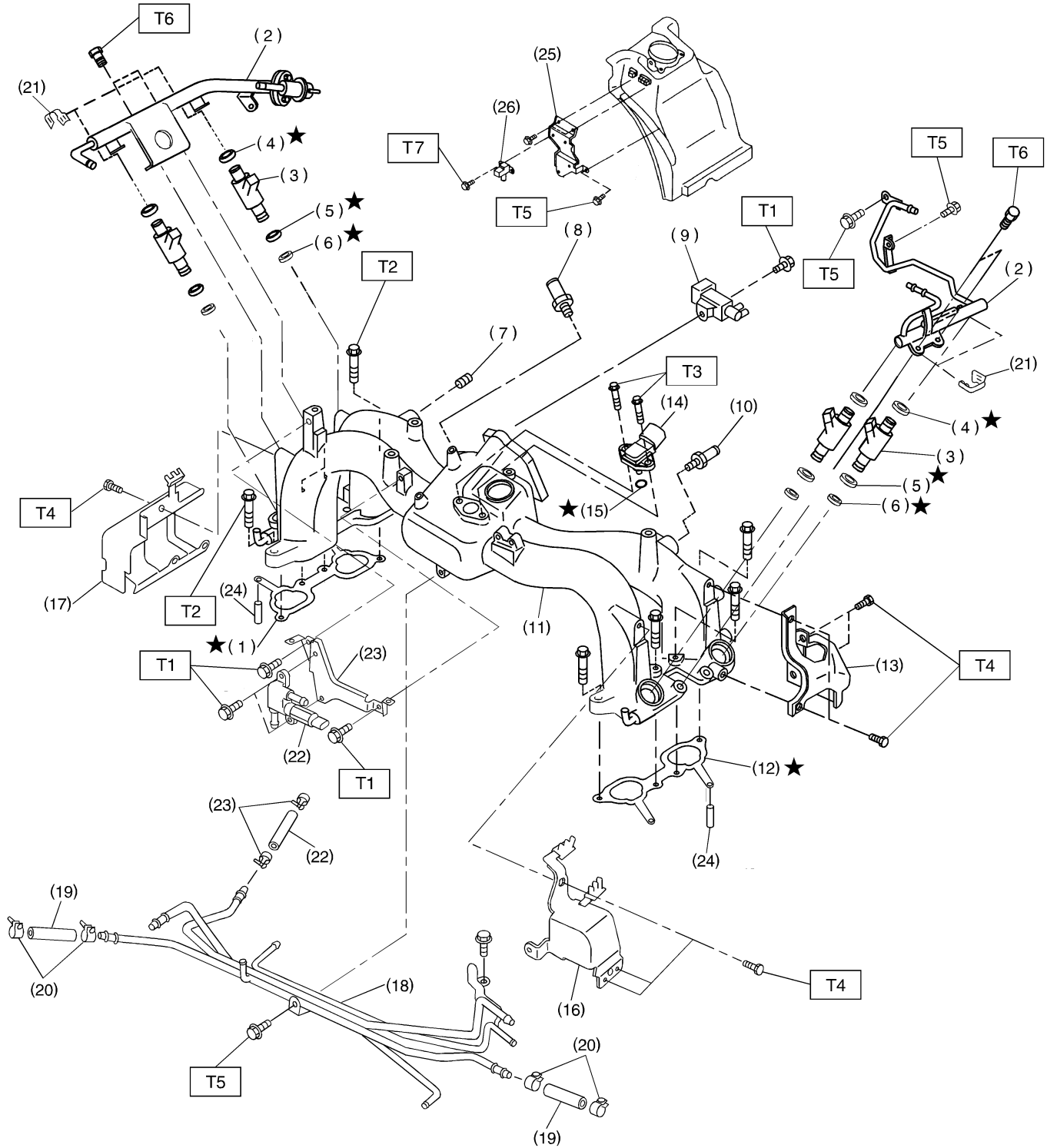

B2M3454A

(1) Intake manifold gasket RH	(14) Intake air temperature and pressure sensor	(25) Atmospheric pressure sensor bracket
(2) Fuel injector pipe	(15) O-ring	(26) Atmospheric pressure sensor
(3) Fuel injector	(16) Fuel pipe protector LH	
(4) O-ring	(17) Fuel pipe protector RH	
(5) O-ring	(18) Fuel pipe ASSY	
(6) O-ring	(19) Fuel hose	
(7) Plug	(20) Clip	
(8) PCV valve	(21) Clip	
(9) Purge control solenoid valve	(22) Air assist injector solenoid valve	
(10) Nipple	(23) Air assist injector solenoid valve bracket	
(11) Intake manifold	(24) Guide pin	
(12) Intake manifold gasket LH		
(13) Fuel pipe protector LH		

Tightening torque: N-m (kg-m, ft-lb)

T1: 16±1.5 (1.6±0.15, 11.6±1.1)

T2: 25±2 (2.5±0.2, 18.1±1.4)

T3: 2.0±0.4 (0.2±0.04, 1.4±0.3)

T4: 18.6±1.5 (1.9±0.15, 13.7±1.1)

T5: 4.9±0.5 (0.5±0.05, 3.6±0.4)

T6: 3.4±0.5 (0.35±0.05, 2.5±0.4)

T7: 6.4±0.5 (0.65±0.05, 4.7±0.4)
