

2. Power Steering System

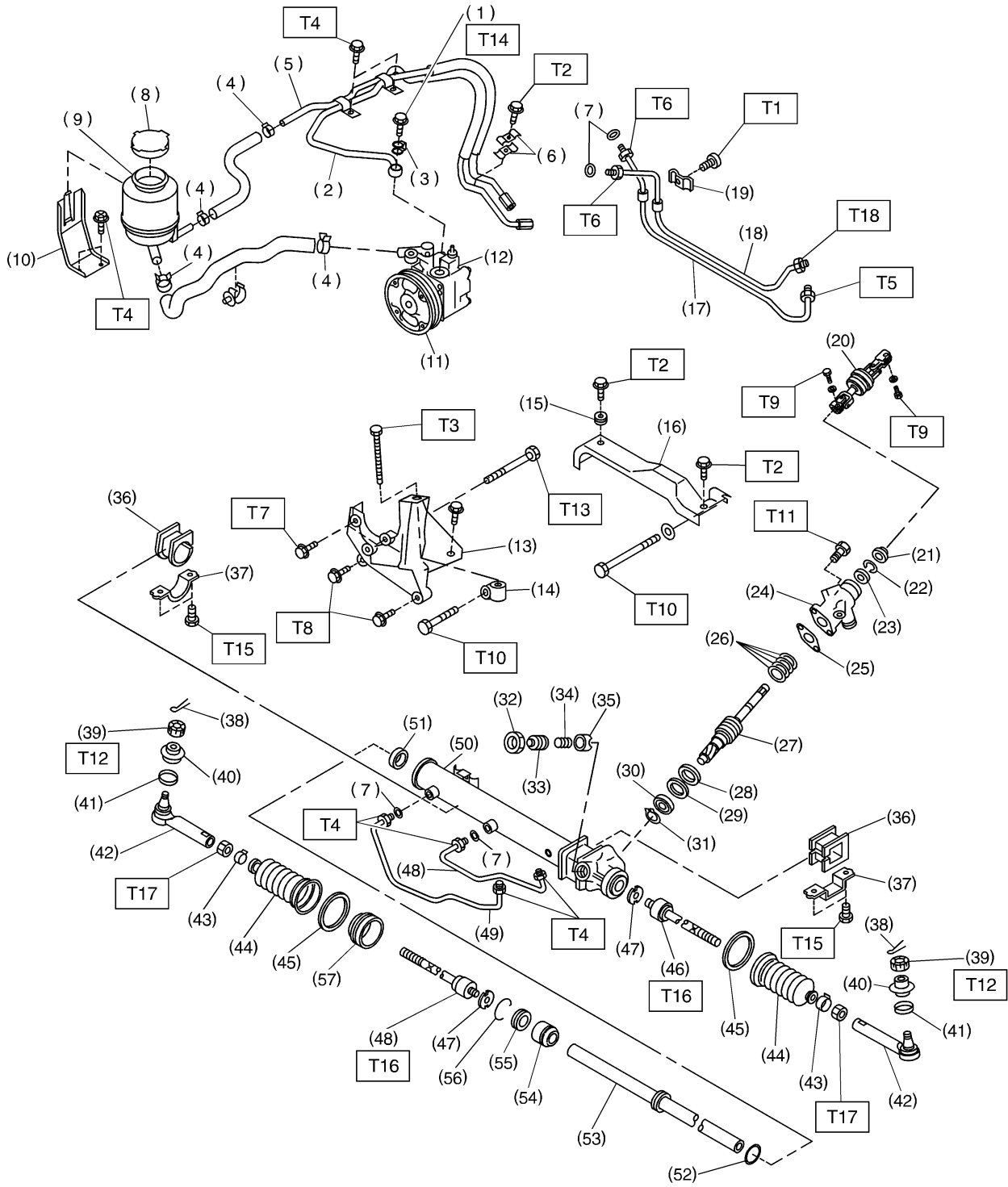

B4M2235A

(1) Eye bolt	(28) Oil seal	(55) Rack stopper
(2) Pipe C	(29) Back-up washer	(56) Circlip
(3) Gasket	(30) Ball bearing	(57) Spacer
(4) Clip	(31) Snap ring	
(5) Pipe D	(32) Lock nut	
(6) Clamp E	(33) Adjusting screw	<b>Tightening torque: N-m (kg-m, ft-lb)</b>
(7) O-ring	(34) Spring	<b>T1: 6±1 (0.6±0.1, 4.3±0.7)</b>
(8) Cap	(35) Sleeve	<b>T2: 7.4±2.0 (0.75±0.20, 5.4±1.4)</b>
(9) Reservoir tank	(36) Adapter	<b>T3: 8±2 (0.8±0.2, 5.8±1.4)</b>
(10) Reservoir tank bracket	(37) Clamp	<b>T4: 13±3 (1.3±0.3, 9.4±2.2)</b>
(11) Pulley	(38) Cotter pin	<b>T5: 15±3 (1.5±0.3, 10.8±2.2)</b>
(12) Oil pump	(39) Castle nut	<b>T6: 15±5 (1.5±0.5, 10.8±3.6)</b>
(13) Bracket	(40) Dust cover	<b>T7: 15.7±2.4 (1.6±0.24, 11.6±1.7)</b>
(14) Belt tension nut	(41) Clip	<b>T8: 22±2 (2.2±0.2, 15.9±1.4)</b>
(15) Bush	(42) Tie-rod end	<b>T9: 24±3 (2.4±0.3, 17.4±2.2)</b>
(16) Belt cover	(43) Clip	<b>T10: 25±2 (2.5±0.2, 18.1±1.4)</b>
(17) Pipe E	(44) Boot	<b>T11: 25±5 (2.5±0.5, 18.1±3.6)</b>
(18) Pipe F	(45) Band	<b>T12: 27±2 (2.75±0.2, 19.9±1.4)</b>
(19) Clamp plate	(46) Tie-rod	<b>T13: 37.3±5.9 (3.8±0.6, 27.5±4.3)</b>
(20) Universal joint	(47) Lock washer	<b>T14: 39±5 (4.0±0.5, 28.9±3.6)</b>
(21) Dust seal	(48) Pipe B	<b>T15: 59±12 (6.0±1.2, 43±9)</b>
(22) C-ring	(49) Pipe A	<b>T16: 78±10 (8.0±1.0, 58±7)</b>
(23) Oil seal	(50) Steering body	<b>T17: 83±5 (8.5±0.5, 61.5±3.6)</b>
(24) Valve housing	(51) Oil seal	<b>T18: 25±5 (2.5±0.5, 18.1±3.6)</b>
(25) Gasket	(52) Piston ring	
(26) Seal ring	(53) Rack	
(27) Pinion and valve ASSY	(54) Rack bushing	