

1. Gear Shift Lever

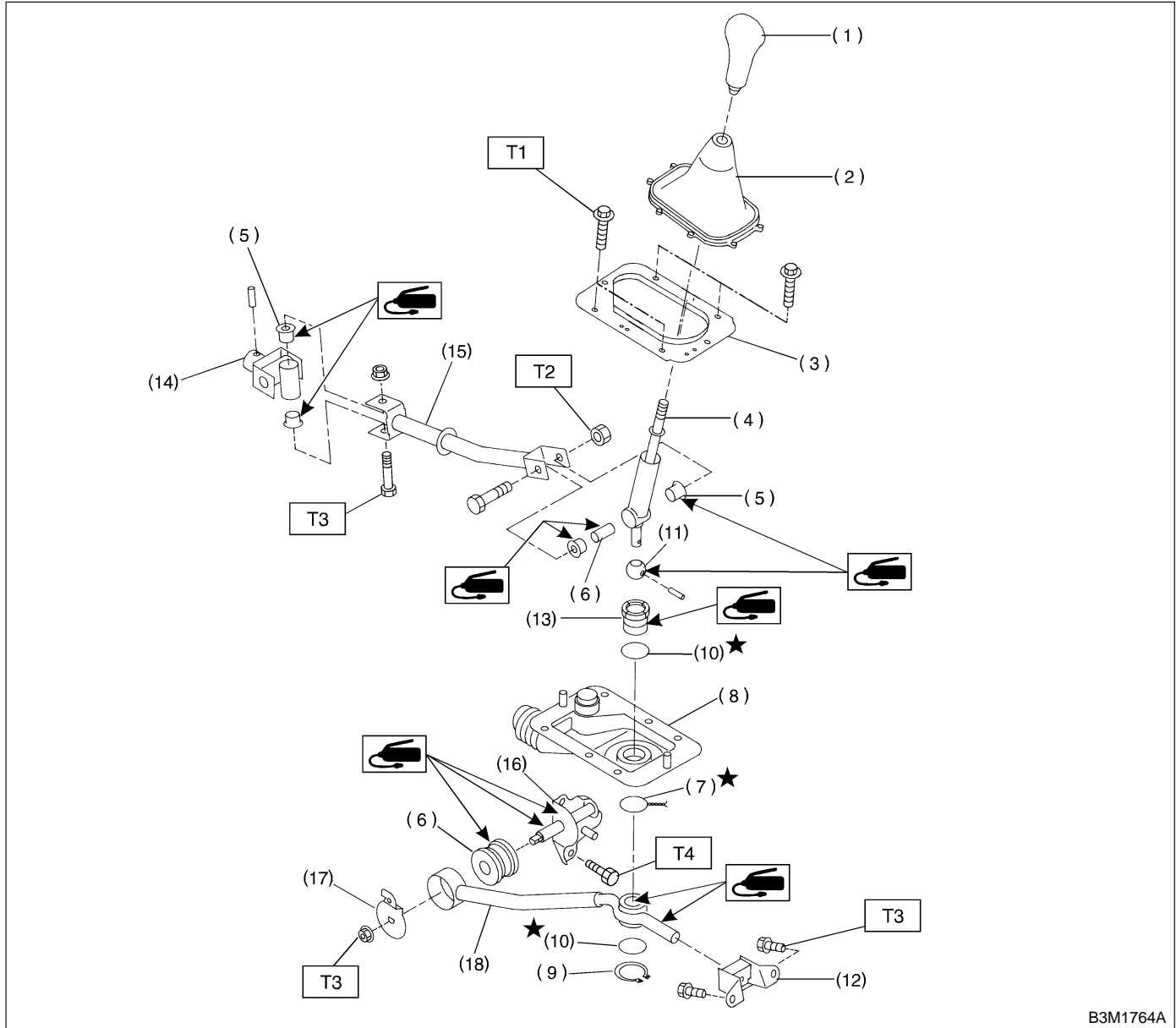

- | | |
|-----------------------|-------------------------|
| (1) Gear shift knob | (10) O-ring |
| (2) Console boot | (11) Bush (Shift lever) |
| (3) Boot plate | (12) Cushion rubber |
| (4) Lever | (13) Bush (Stay rear) |
| (5) Bush | (14) Joint |
| (6) Bush (Stay front) | (15) Rod |
| (7) Locking wire | (16) Bracket |
| (8) Boot | (17) Washer |
| (9) Snap ring | (18) Stay |

Tightening torque: N-m (kg-m, ft-lb)

T1: 7.5±2.0 (0.76±0.20, 5.5±1.4)

T2: 12±3 (1.2±0.3, 8.7±2.2)

T3: 18±5 (1.8±0.5, 13.0±3.6)

T4: 24.5±2 (2.50±0.20, 18.1±1.4)