

## 9. Rear Drum Brake Assembly

S405179

### A: REMOVAL S405179A18

- 1) Loosen wheel nuts, jack-up vehicle, support it with rigid racks, and remove wheel.
- 2) Release parking brake.
- 3) Remove brake drum from brake assembly.

#### NOTE:

- If it is difficult to remove brake drum, remove adjusting hole cover from drum, and then turn adjuster assembly pawls using a slot-type screwdriver until brake shoe separates from the drum.

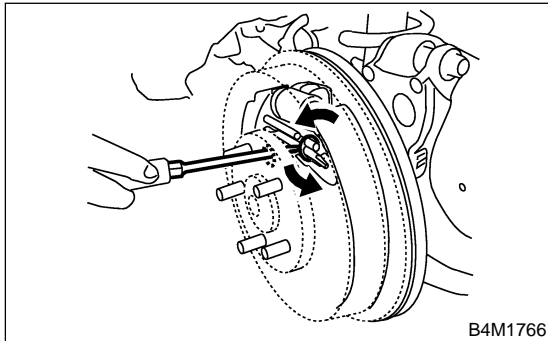

- If brake drum is difficult to remove, drive it out by installing an 8-mm bolt into bolt hole in brake drum.

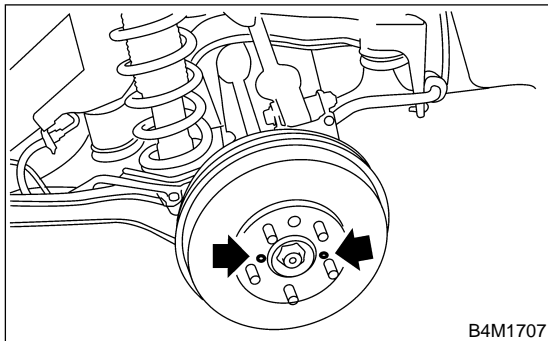

- 4) Hold hold-down pin by securing rear of back plate with your hand.

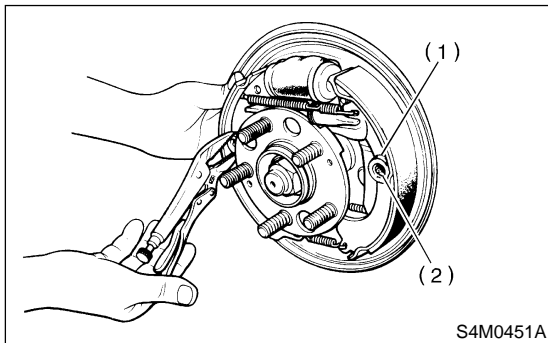

- (1) Hold-down cup
- (2) Hold-down pin

- 5) Disconnect hold-down cup from hold-down pin by rotating hold-down cup.
- 6) Disconnect lower shoe return spring from shoes.

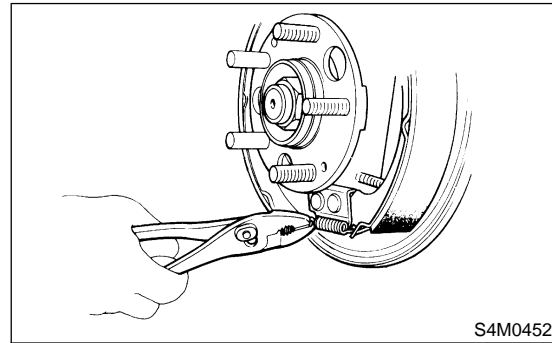

- 7) Remove shoes one by one from back plate with adjuster.

#### CAUTION:

- Be careful not to bend parking brake cable excessively when removing brake shoes.**

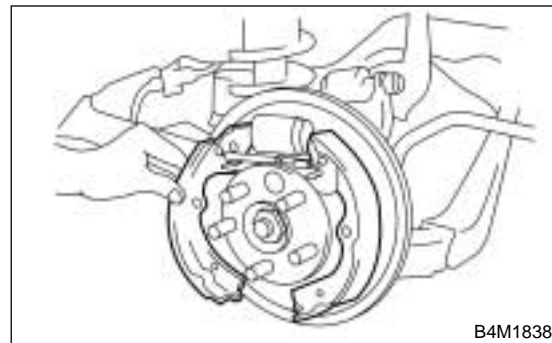

- 8) Disconnect parking brake cable from parking lever.

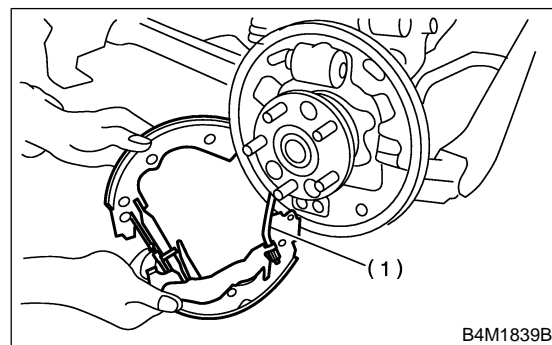

- (1) Parking brake cable

# REAR DRUM BRAKE ASSEMBLY

Brake

9) Unscrew the brake pipe flare nut and disconnect brake pipe.

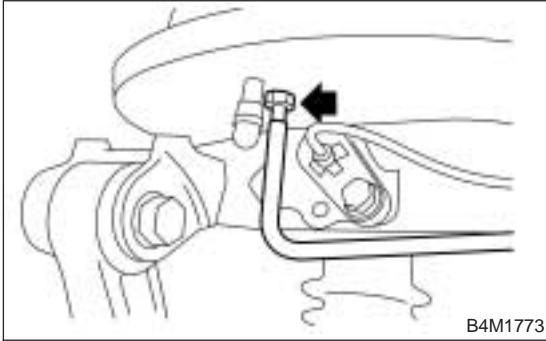

10) Remove hub.  
<Ref. to DS-22 REMOVAL, Hub Unit Bearing.>  
11) Remove brake assembly.  
12) Remove the bolts installing wheel cylinder on back plate, and remove it.

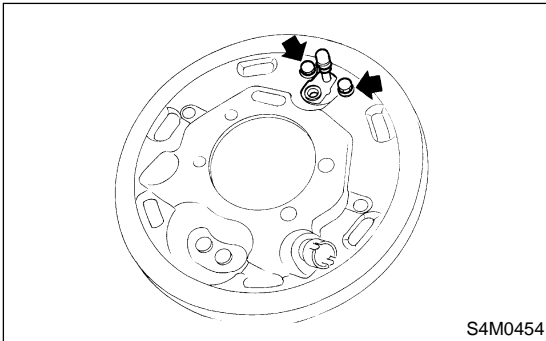

## B: INSTALLATION S405179A11

1) Install wheel cylinder on back plate, and tighten bolts.

**Tightening torque:**  
**10 N-m (1.0 kgf-m, 7.2 ft-lb)**

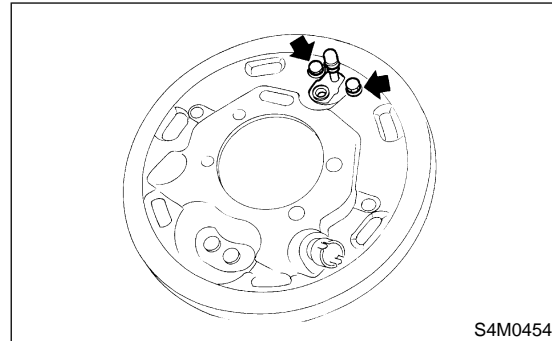

2) Clean back plate and wheel cylinder.  
3) Apply grease to portions indicated by arrows in Figure.

**Brake grease:**  
**Dow Corning Molykote No. 7439 (Part No. 725191460)**

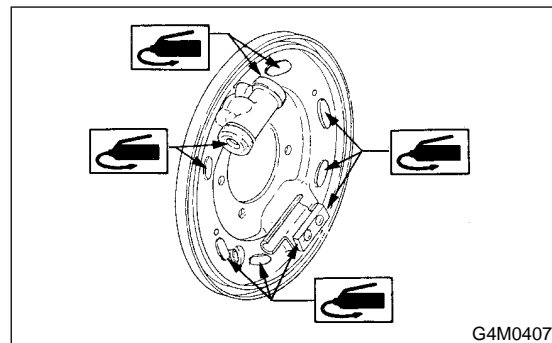

4) Apply grease to adjusting screw and both ends of adjuster.

**Brake grease:**  
**Dow Corning Molykote No. 7439 (Part No. 725191460)**

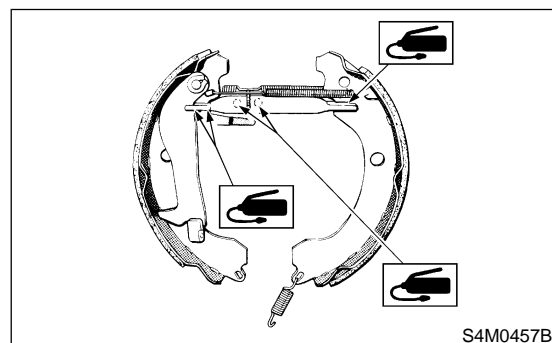

5) Connect upper shoe return spring to shoes.

# REAR DRUM BRAKE ASSEMBLY

Brake

- 6) Connect parking brake cable to parking lever.

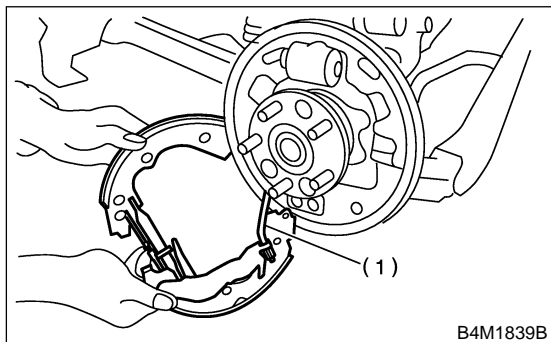

(1) Parking brake cable

- 7) While positioning shoes (one at a time) in groove on wheel cylinder, secure shoes.

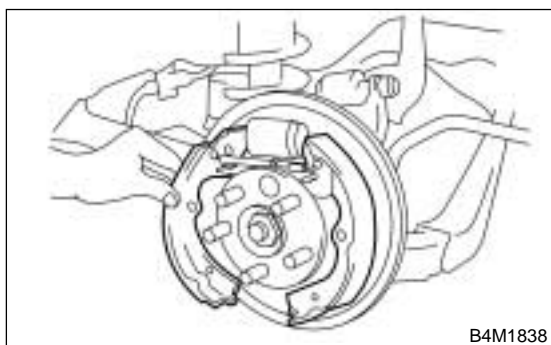

- 8) Fix shoes by connecting hold-down cup to hold-down pin.  
9) Connect lower shoe return spring.  
10) Set the outside diameter of brake shoes less than 0.5 to 0.8 mm (0.020 to 0.031 in) in comparison with the inside diameter of brake drum.  
11) Match the holes on hub and drum and install drum on hub.

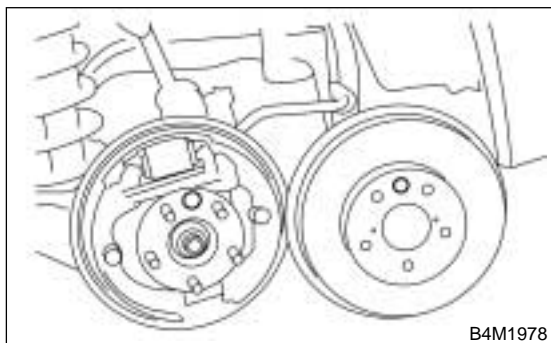

- 12) Install hub.  
<Ref. to DS-23 INSTALLATION, Hub Unit Bearing.>  
13) Connect brake pipe, and tighten brake pipe flange nut.

**Tightening torque:**

**15 N·m (1.5 kgf-m, 10.8 ft-lb)**

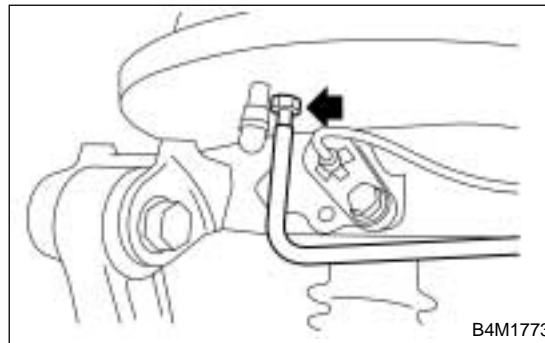

- 14) Install shoes.  
<Ref. to BR-31 INSTALLATION, Rear Drum Brake Shoe.>  
15) Install brake drum.  
16) After installing brake assembly, bleed air from brake line.

# REAR DRUM BRAKE ASSEMBLY

Brake

## C: DISASSEMBLY

S405179A06

1) Remove right and left dust boots from wheel cylinder.

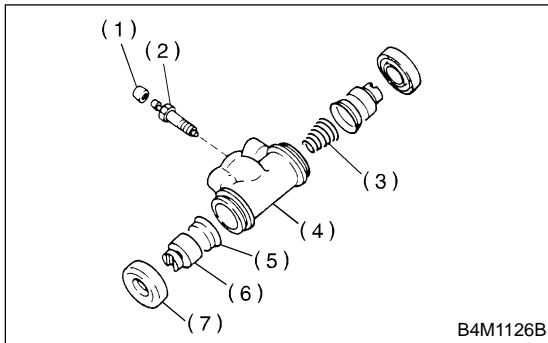

- (1) Bleeder cap
- (2) Bleeder screw
- (3) Spring
- (4) Cylinder
- (5) Cup
- (6) Piston
- (7) Boot

2) Remove piston, cup, spring and air bleeder screw and cap.

## D: ASSEMBLY

S405179A02

1) Clean all parts in brake fluid. Check and replace faulty parts.

- Cup and boot for damage or fatigue
- Cylinder, piston and spring or damage or rust formation

2) Assembly is the reverse order of disassembly.

(1) When installing the cup, use ST, apply brake fluid to the frictional surface for smooth installation and pay attention to cup direction.

(2) STs are available in different sizes.

### CAUTION:

- When replacing the repair kit, make sure that the sizes of cylinder and cup are the same as those which were replaced.
- Use only the tool of the correct size.

ST: ADAPTER	
Applicable size	Part No.
20.6 mm (13/16 in)	26699AE000

### CAUTION:

While assembling, be careful to prevent any metal chip, dust or dirt from entering the wheel cylinder.

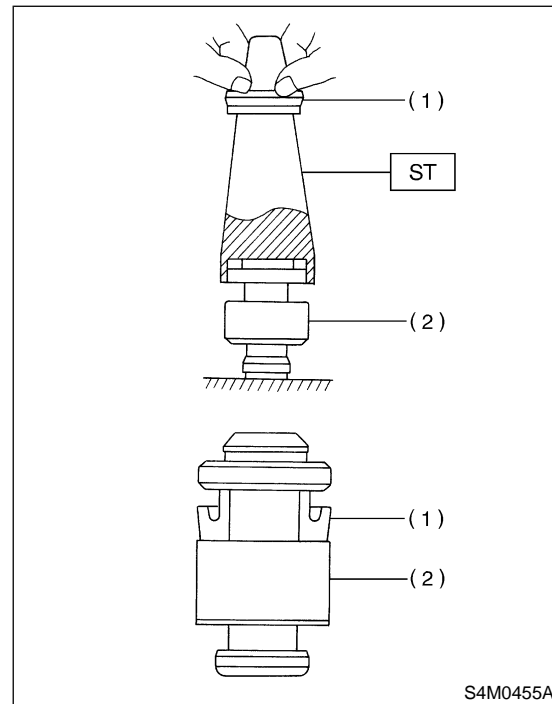

- (1) Cup
- (2) Piston

3) Apply rubber grease to the boot inside as shown in Figure.

**CAUTION:**  
Never use brake grease.

**Grease:**

**NIGLUBE RX-2 (Part No. 003606000)**

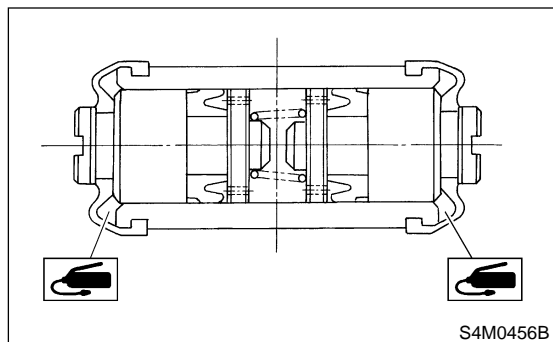

## E: INSPECTION S405179A10

- 1) If the inside surface of brake drum is streaked, correct the surface. And, if it is unevenly worn, taperingly streaked, or the outside surface of brake drum is damaged, correct or replace it.
- 2) Measure the drum inner diameter.

**Drum inner diameter: "L"**

**Standard 228.6 mm (9 in)**

**Service limit 230.6 mm (9.08 in)**

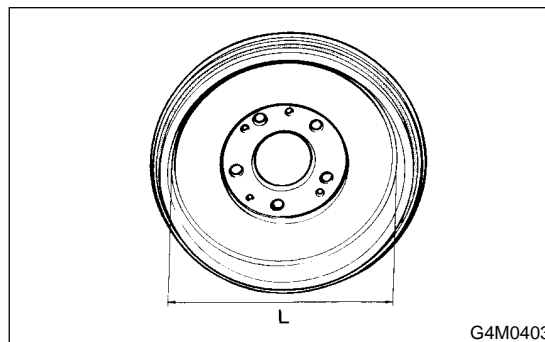

- 3) Measure the lining thickness.

**Lining thickness:**

**Standard 4.1 mm (0.161 in)**

**Service limit 1.5 mm (0.059 in)**

- 4) If the deformation or wear of back plate, shoe, etc. are notable, replace them.
- 5) When the shoe return spring tension is excessively weakened, replace it, taking care to identify upper and lower springs.