

# GENERAL DESCRIPTION

Parking Brake

## 1. General Description S404001

### A: SPECIFICATIONS S404001E49

Model	Rear drum brake	Rear disc brake	
		15 inch type	
Type	Mechanical on rear brakes, drum in disc		
Effective drum diameter	mm (in)	228.6 (9)	170 (6.69)
Lining dimensions (length × width × thickness)	mm (in)	218.8 × 35.0 × 4.1 (8.61 × 1.378 × 0.161)	162.6 × 30.0 × 3.2 (6.40 × 1.181 × 0.126)
Clearance adjustment	Automatic adjustment		Manual adjustment
Lever stroke	noches/N (kg, lb)	7 to 8/196 (20, 44)	

## B: COMPONENT S404001A05

### 1. PARKING BRAKE (REAR DISC BRAKE) S404001A0501

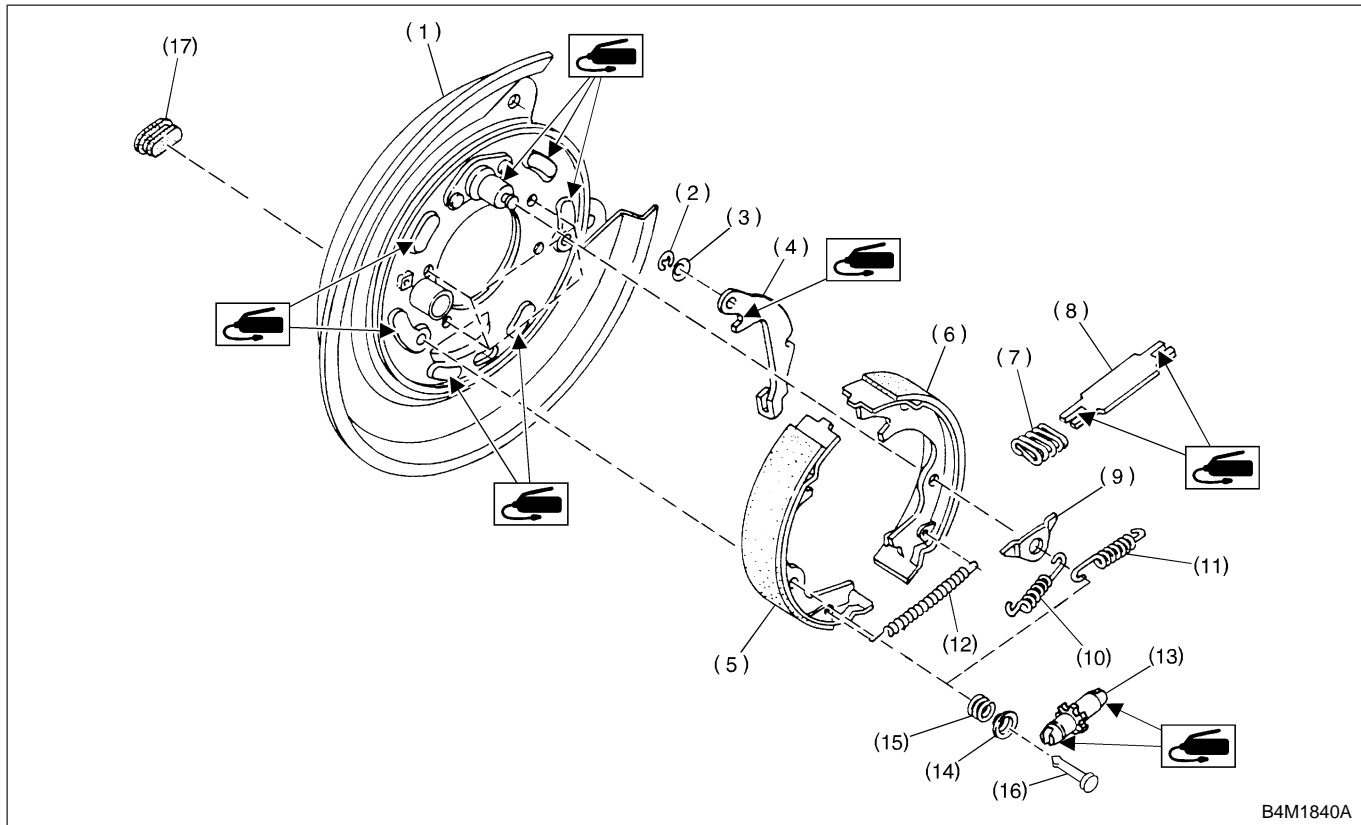

B4M1840A

- |                                    |                              |                            |
|------------------------------------|------------------------------|----------------------------|
| (1) Back plate                     | (7) Strut spring             | (13) Adjuster              |
| (2) Retainer                       | (8) Strut                    | (14) Shoe hold-down cup    |
| (3) Spring washer                  | (9) Shoe guide plate         | (15) Shoe hold down spring |
| (4) Lever                          | (10) Primary return spring   | (16) Shoe hold down pin    |
| (5) Parking brake shoe (Primary)   | (11) Secondary return spring | (17) Adjusting hole cover  |
| (6) Parking brake show (Secondary) | (12) Adjusting spring        |                            |

# GENERAL DESCRIPTION

## Parking Brake

### 2. PARKING BRAKE CABLE S404001A0502

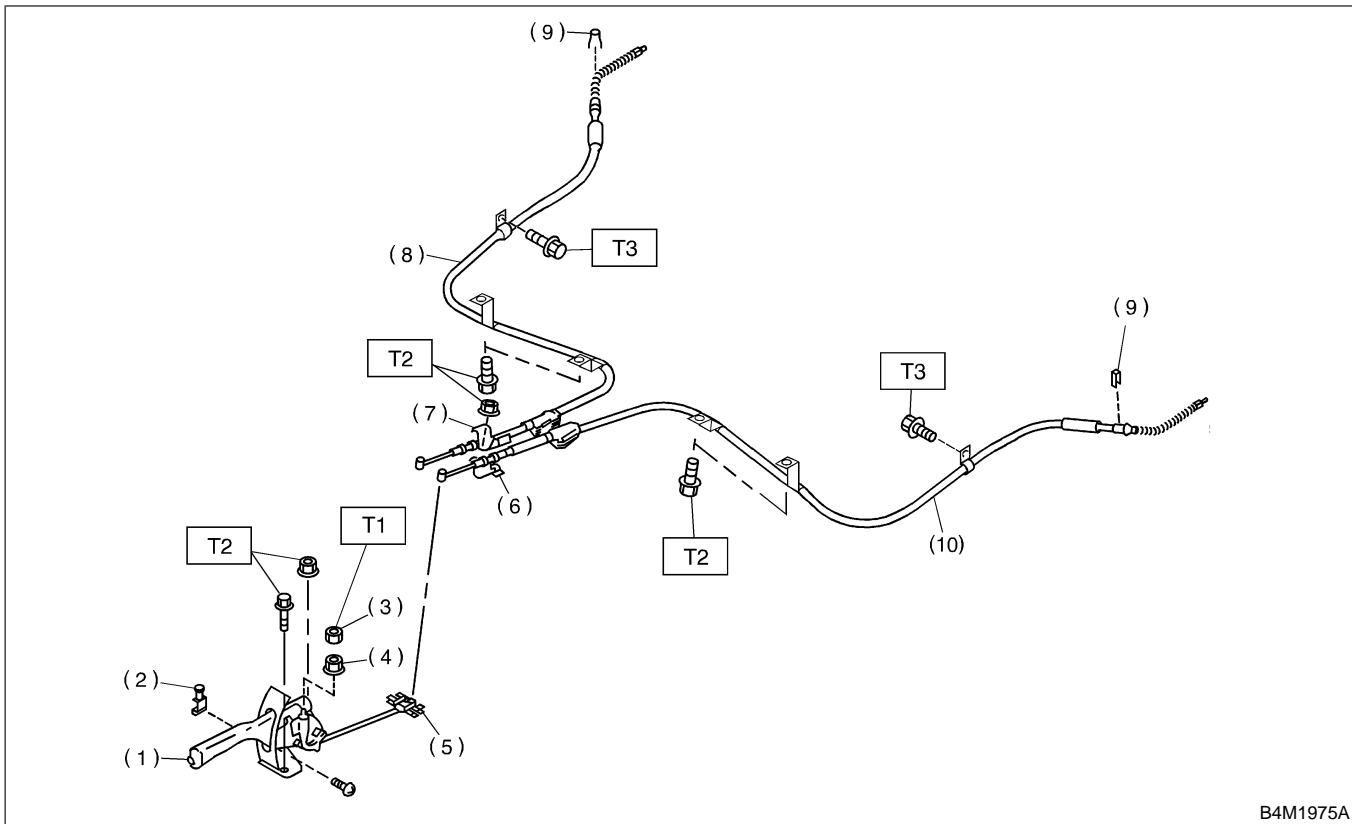

- |                          |                                        |
|--------------------------|----------------------------------------|
| (1) Parking brake lever  | (7) Clamp                              |
| (2) Parking brake switch | (8) Parking brake cable RH             |
| (3) Lock nut             | (9) Clamp (Rear disc brake model only) |
| (4) Adjusting nut        | (10) Parking brake cable LH            |
| (5) Equalizer            |                                        |
| (6) Bracket              |                                        |

**Tightening torque: N-m (kgf-m, ft-lb)**

**T1: 5.9 (0.60, 4.3)**

**T2: 18 (1.8, 13.0)**

**T3: 32 (3.3, 24)**

**C: CAUTION** S404001A03

- Wear working clothing, including a cap, protective goggles, and protective shoes during operation.
- Remove contamination including dirt and corrosion before removal, installation or disassembly.
- Keep the disassembled parts in order and protect them from dust or dirt.
- Before removal, installation or disassembly, be sure to clarify the failure. Avoid unnecessary removal, installation, disassembly, and replacement.
- Be careful not to burn your hands, because each part on the vehicle is hot after running.
- Use SUBARU genuine grease etc. or the equivalent. Do not mix grease etc. with that of another grade or from other manufacturers.
- Be sure to tighten fasteners including bolts and nuts to the specified torque.
- Place shop jacks or safety stands at the specified points.
- Apply grease onto sliding or revolution surfaces before installation.
- Before installing O-rings or snap rings, apply sufficient amount of grease to avoid damage and deformation.
- Before securing a part on a vice, place cushioning material such as wood blocks, aluminum plate, or shop cloth between the part and the vice.
- Keep grease etc. away from parking brake shoes.