

## 8. Side Airbag Harness S802309

### A: REMOVAL S802309A18

- 1) Turn ignition switch OFF.
- 2) Disconnect the ground cable from the battery, and wait for at least 20 seconds before starting work.
- 3) Remove front seat. <Ref. to SE-6 REMOVAL, Front Seat.>
- 4) Remove console box. <Ref. to EI-36 REMOVAL, Console Box.>
- 5) Roll up floor mat, and then disconnect two 12-pin yellow connectors from airbag control module.
- 6) Disconnect connector from side airbag sensor. <Ref. to AB-21 REMOVAL, Side Air Bag Sensor.>
- 7) Detach clips, and then remove side airbag harness.

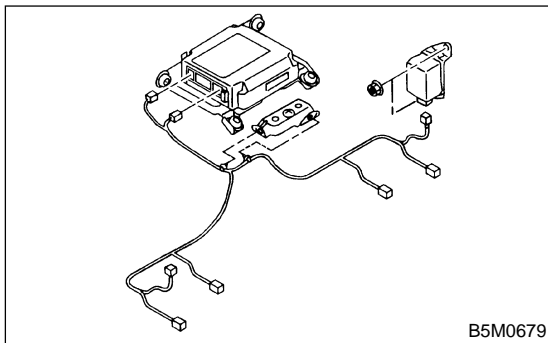

### B: INSTALLATION S802309A11

Install in the reverse order of removal.

### C: INSPECTION S802309A10

Check for the following, and replace damaged parts with new parts.

- Harness and/or connector is damaged.