

CLUTCH PIPE AND HOSE

Clutch System

7. Clutch Pipe and Hose S504262

A: REMOVAL S504262A18

- 1) Remove air chamber.
- 2) Drain clutch fluid. <Ref. to CL-19 Clutch Fluid.>
- 3) Remove clutch pipe.
- 4) Unclip and remove hose from bracket.

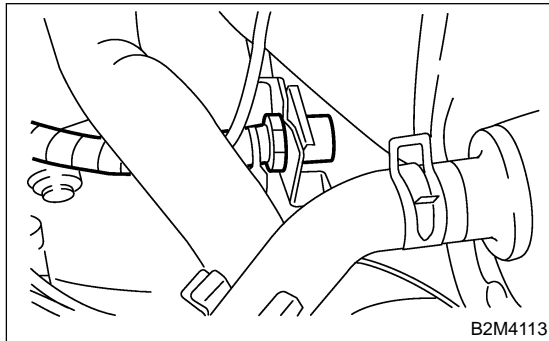

- 5) Remove hose from operating cylinder.

B: INSTALLATION S504262A11

Install in the reverse order of removal.

NOTE:

Bleed clutch fluid. <Ref. to CL-20 Clutch Fluid Air Bleeding.>

Tightening torque:

T1: 15 N·m (1.5 kgf-m, 10.8 ft-lb)

T2: 18 N·m (1.8 kgf-m, 13.0 ft-lb)

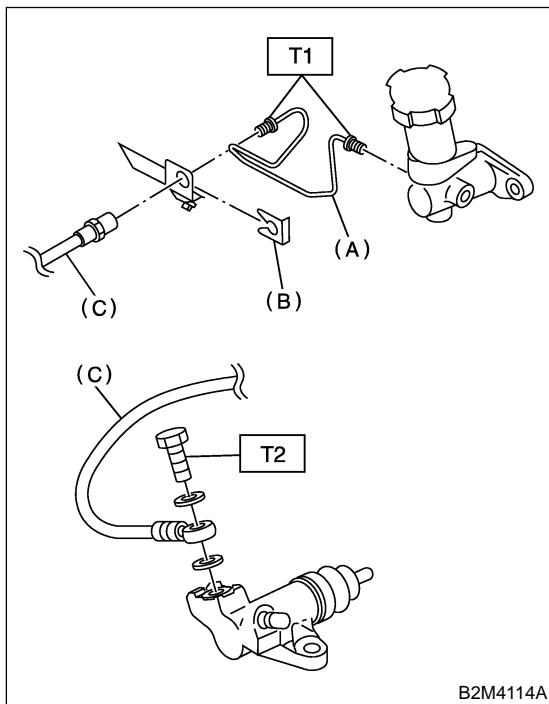

- (A) Clutch pipe
- (B) Clip
- (C) Clutch hose

C: INSPECTION S504262A10

Check pipes and hoses for cracks, breakage, or damage. Check joints for fluid leakage. If any cracks, breakage, damage, or leakage is found, repair or replace the applicable pipe or hose.