

UNIVERSAL JOINT

Power Assisted System (Power Steering)

3. Universal Joint S601273

A: REMOVAL S601273A18

- 1) Remove the steering wheel. <Ref. to PS-17, REMOVAL, Steering Wheel.>
- 2) Remove universal joint bolts and then remove universal joint.

CAUTION:

**Scribe alignment marks on universal joint so that it can be reassembled at the original ser-
ration.**

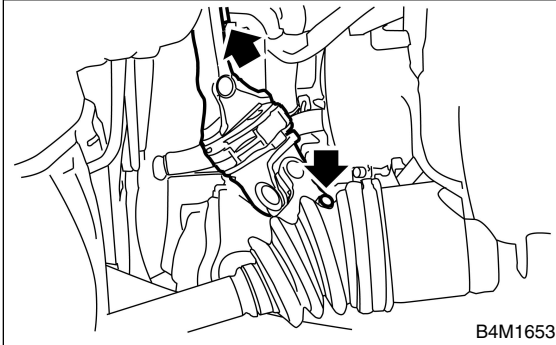

B: INSTALLATION S601273A11

- 1) Install universal joint.
 - (1) Align bolt hole on the long yoke side of uni-
versal joint with the cutout at the serrated sec-
tion of shaft end, and insert universal joint.
 - (2) Align bolt hole on the short yoke side of
universal joint with the cutout at the serrated
section of gearbox assembly. Lower universal
joint completely.
 - (3) Temporarily tighten bolt on the short yoke
side. Raise universal joint to make sure the bolt
is properly passing through the cutout at the
serrated section.
 - (4) Tighten bolt on the long yoke, then the one
on the short yoke side.

Tightening torque:

24 N·m (2.4 kgf·m, 17.4 ft·lb)

CAUTION:

- Make sure that universal joint bolt is tight-
ened through notch in shaft serration.
- Excessively large tightening torque of uni-
versal joint bolts may lead to heavy steering
wheel operation.

**Standard clearance between gearbox to DOJ:
Over 15 mm (0.59 in)**

- 2) Align center of roll connector. <Ref. to AB-20,
ADJUSTMENT, Roll Connector.>

CAUTION:

**Ensure that front wheels are set straight for-
ward.**

- 3) Install steering wheel and airbag module. <Ref.
to PS-17, INSTALLATION, Steering Wheel.>

WARNING:

**Always refer to “Airbag System” before per-
forming airbag module service. <Ref. to AB-3,
CAUTION, General Description.> and <Ref. to
AB-13, INSTALLATION, Driver’s Airbag Mod-
ule.>**

UNIVERSAL JOINT

Power Assisted System (Power Steering)

C: INSPECTION S601273A10

Clean the disassembled parts with a cloth, and check for wear, damage, or any other faults. If necessary, repair or replace faulty parts.

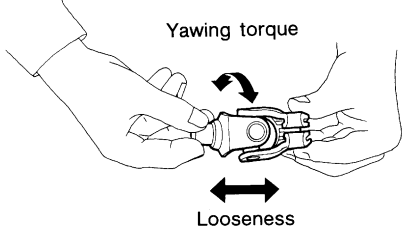
Inspection	Corrective action
<ul style="list-style-type: none"> ● Free play ● Swinging torque Yawing torque Looseness  <p style="text-align: center;">Yawing torque</p> <p style="text-align: center;">Looseness</p> <p style="text-align: right;">G4M0089</p> <p>Standard value of universal joint free play: 0 mm (0 in) Max. value of universal joint swinging torque: 0.3 N·m (0.03 kgf·m, 0.2 ft·lb)</p>	<p>Replace if faulty.</p>

Measurement of folding torque of universal joint is as shown in the figures.

Service limit:
Maximum load; 5.49 N (0.56 kgf, 1.23 lb)
or less

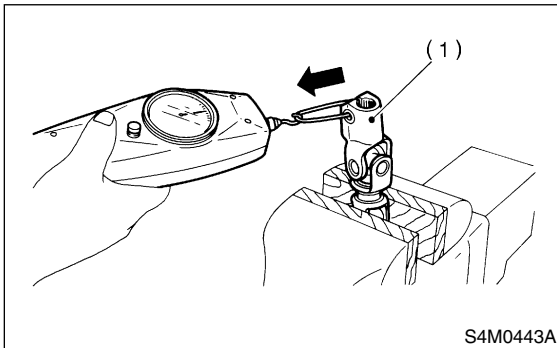

(1) Long yoke

Service limit:
Maximum load; 5.49 N (0.56 kgf, 1.23 lb)
or less

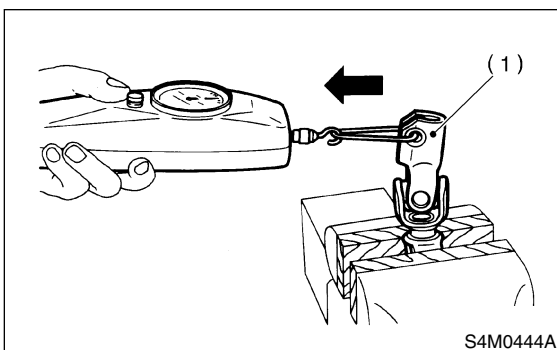

(1) Long yoke

Service limit:
Maximum load; 8.43 N (0.86 kgf, 1.90 lb)
or less

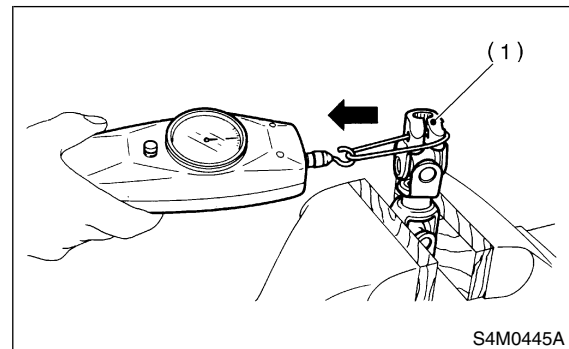

(1) Short yoke

Service limit:
Maximum load; 8.43 N (0.86 kgf, 1.90 lb)
or less

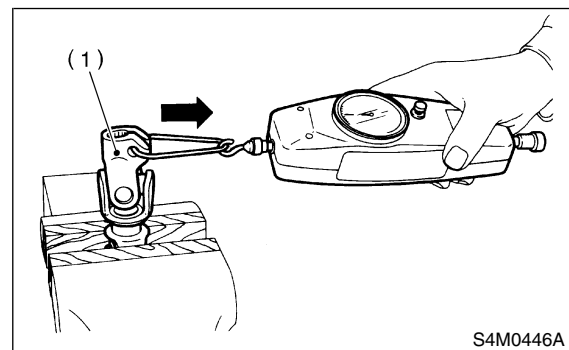

(1) Short yoke