

# GENERAL DESCRIPTION

Front Suspension

## 1. General Description S202001

### A: SPECIFICATIONS S202001E49

#### 1. STABILIZER S202001E4901

Model	Bar dia.
Except OUTBACK	20 mm (0.79 in)
OUTBACK	21 mm (0.83 in)

#### 2. WHEEL ALIGNMENT S202001E4902

Model	Sedan	Wagon	OUTBACK
Camber (tolerance: $\pm 0^{\circ}30'$ )	$-0^{\circ}05'$	$-0^{\circ}05'$	$0^{\circ}20'$
Caster (common difference: $\pm 0^{\circ}45'$ )	$3^{\circ}05'$	$2^{\circ}50'$	$2^{\circ}40'$
Toe-in	0 $\pm$ 3 mm (0 $\pm$ 0.12 in) Each toe angle: $\pm 0^{\circ}15'$		
Kingpin angle	$14^{\circ}15'$	$14^{\circ}15'$	$13^{\circ}30'$
Wheel arch height [tolerance: $+^{12}/_{-24}$ mm ( $+^{0.47}/_{-0.94}$ in)]	388 mm (15.28 in)	388 mm (15.28 in)	424 mm (16.69 in)

#### NOTE:

- Front and rear toe-ins and front camber can be adjusted. If toe-in or camber tolerance exceeds specifications, adjust toe-in and camber to the middle value of specification.
- The other items indicated in the specification table cannot be adjusted. If the other items exceeds specifications, check suspension parts and connections for deformities; replace with new ones as required.

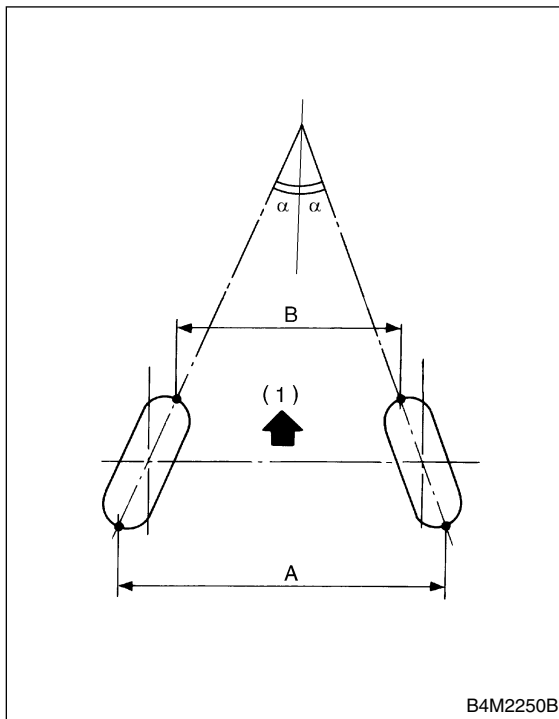

(1) Front

A - B = Positive: Toe-in, Negative: Toe-out

$\alpha$  = Each toe angle

### B: COMPONENT

S202001A05

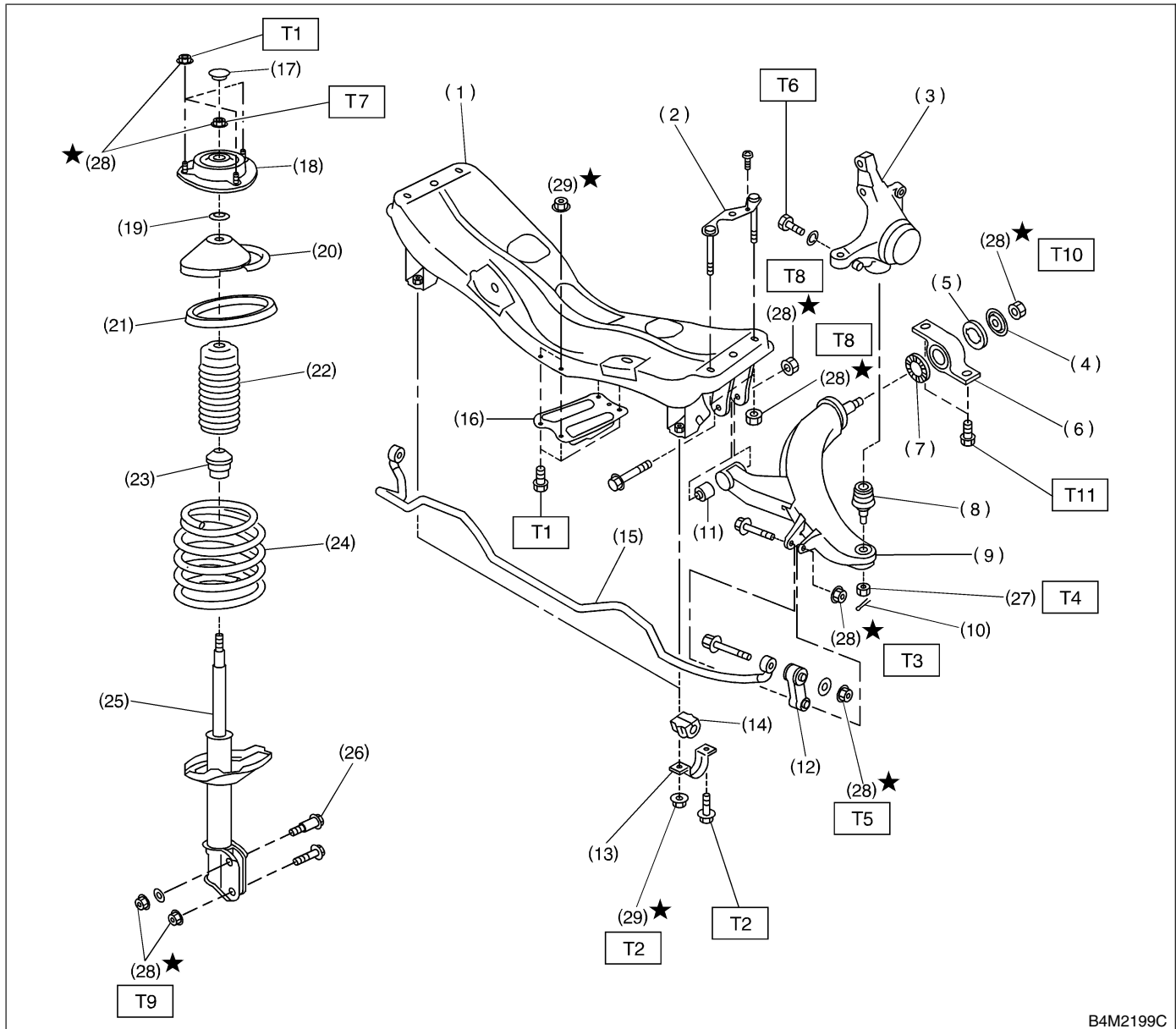

B4M2199C

- |                            |                        |
|----------------------------|------------------------|
| (1) Front crossmember      | (16) Jack-up plate     |
| (2) Bolt ASSY              | (17) Dust seal         |
| (3) Housing                | (18) Strut mount       |
| (4) Washer                 | (19) Spacer            |
| (5) Stopper rubber (Rear)  | (20) Upper spring seat |
| (6) Rear bushing           | (21) Rubber seat       |
| (7) Stopper rubber (Front) | (22) Dust cover        |
| (8) Ball joint             | (23) Helper            |
| (9) Transverse link        | (24) Coil spring       |
| (10) Cotter pin            | (25) Damper strut      |
| (11) Front bushing         | (26) Adjusting bolt    |
| (12) Stabilizer link       | (27) Castle nut        |
| (13) Clamp                 | (28) Self-locking nut  |
| (14) Bushing               | (29) Flange nut        |
| (15) Stabilizer            |                        |

#### Tightening torque: N·m (kgf-m, ft-lb)

- |                             |
|-----------------------------|
| <b>T1: 20 (2.0, 14.5)</b>   |
| <b>T2: 25 (2.5, 18.1)</b>   |
| <b>T3: 30 (3.1, 22)</b>     |
| <b>T4: 39 (4, 29)</b>       |
| <b>T5: 45 (4.6, 33)</b>     |
| <b>T6: 50 (5.1, 37)</b>     |
| <b>T7: 54 (5.5, 39.8)</b>   |
| <b>T8: 100 (10.2, 74)</b>   |
| <b>T9: 152 (16, 116)</b>    |
| <b>T10: 186 (19.0, 137)</b> |
| <b>T11: 245 (25.0, 181)</b> |

# GENERAL DESCRIPTION

Front Suspension

---

## **C: CAUTION** S202001A03

- Wear working clothing, including a cap, protective goggles, and protective shoes during operation.
- Remove contamination including dirt and corrosion before removal, installation or disassembly.
- Keep the disassembled parts in order and protect them from dust or dirt.
- Before removal, installation or disassembly, be sure to clarify the failure. Avoid unnecessary removal, installation, disassembly, and replacement.
- Use SUBARU genuine grease etc. or the equivalent. Do not mix grease etc. with that of another grade or from other manufacturers.
- Be sure to tighten fasteners including bolts and nuts to the specified torque.
- Place shop jacks or safety stands at the specified points.
- Apply grease onto sliding or revolution surfaces before installation.
- Before installing O-rings or snap rings, apply sufficient amount of grease to avoid damage and deformation.
- Before securing a part on a vise, place cushioning material such as wood blocks, aluminum plate, or shop cloth between the part and the vise.

**D: PREPARATION TOOL** S202001A17

**1. SPECIAL TOOLS** S202001A1701

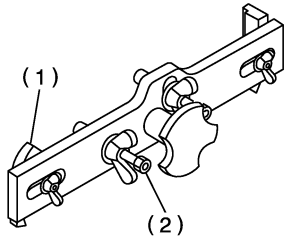
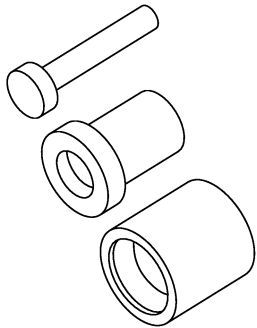
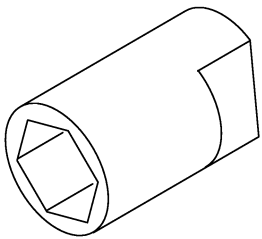
ILLUSTRATION	TOOL NUMBER	DESCRIPTION	REMARKS
 <p>B4M2378A</p>	927380002	ADAPTER	Used as an adapter for camber & caster gauge when measuring camber and caster. (1) 28199AC000 PLATE (2) 28199AC010 BOLT
 <p>B4M2385</p>	927680000	INSTALLER & REMOVER	Used for replacing transverse link bushing.
 <p>B4M2384</p>	927760000	STRUT MOUNT SOCKET	Used for disassembling and assembling strut and shock mount.

**2. GENERAL PURPOSE TOOLS** S202001A1702

TOOL NAME	REMARKS
Alignment gauge	Used for wheel alignment measurement.
Turning radius gauge	Used for wheel alignment measurement.
Toe-in gauge	Used for toe-in measurement.
Dial gauge	Used for damper strut measurement.