

LINK UPPER

Rear Suspension

5. Link Upper S201103

A: REMOVAL S201103A18

- 1) Loosen wheel nuts. Lift-up vehicle and remove wheel.
- 2) Use transmission jack to support rear arm horizontally.

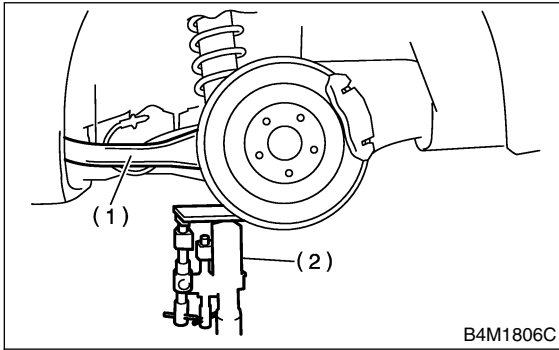

- (1) Rear arm
- (2) Transmission jack

- 3) Remove bolt securing link upper to sub frame.

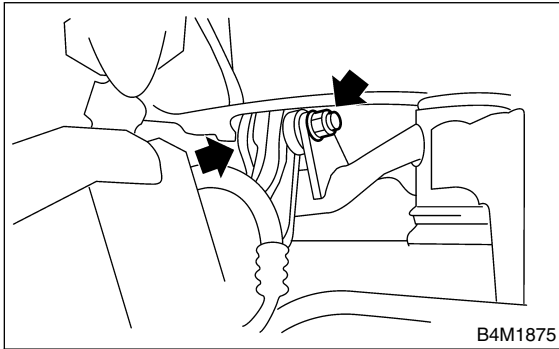

- 4) Remove bolts which secure link upper to rear arm and detach link upper.

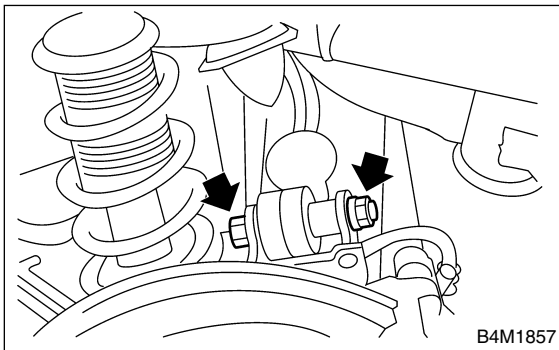

B: INSTALLATION S201103A11

Install in the reverse order of removal, observing the following instructions.

CAUTION:

- Using transmission jack, support rear arm horizontally, install link upper and tighten nuts to specified torque.

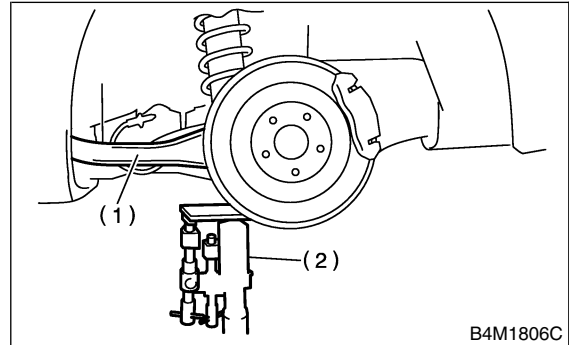

- (1) Rear arm
- (2) Transmission jack

- Tighten nut when installing adjusting bolt.
- Replace self-locking nut.

NOTE:

Check wheel alignment and adjust if necessary.

Tightening torque:

120 N·m (12.2 kgf·m, 88 ft·lb)

C: DISASSEMBLY S201103A06

Using ST, press bushing out of place.

ST 20099AE010 INSTALLER & REMOVER

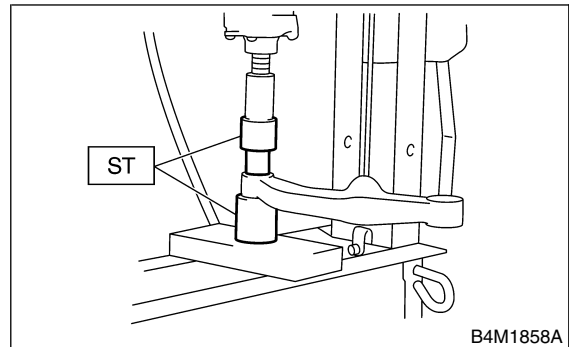

D: ASSEMBLY S201103A02

1) Using ST, press bushing into place.
ST 20099AE010 INSTALLER & REMOVER

CAUTION:
Outer bushing has a “directional” design. Be sure to install bushing with longer inner housing side facing vehicle rear.

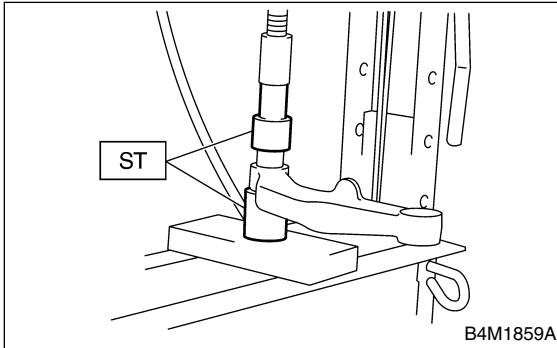

E: INSPECTION S201103A10

Visually check link upper for damage or bends.