

8. Link Rear S201102

A: REMOVAL S201102A18

- 1) Loosen wheel nuts. Lift-up vehicle and remove wheel.
- 2) Remove bolt securing stabilizer clamps to sub frame.

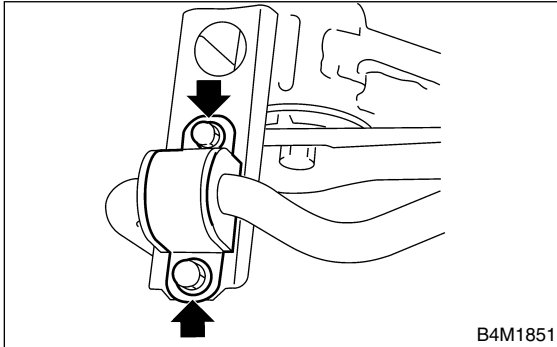

- 3) Remove support sub frame RH. (When removing RH side link rear.)

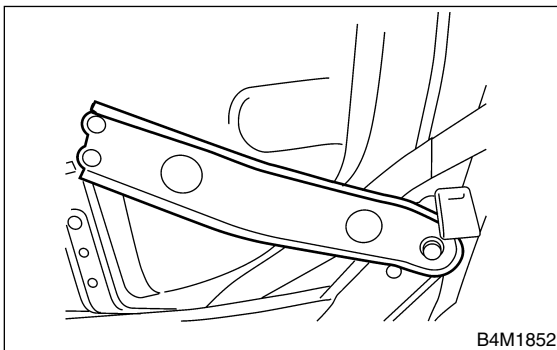

- 4) Remove stabilizer link.

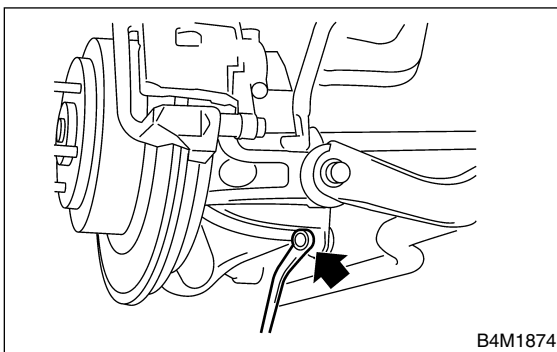

- 5) Use transmission jack to support rear arm horizontally.

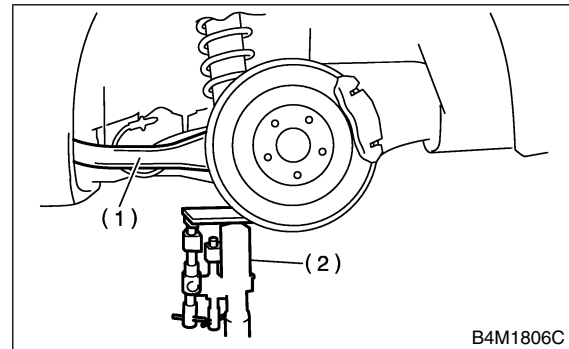

- (1) Rear arm
- (2) Transmission jack

- 6) Remove bolt securing link rear to rear arm.

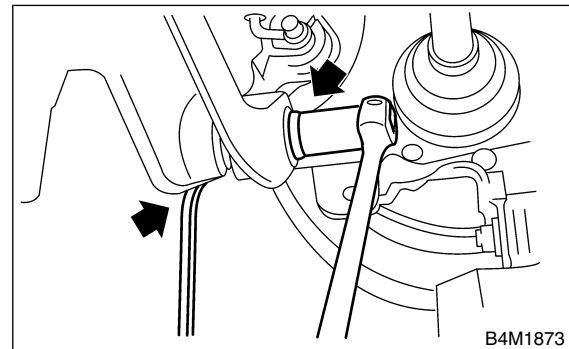

- 7) Scribe an alignment mark on link rear adjusting bolt and sub frame.
- 8) Remove bolts securing link rear to sub frame, detach link rear.

CAUTION:

To loosen adjusting bolt, always loosen nut while holding the head of adjusting bolt.

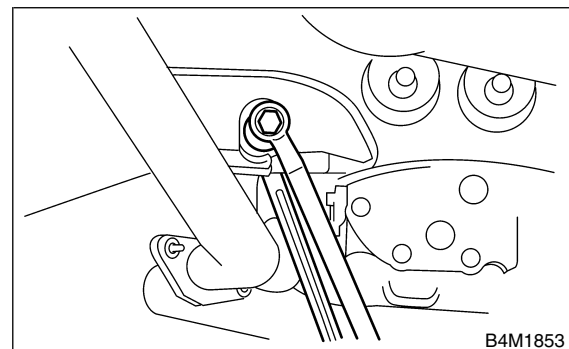

LINK REAR

Rear Suspension

B: INSTALLATION S201102A11

Install in the reverse order of removal, observing the following instructions.

CAUTION:

- Using transmission jack, support rear arm horizontally, install link rear and tighten nuts to specified torque.

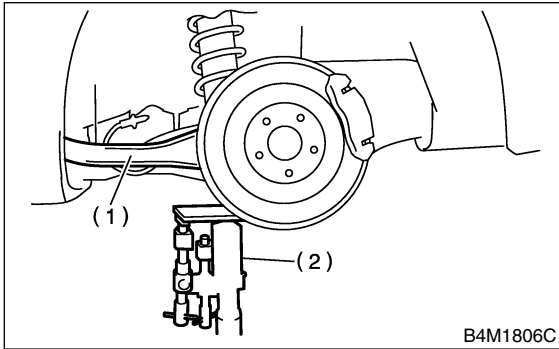

- (1) Rear arm
- (2) Transmission jack

- Tighten nut when installing adjusting bolt.
- Replace self-locking nut.

NOTE:

Check wheel alignment and adjust if necessary.

C: DISASSEMBLY S201102A06

Using ST-A, B, press bushing out of place.
ST-A, B 20099AE000 INSTALLER & REMOVER

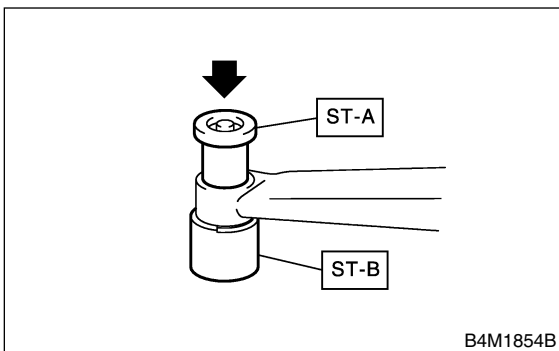

D: ASSEMBLY S201102A02

Using ST, press bushing into place.
ST-A, B 20099AE000 INSTALLER & REMOVER

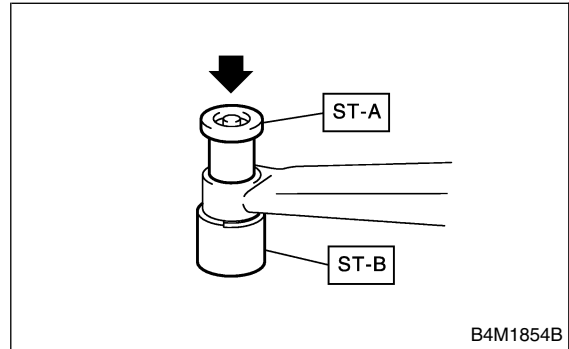

E: INSPECTION S201102A10

Visually check link rear for damage or bends.