

REAR GATE GLASS

GLASS/WINDOWS/MIRRORS

11.Rear Gate Glass

A: REMOVAL

- 1) Remove rear wiper motor. <Ref. to WW-15, REMOVAL, Rear Wiper Motor.>
- 2) Remove electrical connector from rear defogger terminal.
- 3) Remove glass in the same procedure as for windshield glass. <Ref. to GW-20, REMOVAL, Windshield Glass.>

B: INSTALLATION

- 1) Apply adhesive evenly to the glass attachment area.
- 2) Insert the glass clip pin into the rear gate hole, and after pushing on the area around the clip pin to secure it, push lightly all around the area to seal it.
- 3) About one hour after installation, conduct a leak test.

- 4) After completion of all work, allow vehicle to stand for about 24 hours.

NOTE:

For minimum drying time and time the vehicle must be left standing before driving after bonding, follow instructions or instruction manual from the adhesive manufacturer.

CAUTION:

When a vehicle is returned to the user, tell him or her that the vehicle should not be subjected to heavy impact for at least three days.

- 5) Connect rear defogger terminals.
- 6) Install rear wiper. <Ref. to WW-15, INSTALLATION, Rear Wiper Motor.>

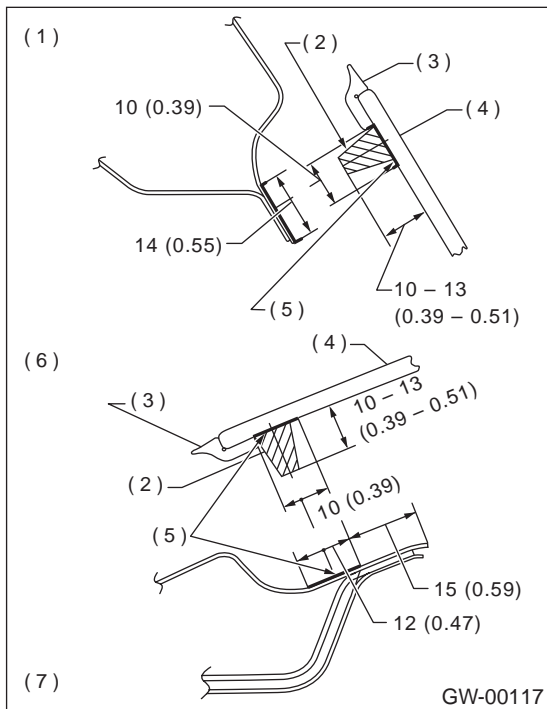

- (1) Upper side
- (2) Adhesive
- (3) Strip rubber
- (4) Glass
- (5) Primer
- (6) Left and right side
- (7) Unit: mm (in)

CAUTION:

- When door is opened/closed after glass is bonded, always lower door glass and then open/close it carefully.
- Move vehicle slowly.

GW-23