

ENGINE COOLANT TEMPERATURE SENSOR

FUEL INJECTION (FUEL SYSTEMS)

4. Engine Coolant Temperature Sensor

A: REMOVAL

- 1) Disconnect battery ground cable.

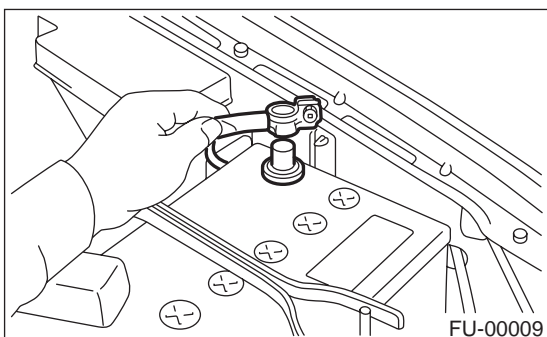

- 2) Remove air intake duct and air cleaner case.
<Ref. to IN(H4SO)-6, REMOVAL, Air Intake Duct.>
and <Ref. to IN(H4SO)-5, REMOVAL, Air Cleaner Case.>

- 3) Disconnect connector from engine coolant temperature sensor.

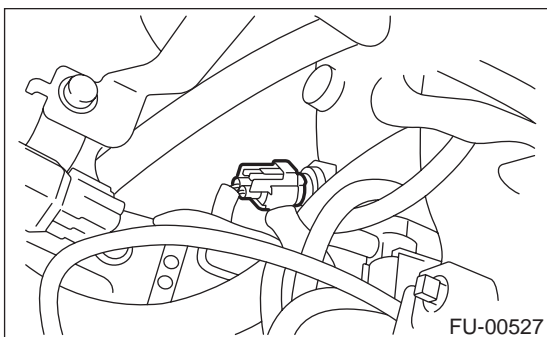

- 4) Remove engine coolant temperature sensor.

B: INSTALLATION

Install in the reverse order of removal.

Tightening torque:

18 N·m (1.8 kgf-m, 1.3 ft-lb)

