

THROTTLE POSITION SENSOR

FUEL INJECTION (FUEL SYSTEMS)

8. Throttle Position Sensor

A: REMOVAL

- 1) Disconnect battery ground cable.

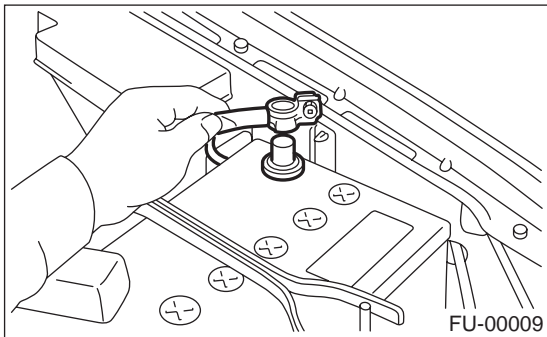

- 2) Disconnect connector from throttle position sensor.

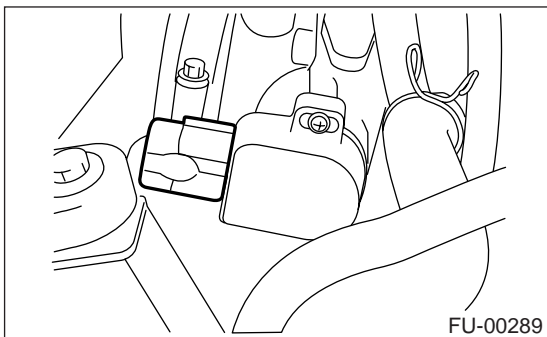

- 3) Remove throttle position sensor holding screws, and remove it.

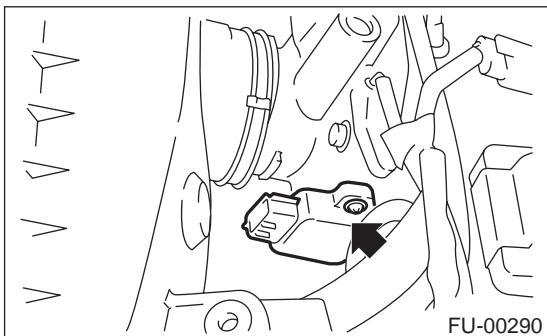

B: INSTALLATION

Install in the reverse order of removal.

Tightening torque:

2.4 N·m (0.24 kgf-m, 1.7 ft-lb)

CAUTION:

When installing throttle position sensor, adjust to the specified data.

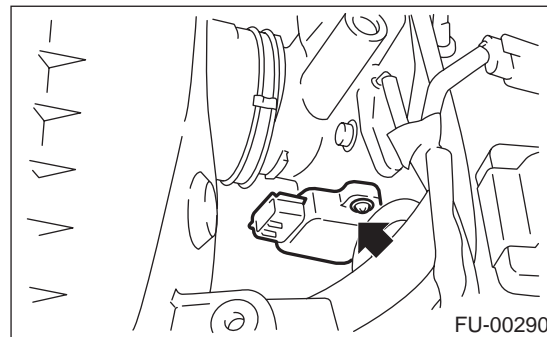

C: ADJUSTMENT

- 1) Turn ignition switch to OFF.
- 2) Loosen throttle position sensor holding screws.

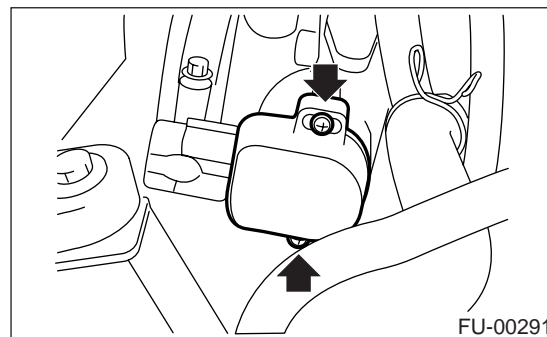

- 3) When using voltage meter;
 - (1) Take out ECM.
 - (2) Turn ignition switch to ON.
 - (3) Adjust throttle position sensor to the proper position to allow the voltage signal to ECM to be in specification.

Connector & terminal / Specified voltage

(B135) No. 13 — (B135) No. 19 / 0.45 — 0.55 V

[Fully closed.]

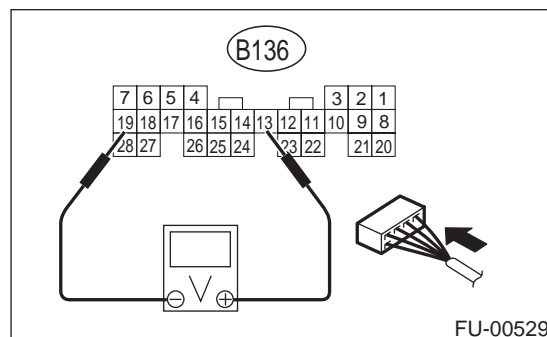

THROTTLE POSITION SENSOR

FUEL INJECTION (FUEL SYSTEMS)

- (4) Tighten throttle position sensor holding screws.

Tightening torque:

2.4 N·m (0.24 kgf·m, 1.7 ft·lb)

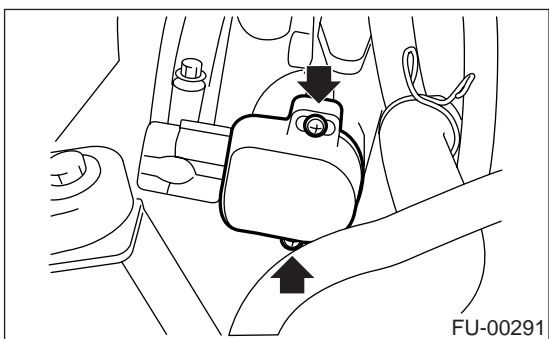

- 4) When using Subaru Select Monitor;
- (1) Turn ignition switch to OFF.
 - (2) Loosen throttle position sensor holding screws.

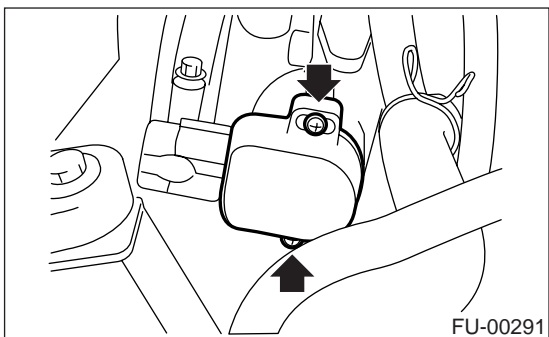

- 5) Turn ignition switch to ON, and Subaru Select Monitor switch to ON.

- 6) Select {2. Each System Check} in Main Menu.

- 7) Select {Engine Control System} in Selection Menu.

- 8) Select {1. Current Data Display & Save} in Engine Control System Diagnosis.

- 9) Select {1.12 Data Display} in Data Display Menu.

- 10) Adjust throttle position sensor to the proper position to match with the following specifications.

Condition: Throttle fully closed

Throttle opening angle 0.00%

Throttle sensor voltage 0.50 V

- 11) Tighten throttle position sensor holding screws.

Tightening torque:

2.4 N·m (0.24 kgf·m, 1.7 ft·lb)

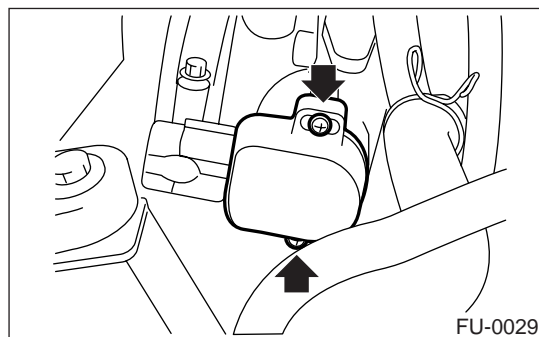

NOTE:

For detailed operation procedures, refer to the Subaru Select Monitor Operation Manual.

- (3) Insert the cartridge to Subaru Select Monitor. <Ref. to FU(H4SO)-13, PREPARATION TOOL, General Description.>

- (4) Connect Subaru Select Monitor to the data link connector (A).

