

## ENGINE OIL PRESSURE

MECHANICAL

### 6. Engine Oil Pressure

#### A: INSPECTION

1) Disconnect battery ground cable.

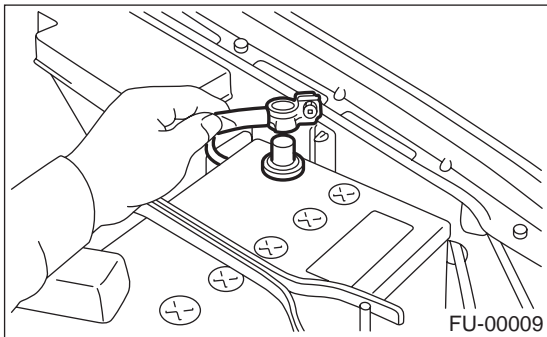

2) Remove generator from bracket. <Ref. to SC(H4SO)-15, REMOVAL, Generator.>

3) Disconnect connector from oil pressure switch.

4) Remove oil pressure switch from engine cylinder block. <Ref. to LU(H4SO)-17, REMOVAL, Oil Pressure Switch.>

5) Connect oil pressure gauge hose to cylinder block.

6) Connect battery ground cable.

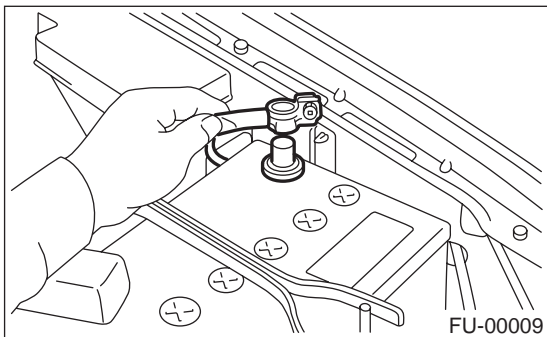

7) Start the engine, and measure oil pressure.

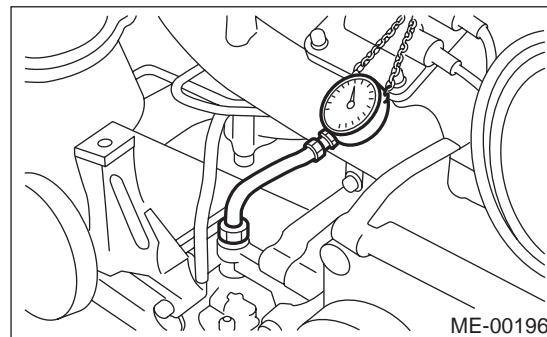

#### Oil pressure:

**88 kPa (0.9 kg/cm<sup>2</sup>, 13 psi) or more at 800 rpm**

**294 kPa (3.0 kg/cm<sup>2</sup>, 43 psi) or more at 5,000 rpm**

#### CAUTION:

- If oil pressure is out of specification, check oil pump, oil filter and lubrication line. <Ref. to LU(H4SO)-19, INSPECTION, Engine Lubrication System Trouble in General.>

- If oil pressure warning light is turned ON and oil pressure is in specification, replace oil pressure switch. <Ref. to LU(H4SO)-19, INSPECTION, Engine Lubrication System Trouble in General.>

#### NOTE:

The specified data is based on an engine oil temperature of 80°C (176°F).

8) After measuring oil pressure, install oil pressure switch. <Ref. to LU(H4SO)-17, INSTALLATION, Oil Pressure Switch.>

#### Tightening torque:

**25 N·m (2.5 kgf·m, 18.1 ft·lb)**

9) Install generator and V-belt in the reverse order of removal, and adjust the V-belt deflection. <Ref. to ME(H4SO)-42, INSTALLATION, V-belt.>