

GENERAL DESCRIPTION

COOLING

1. General Description

A: SPECIFICATIONS

Cooling system		Electric fan + Forced engine coolant circulation system	
Total engine coolant capacity		ℓ (US qt, Imp qt)	
		Approx. 7.9 (8.4, 7.0)	
Water pump	Type	Centrifugal impeller type	
	Discharge performance	Discharge	320 L (84.5 US gal, 70.4 Imp gal)/min.
		Pump speed—total engine coolant head	5,500 rpm — 18 mAq (59 ft Aq)
		Engine coolant temperature	80°C (176°F)
	Impeller diameter	73.2 mm (2.882 in)	
	Number of impeller vanes	6	
Tooth number of pump sprocket		22 t	
Thermostat	Type	Wax pellet type	
	Start to open	76 — 80°C (169 — 176°F)	
	Fully open	91°C (196°F)	
	Valve lift	9.0 mm (0.354 in) or more	
	Valve bore	35 mm (1.38 in)	
Radiator fan	Motor	120 W (main fan) 120 W (sub fan)	
	Fan diameter × Blade	320 mm (12.60 in) × 5 (main fan) 320 mm (12.60 in) × 7 (sub fan)	
Radiator	Type	Down flow, pressure type	
	Core dimensions	699 × 349 × 27 mm (27.52 × 13.74 × 1.06 in)	
	Pressure range in which cap valve is open	Above: 108±15 kPa (1.1±0.15 kg/cm ² , 16±2 psi) Below: -1.0 to -4.9 kPa (-0.01 to -0.05 kg/cm ² , -0.1 to -0.7 psi)	
	Fins	Corrugated fin type	
Reservoir tank	Capacity	0.5 L (0.5 US qt, 0.4 Imp qt)	

GENERAL DESCRIPTION

COOLING

B: COMPONENT

1. WATER PUMP

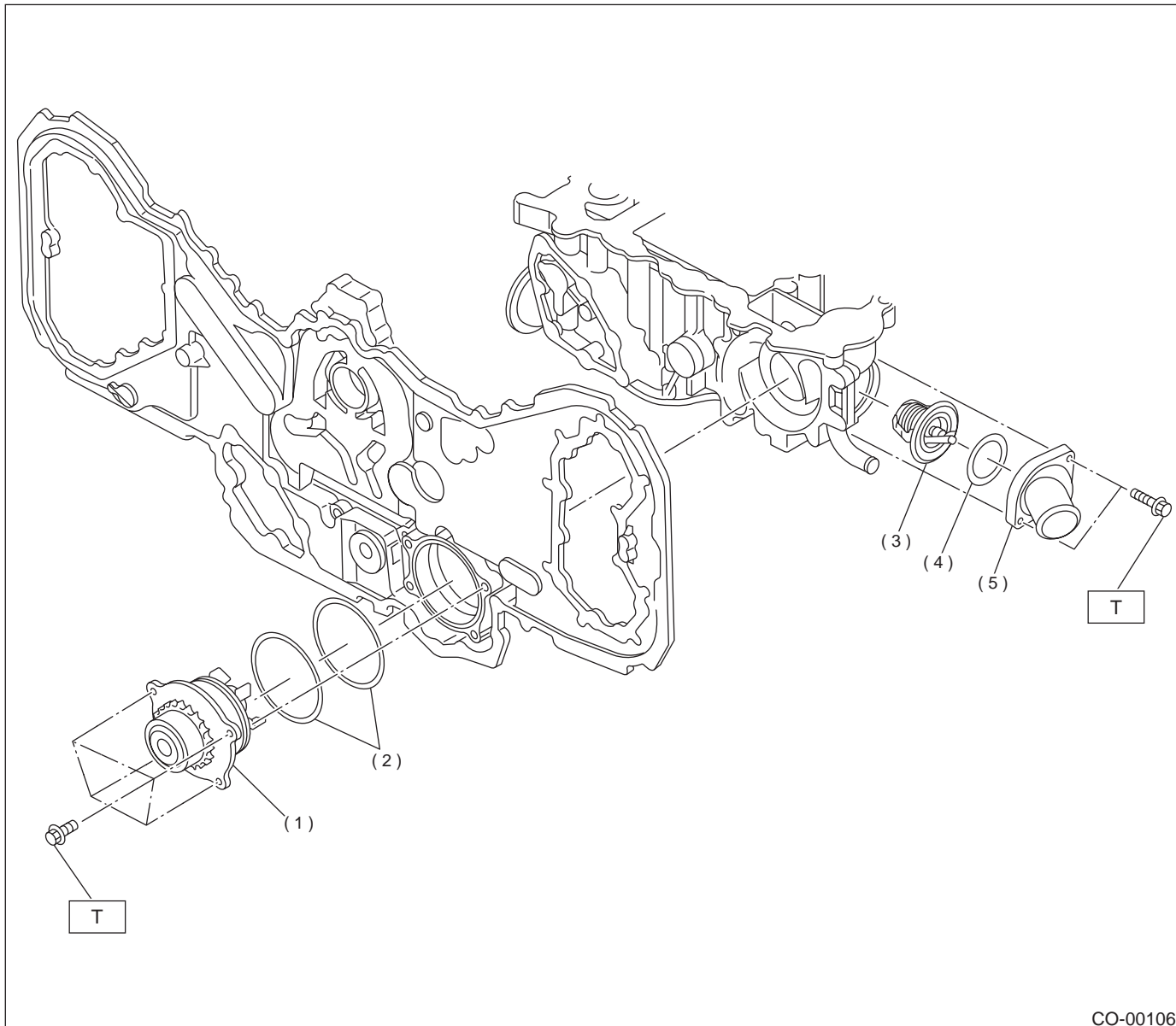

- (1) Water pump ASSY
- (2) O-ring
- (3) Thermostat

- (4) Gasket
- (5) Thermostat cover

Tightening torque: N·m (kgf·m, ft·lb)
T: 6.4 (0.65, 4.7)

CO(H6DO)-3

GENERAL DESCRIPTION

COOLING

2. RADIATOR AND RADIATOR FAN

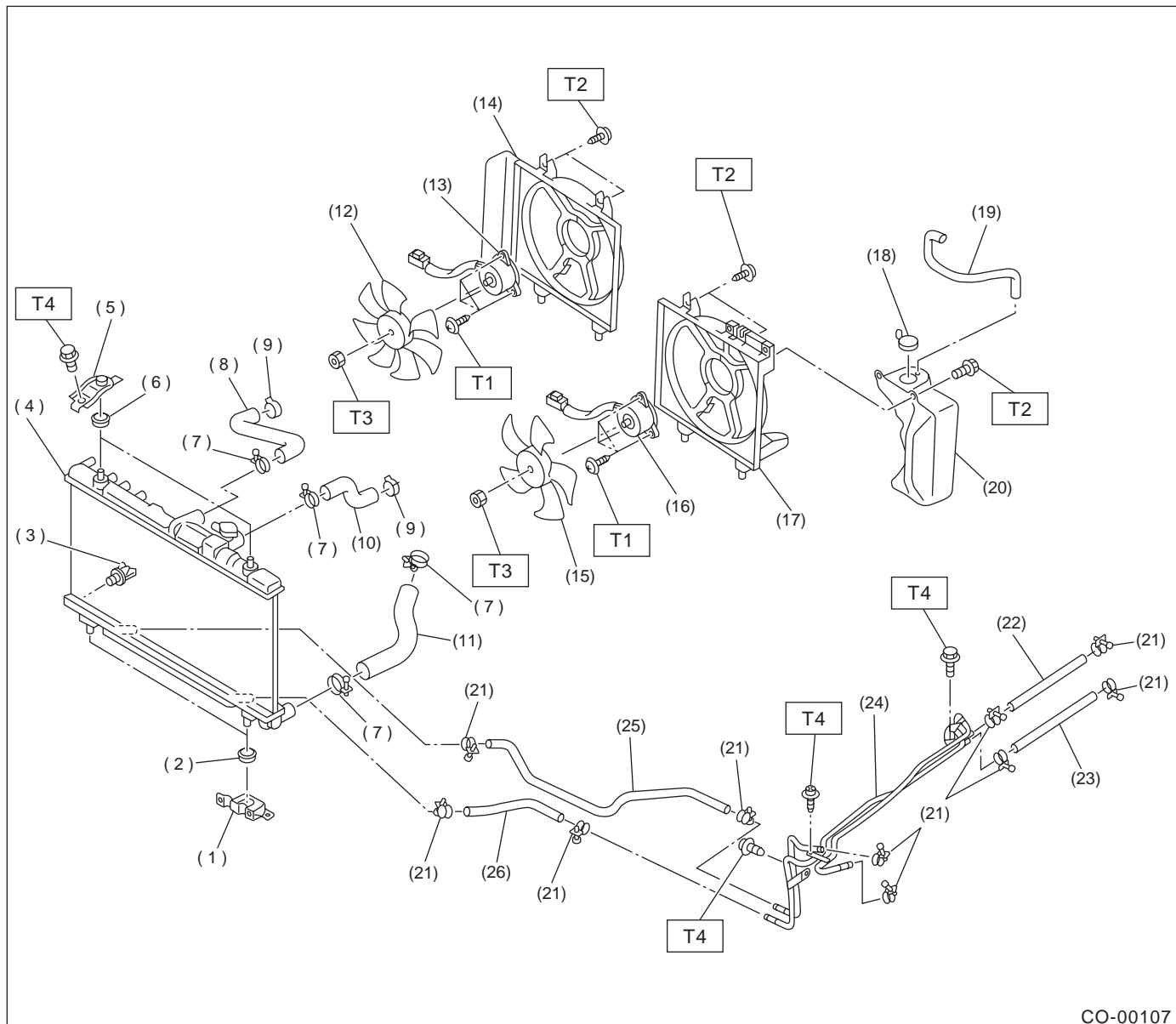

CO-00107

- | | | |
|----------------------------|--|------------------------|
| (1) Radiator lower bracket | (12) Radiator sub fan | (23) ATF outlet hose A |
| (2) Radiator lower cushion | (13) Radiator sub fan motor | (24) ATF pipe |
| (3) Drain cock | (14) Sub fan shroud | (25) ATF inlet hose B |
| (4) Radiator | (15) Radiator main fan | (26) ATF outlet hose B |
| (5) Radiator upper bracket | (16) Radiator main fan motor | |
| (6) Radiator upper cushion | (17) Main fan shroud | |
| (7) Clamp | (18) Engine coolant reservoir tank cap | |
| (8) Radiator inlet hose A | (19) Over flow hose | |
| (9) Clamp | (20) Engine coolant reservoir tank | |
| (10) Radiator inlet hose B | (21) ATF hose clamp | |
| (11) Radiator outlet hose | (22) ATF inlet hose A | |

Tightening torque: N·m (kgf-m, ft-lb)

T1: 4.4 (0.45, 3.3)

T2: 4.9 (0.50, 3.6)

T3: 7.5 (0.76, 5.5)

T4: 12 (1.2, 8.7)

CO(H6DO)-4

GENERAL DESCRIPTION

COOLING

C: CAUTION

- Wear working clothing, including a cap, protective goggles, and protective shoes during operation.
- Remove contamination including dirt and corrosion before removal, installation or disassembly.
- Keep the disassembled parts in order and protect them from dust or dirt.
- Before removal, installation or disassembly, be sure to clarify the failure. Avoid unnecessary removal, installation, disassembly, and replacement.
- Be careful not to burn your hands, because each part in the vehicle is hot after running.
- Be sure to tighten fasteners including bolts and nuts to the specified torque.
- Place shop jacks or safety stands at the specified points.
- Before disconnecting electrical connectors of sensors or units, be sure to disconnect ground cable from battery.

D: PREPARATION TOOL

1. SPECIAL TOOLS

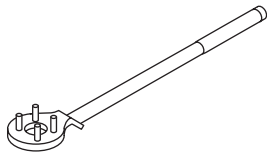
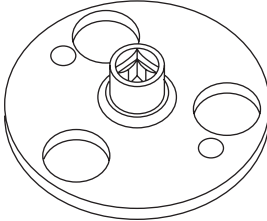
ILLUSTRATION	TOOL NUMBER	DESCRIPTION	REMARKS
 <p style="text-align: center;">ST-499977100</p>	499977100	CRANK PULLEY WRENCH	Used for stopping crankshaft pulley when loosening and tightening crankshaft pulley bolts.
 <p style="text-align: center;">ST18231AA000</p>	18231AA000	CAMSHAFT SPROCKET WRENCH	Used for removing and installing camshaft sprocket.

2. GENERAL PURPOSE TOOLS

TOOL NAME	REMARKS
Radiator cap tester	Used for measuring pressure.