

GENERAL DESCRIPTION

EXHAUST

1. General Description

A: COMPONENT

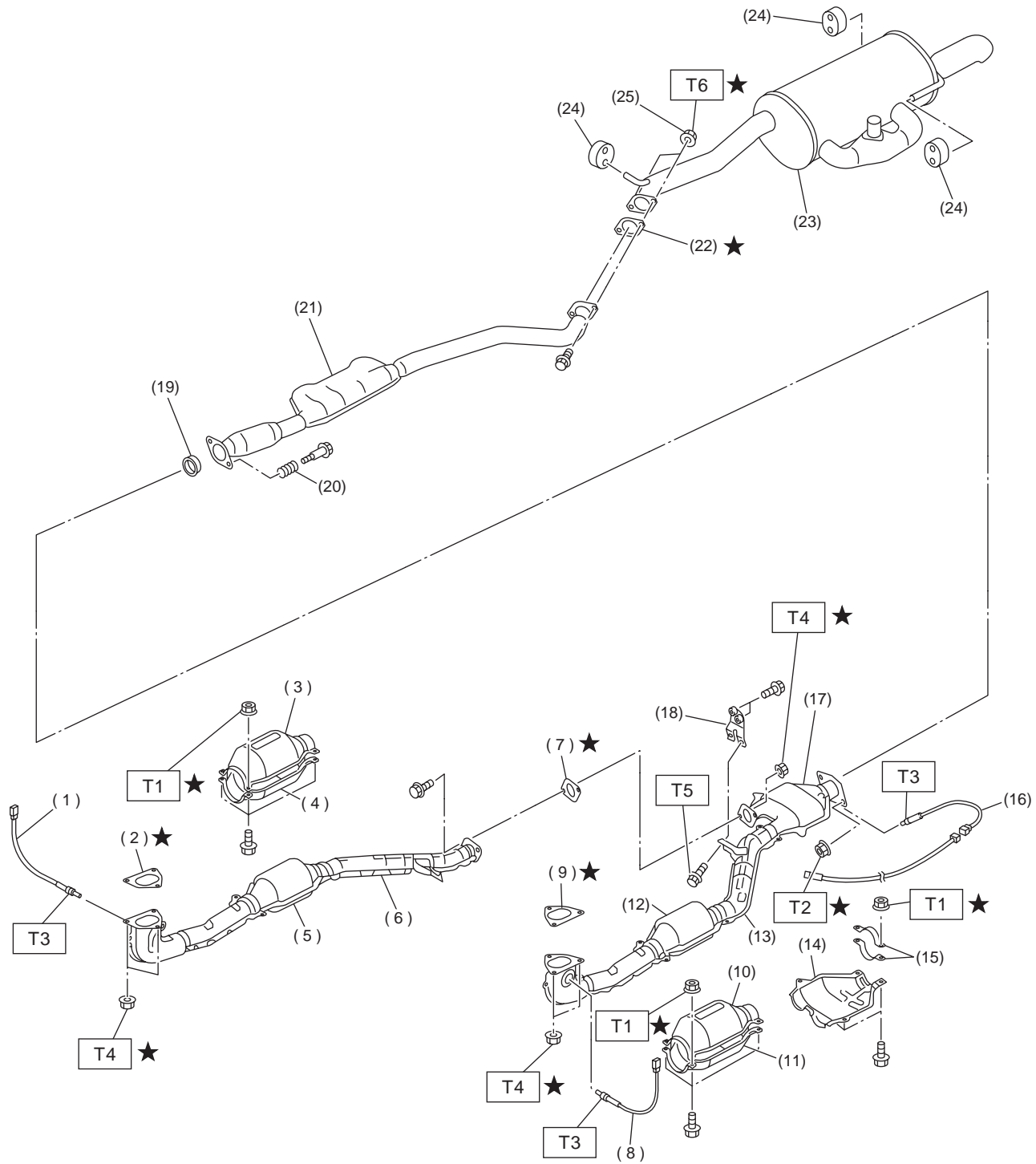

EX-00055

EX(H6DO)-2

GENERAL DESCRIPTION

EXHAUST

(1) Front oxygen (A/F) sensor (RH)	(11) Lower front catalytic converter cover (LH)	(22) Gasket
(2) Gasket (RH)	(12) Front catalytic converter (LH)	(23) Muffler
(3) Upper front catalytic converter cover (RH)	(13) Front exhaust pipe (LH)	(24) Cushion rubber
(4) Lower front catalytic converter cover (RH)	(14) Lower rear catalytic converter cover	(25) Self-locking nut
(5) Front catalytic converter (RH)	(15) Clamp	
(6) Front exhaust pipe (RH)	(16) Rear oxygen sensor	
(7) Gasket (RH)	(17) Rear catalytic converter	
(8) Front oxygen (A/F) sensor (LH)	(18) Bracket	
(9) Gasket (LH)	(19) Gasket	
(10) Upper front catalytic converter cover (LH)	(20) Spring	
	(21) Rear exhaust pipe	

Tightening torque: N·m (kgf-m, ft-lb)

T1: 13 (1.3, 9.4)

T2: 18 (1.8, 13.0)

T3: 21 (2.1, 15)

T4: 30 (3.1, 22.4)

T5: 35 (3.6, 26.0)

T6: 48 (4.9, 35.4)

GENERAL DESCRIPTION

EXHAUST

B: CAUTION

- Wear working clothing, including a cap, protective goggles, and protective shoes during operation.
- Remove contamination including dirt and corrosion before removal, installation or disassembly.
- Keep the disassembled parts in order and protect them from dust or dirt.
- Before removal, installation or disassembly, be sure to clarify the failure. Avoid unnecessary removal, installation, disassembly, and replacement.
- Be careful not to burn your hands, because each part on the vehicle is hot after running.
- Be sure to tighten fasteners including bolts and nuts to the specified torque.
- Place shop jacks or safety stands at the specified points.
- Before disconnecting electrical connectors of sensors or units, be sure to disconnect ground cable from battery.