

## KNOCK SENSOR

### FUEL INJECTION (FUEL SYSTEMS)

## 7. Knock Sensor

### A: REMOVAL

1) Disconnect battery ground cable from battery ground terminal.

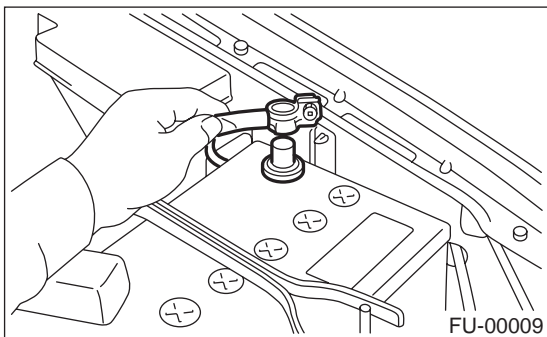

4) Connect battery ground cable.

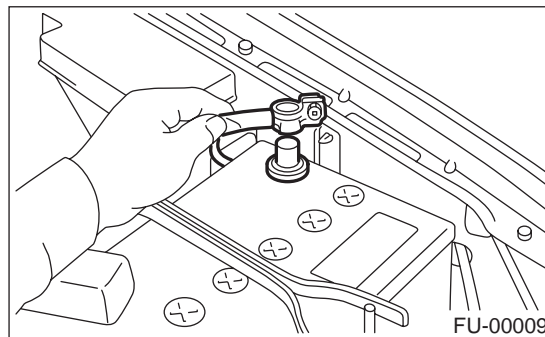

2) Remove intake manifold.

<Ref. to FU(H6DO)-17, REMOVAL, Intake Manifold.>

3) Disconnect knock sensor connector.

4) Remove knock sensor from cylinder block.

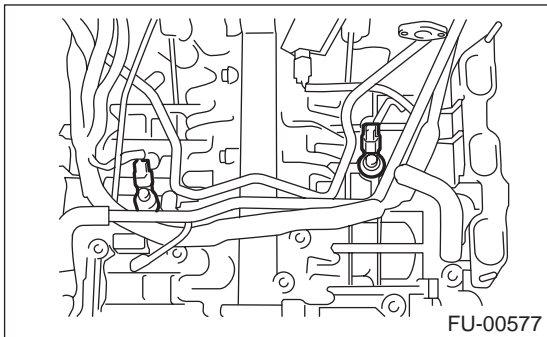

### B: INSTALLATION

1) Install knock sensor to cylinder block.

**Tightening torque:**

**25 N·m (2.5 kgf-m, 18 ft-lb)**

NOTE:

For the knock sensor's installation angle, refer to the figure below.

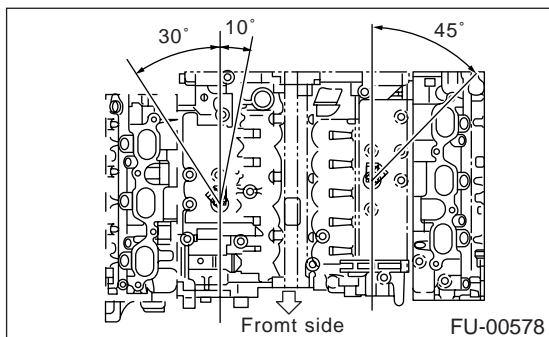

2) Connect knock sensor connector.

3) Install intake manifold. <Ref. to FU(H6DO)-20, INSTALLATION, Intake Manifold.>