

FUEL INJECTOR

FUEL INJECTION (FUEL SYSTEMS)

14. Fuel Injector

A: REMOVAL

1. RH SIDE

- 1) Release fuel pressure.
<Ref. to FU(H6DO)-50, RELEASING OF FUEL PRESSURE, OPERATION, Fuel.>
- 2) Open fuel flap lid, and remove fuel filler cap.
- 3) Disconnect battery ground cable.

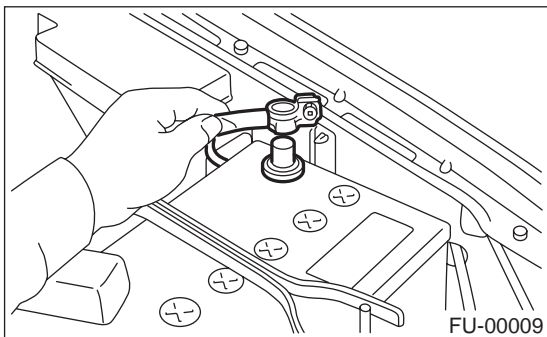

- 4) Remove air cleaner lower case. <Ref. to IN(H6DO)-5, REMOVAL, Air Cleaner.>
- 5) Remove power steering pump and tank from brackets.
 - (1) Remove V-belt.
<Ref. to ME(H6DO)-28, REMOVAL, V-belt.>
 - (2) Remove power steering oil pipe with bracket.

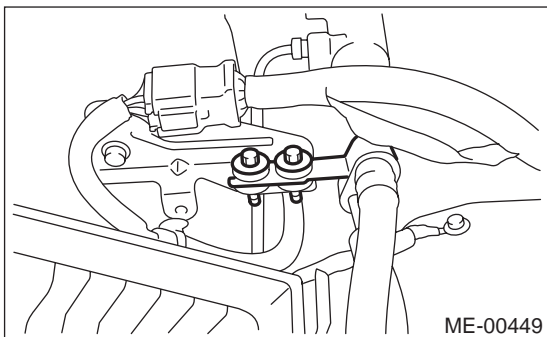

- (3) Remove bolts which install power steering pump bracket.

CAUTION:

Do not separate hose and pipe from the main pump.

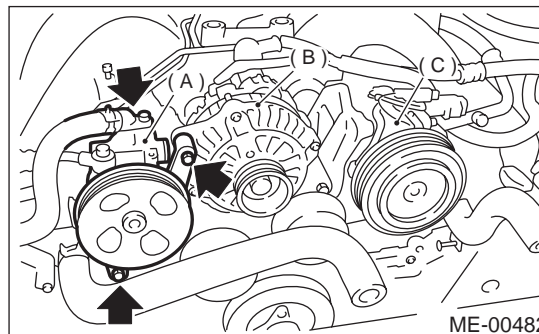

- (A) Power steering pump
- (B) Generator
- (C) A/C compressor

- (4) Disconnect power steering pump switch connector.

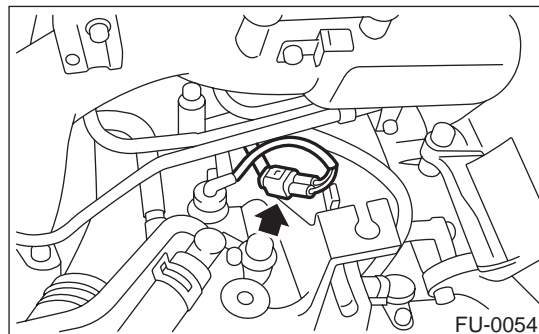

- (5) Remove power steering tank from the bracket by pulling it upward.

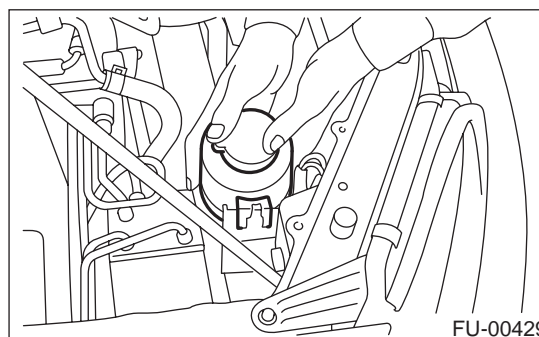

FUEL INJECTOR

FUEL INJECTION (FUEL SYSTEMS)

- (6) Place power steering pump on the right side wheel apron.

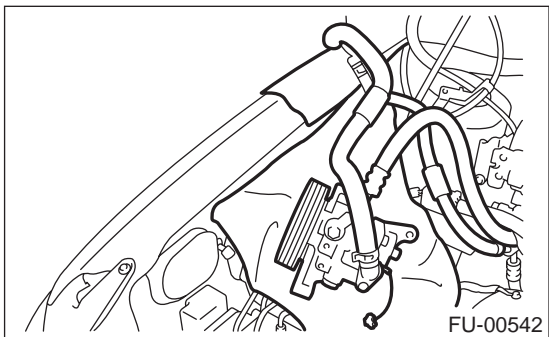

- 6) Remove ground cable from fuel pipe protector RH.

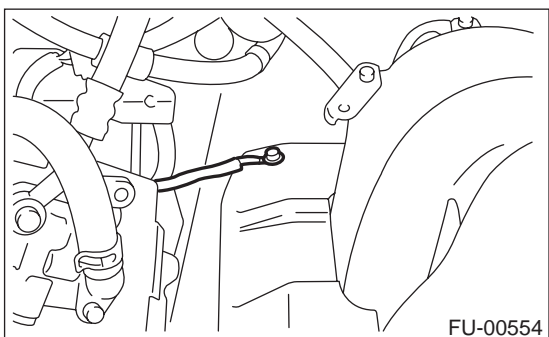

- 7) Remove fuel pipe protector RH.

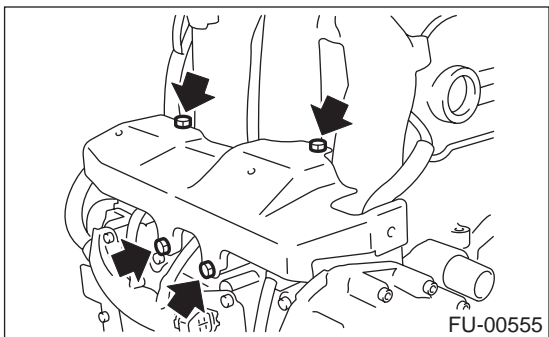

- 8) Disconnect connector (A) from fuel injector.
9) Remove bolt (B) which holds injector pipe onto cylinder head.

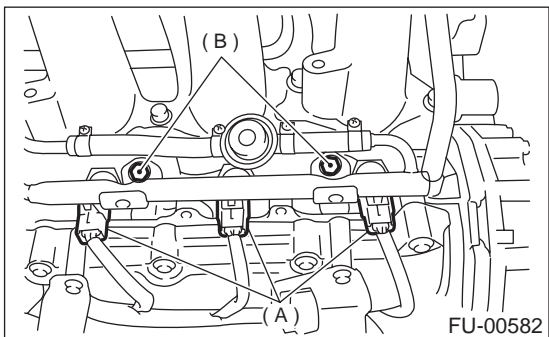

- 10) Remove fuel injector while lifting up fuel injector pipe.

2. LH SIDE

- 1) Release fuel pressure. <Ref. to FU(H6DO)-50, RELEASING OF FUEL PRESSURE, OPERATION, Fuel.>
2) Open fuel flap lid, and remove fuel filler cap.
3) Disconnect battery ground cable.

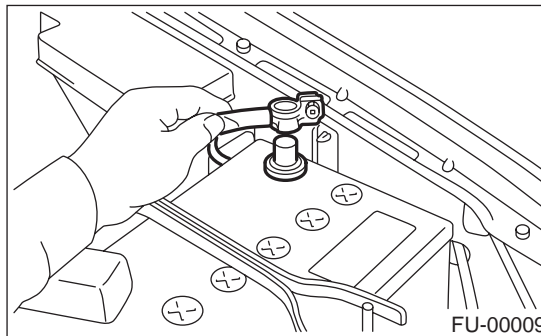

- 4) Remove two bolts which install washer tank on body.

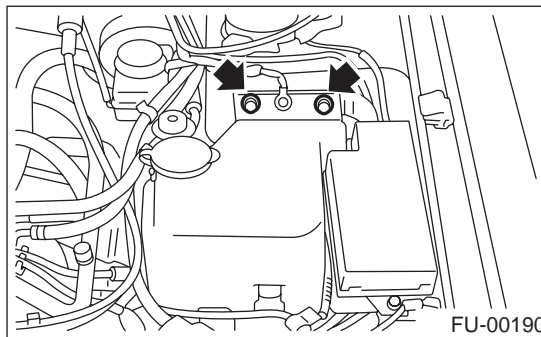

- 5) Disconnect connector from front window washer motor.
6) Disconnect connector from rear gate glass washer motor.

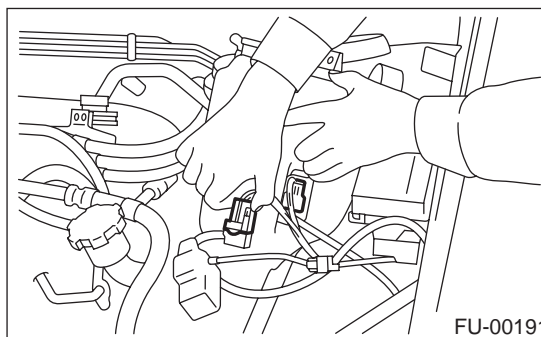

- 7) Disconnect rear window glass washer hose from washer motor, then plug connection with a suitable cap.

FUEL INJECTOR

FUEL INJECTION (FUEL SYSTEMS)

8) Move washer tank upward.

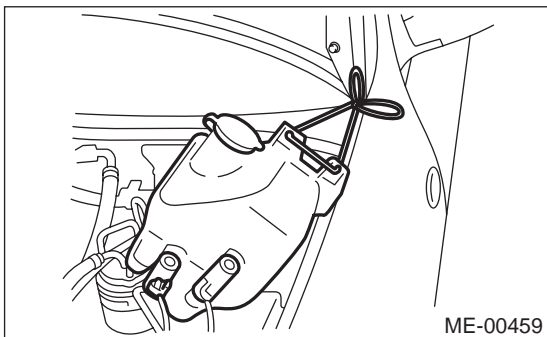

9) Remove ground cable from fuel pipe protector LH.

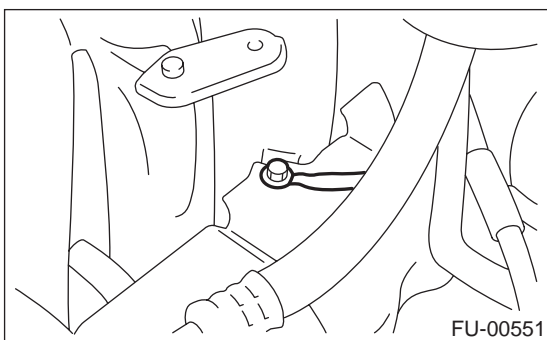

10) Remove fuel pipe protector LH.

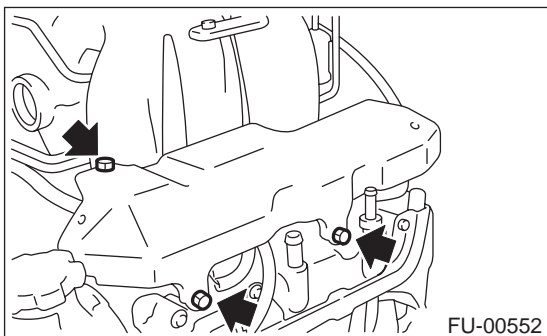

11) Disconnect connector (A) from fuel injector.
12) Remove bolt (B) which holds injector pipe onto cylinder head.

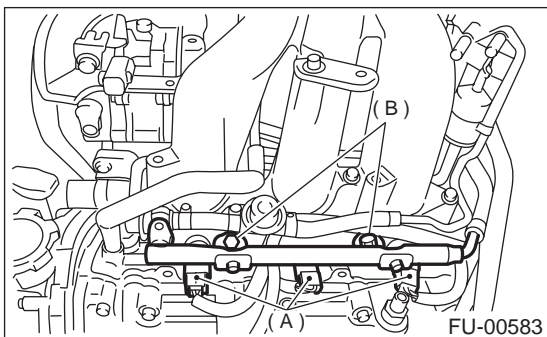

13) Remove fuel injector while lifting up fuel injector pipe.

B: INSTALLATION

1. RH SIDE

Install in the reverse order of removal.

NOTE:

Replace O-rings and insulators with new ones.

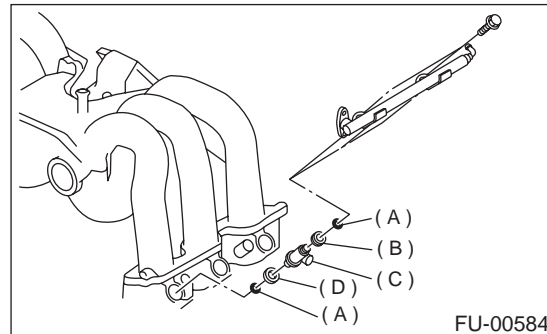

- (A) O-ring
- (B) Injection rubber
- (C) Fuel injector
- (D) Insulator

Tightening torque:

19 N·m (1.9 kgf-m, 14 ft-lb)

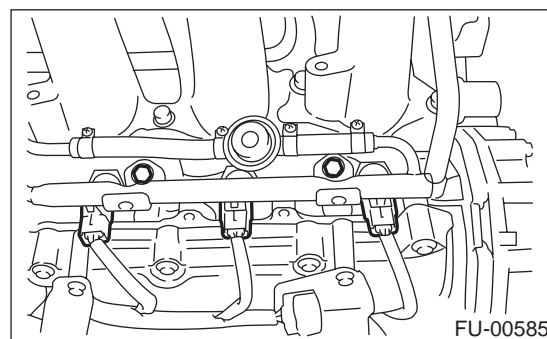

Tightening torque:

19 N·m (1.9 kgf-m, 14 ft-lb)

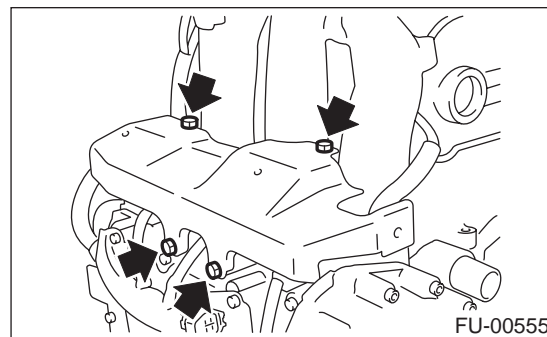

2. LH SIDE

Install in the reverse order of removal.

FUEL INJECTOR

FUEL INJECTION (FUEL SYSTEMS)

NOTE:

Replace O-rings and insulators with new ones.

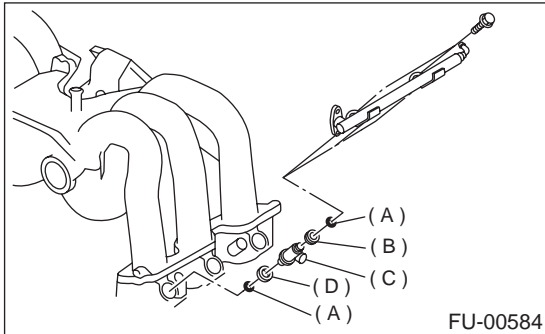

- (A) O-ring
- (B) Injection rubber
- (C) Fuel injector
- (D) Insulator

Tightening torque:

19 N·m (1.9 kgf·m, 14 ft·lb)

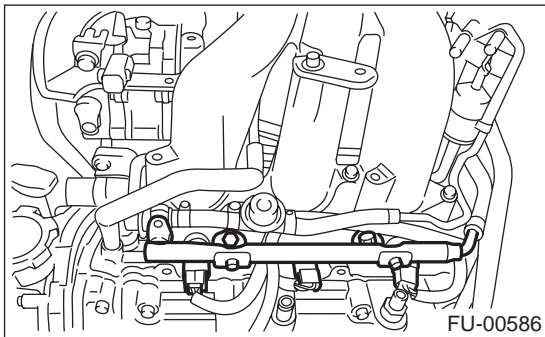

Tightening torque:

19 N·m (1.9 kgf·m, 14 ft·lb)

