

GENERAL DESCRIPTION

SPEED CONTROL SYSTEMS

1. General Description

A: SPECIFICATION

Accelerator pedal	Free play	At pedal pad	1 — 4 mm (0.04 — 0.16 in)
	Stroke	At pedal pad	50 — 55 mm (1.97 — 2.17 in)

B: COMPONENT

1. LHD MODEL

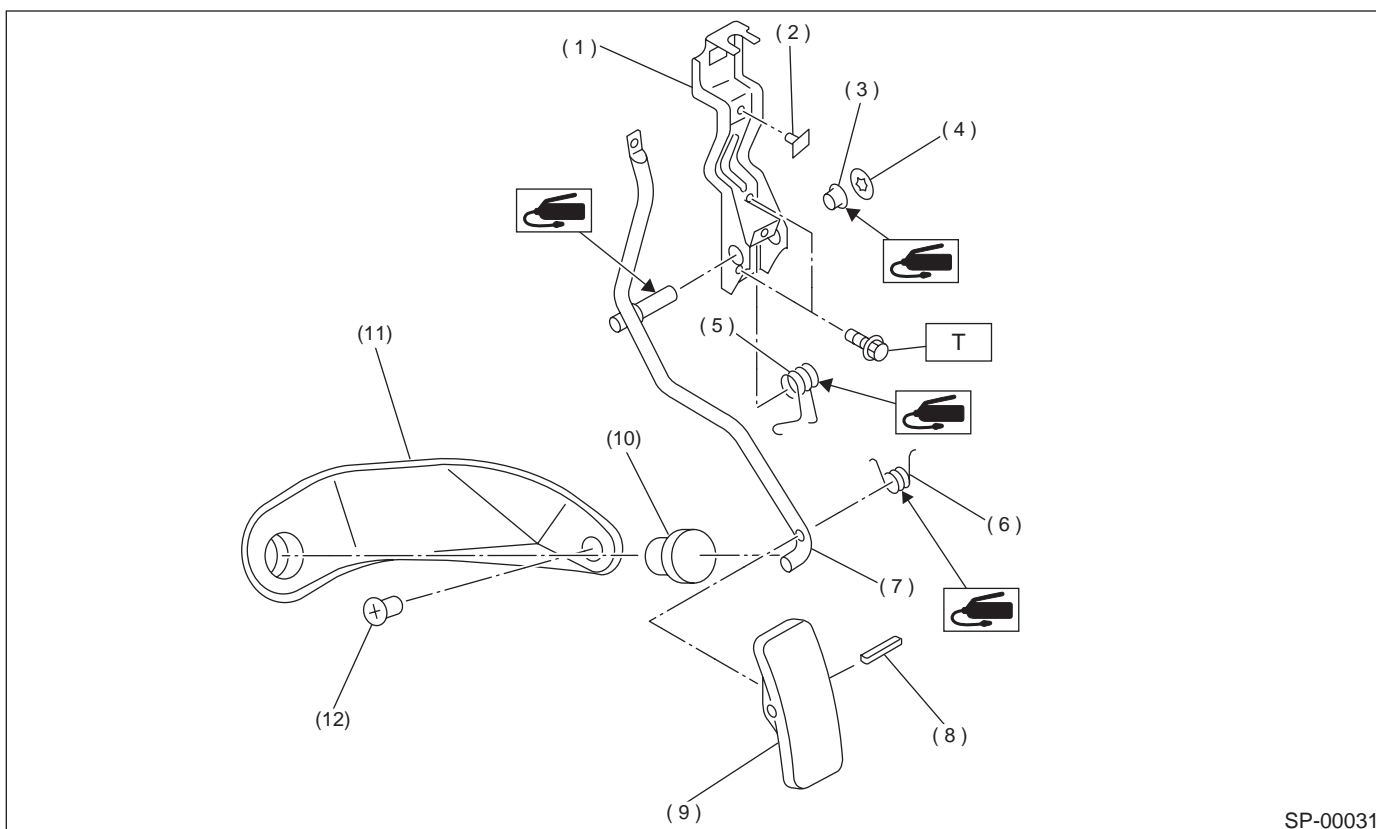

- | | |
|---|---|
| <ul style="list-style-type: none"> (1) Accelerator bracket (2) Stopper (3) Bushing (4) Clip (5) Accelerator spring (6) Accelerator pedal spring | <ul style="list-style-type: none"> (7) Accelerator pedal lever (8) Spring pin (9) Accelerator pedal (10) Accelerator stopper (11) Accelerator plate (12) Clip |
|---|---|

Tightening torque: N·m (kgf-m, ft-lb)
T: 18 (1.8, 13.0)

GENERAL DESCRIPTION

SPEED CONTROL SYSTEMS

C: CAUTION

- Wear work clothing, including a cap, protective goggles, and protective shoes during operation.
- Remove contamination, including dirt and corrosion, before removal, installation or disassembly.
- Keep the disassembled parts in order and protect them from dust and dirt.
- Before removal, installation or disassembly, be sure to clarify the failure. Avoid unnecessary removal, installation, disassembly, and replacement.
- Be careful not to burn your hands, because each part in the vehicle is hot after running.
- Be sure to tighten fasteners including bolts and nuts to the specified torque.
- Place shop jacks or safety stands at the specified points.
- Before disconnecting electrical connectors of sensors or units, be sure to disconnect ground cable from battery.

SP(H6DO)-3

Vehicle-id:
SIE-id::C:Caution