

## TRANSMISSION GEAR OIL

MANUAL TRANSMISSION AND DIFFERENTIAL

### 2. Transmission Gear Oil

#### A: INSPECTION

- 1) Park vehicle on a level surface.
- 2) Turn ignition switch to OFF, and wait until the engine cools.
- 3) Remove oil level gauge and wipe it clean.
- 4) Reinsert the level gauge all the way. Be sure that the level gauge is correctly inserted and in the proper direction.
- 5) Pull out the oil level gauge again and check, if the oil level is between lower and upper levels. If it is below the lower level, check oil leakage and add oil through the oil level gauge hole to bring the level up to the position between lower and upper level.

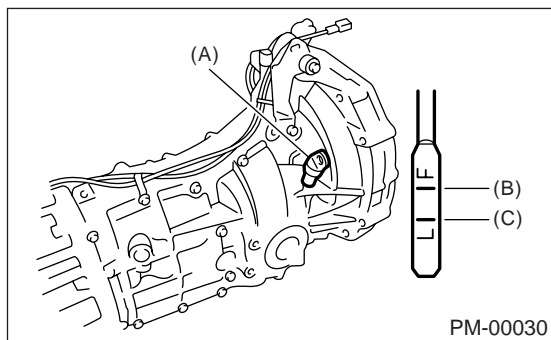

- (A) Oil level gauge  
(B) Upper level  
(C) Lower level

#### B: REPLACEMENT

- 1) Pull out oil level gauge.
- 2) Lift-up the vehicle.
- 3) Drain transmission gear oil completely.

#### CAUTION:

• **Directly after the engine has been running, the transmission gear oil is hot. Be careful not to burn yourself.**

• **Be careful not to splash transmission gear oil on exhaust pipe; it may cause smoke or fire. If transmission gear oil splashes to exhaust pipes, wipe clean them.**

- 4) Tighten transmission gear oil drain plug with new gasket.

#### Tightening torque:

**44 N·m (4.5 kgf·m, 32.5 ft·lb)**

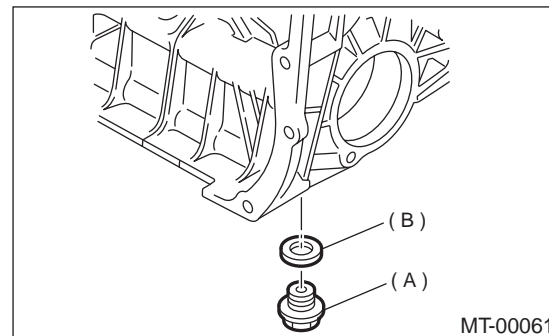

- (A) Drain plug  
(B) Gasket

- 5) Lower the vehicle.
- 6) Pour gear oil into the gauge hole.

#### Recommended gear oil:

**Use GL-5 (75W-90) or equivalent.**

#### Gear oil capacity:

**3.5 ℓ (3.7 US qt, 3.1 Imp qt)**

- 7) Check the level of the transmission gear oil. Check, if the oil is within the range of marks.

#### NOTE:

When inserting the level gauge into transmission gear, align the protrusion on the side of the top part of the level gauge with the notch in the gauge hole.

MT-25