

5. Spark Plug

A: REPLACEMENT

1. 2.5 L NON-TURBO MODEL

- 1) Remove the intake duct and intake chamber.
- 2) Remove the battery.
- 3) Disconnect the spark plug cord.
- 4) Remove the spark plug with a spark plug socket.

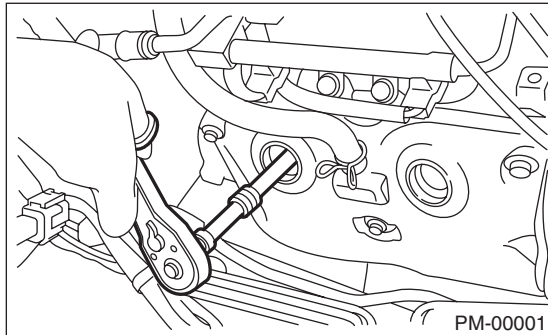

- 5) Tighten the new spark plug lightly with hand, and then secure with a spark plug socket to the specified torque.

Recommended spark plug:
NGK: FR5AP-11

Tightening torque:
21 N·m (2.1 kgf·m, 15.2 ft·lb)

NOTE:

- Be sure to place the gasket between the cylinder head and spark plug.
- If the torque wrench is not available, tighten the spark plug until gasket contacts cylinder head; then tighten further 1/4 to 1/2 turns.

2. 2.5 L TURBO AND 3.0 L MODEL

- 1) Remove the battery and battery carrier.
 - 2) Remove the air cleaner case.
 - 3) Detach the connector from ignition coil.
 - 4) Remove the ignition coil.
- 2.5 L turbo model

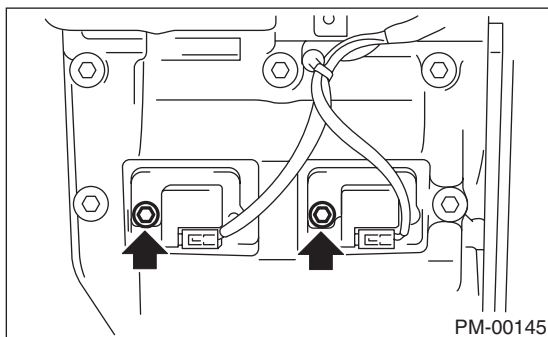

- 3.0 L model

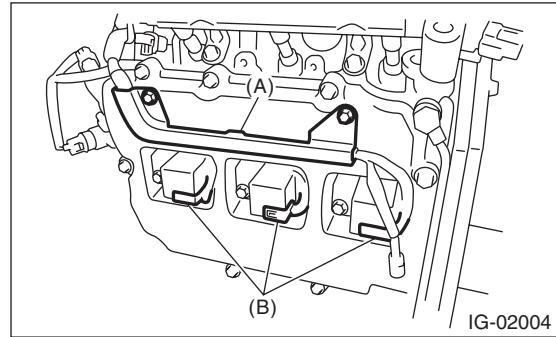

- (A) Bracket
(B) Connector

- 5) Remove the spark plug with a spark plug socket.

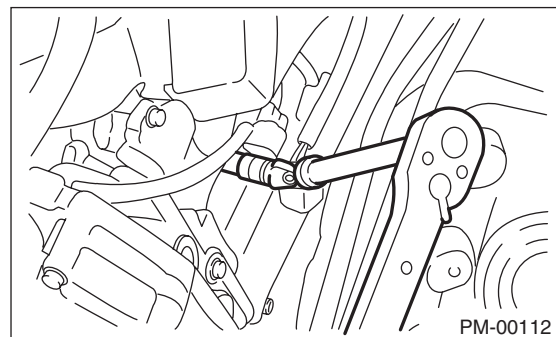

- 6) Tighten the new spark plug lightly with hand, and then secure with a spark plug socket to the specified torque.

Recommended spark plug:
NGK: ILFR6B

Tightening torque:
21 N·m (2.1 kgf·m, 15.2 ft·lb)

- 7) Tighten the ignition coil.

Tightening torque:
16 N·m (1.6 kgf·m, 11.7 ft·lb)

NOTE:

- Be sure to place the gasket between the cylinder head and spark plug.
- If the torque wrench is not available, tighten the spark plug until gasket contacts cylinder head; then tighten further 1/4 to 1/2 turns.