

7. Timing Belt

A: REPLACEMENT

1. 2.5 L NON-TURBO MODEL

- 1) Protect the radiator with cardboard and blanket.
- 2) Remove the V-belt covers.

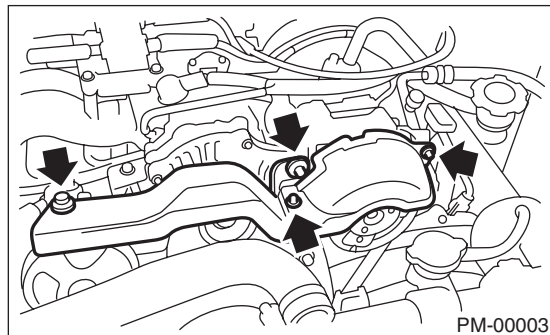

- 3) Remove the V-belts. <Ref. to ME(H4SO)-36, V-belt.>
- 4) Remove the A/C compressor V-belt tensioner.
- 5) Use the ST to lock the crankshaft, and remove the pulley bolt.

ST 499977100 CRANK PULLEY WRENCH

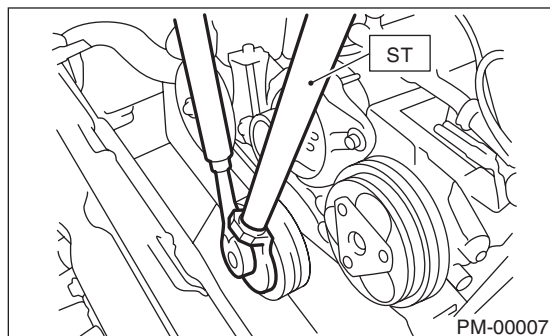

- 6) Remove the crank pulley.
- 7) Remove the belt cover (LH).
- 8) Remove the front timing belt cover.
- 9) Remove the timing belt guide. (MT model)

- 10) If the alignment mark (a) or arrow mark (which indicates rotation direction) on the timing belt has faded away, put new marks on the belt before removing as shown in procedures below.

(1) Use the ST to turn crankshaft. Align the mark (a) of sprocket to the cylinder block notch (b), and then ensure the right side cam sprocket mark (c), cam cap and cylinder head matching surface (d) or left side cam sprocket mark (e), timing belt cover notch (f) are properly adjusted.

ST 499987500 CRANKSHAFT SOCKET

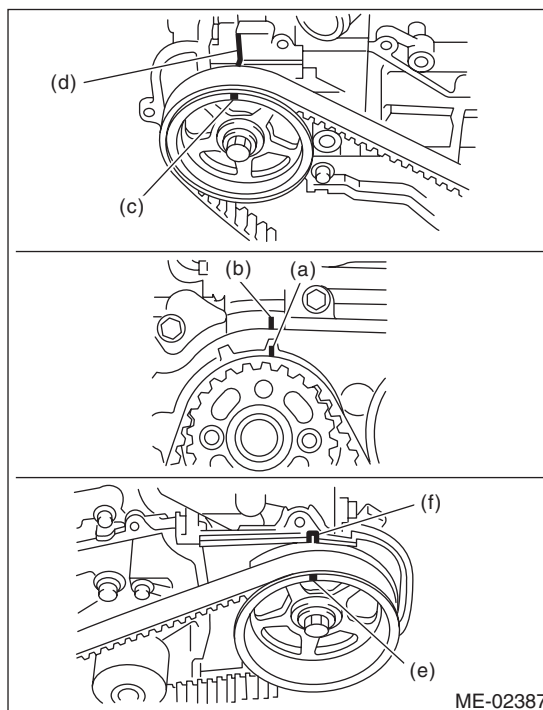
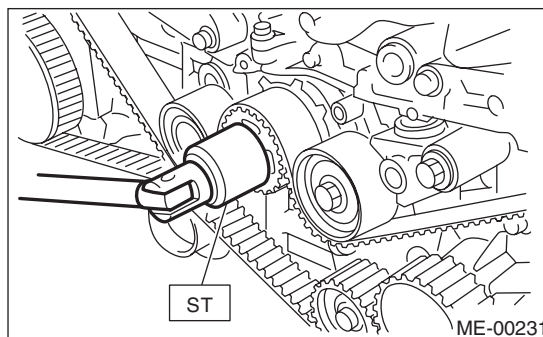

- 11) Remove the belt idler.

Timing Belt

PERIODIC MAINTENANCE SERVICES

12) Remove the belt idler (No. 2).

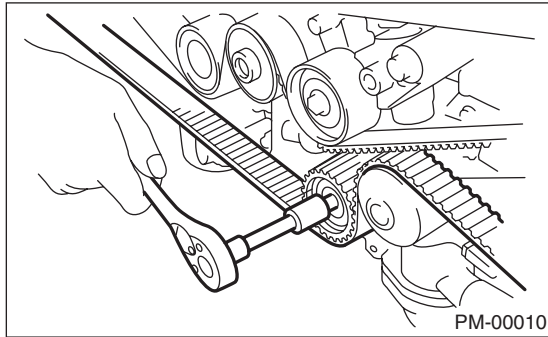

13) Remove the timing belt.

14) Remove the automatic belt tension adjuster assembly.

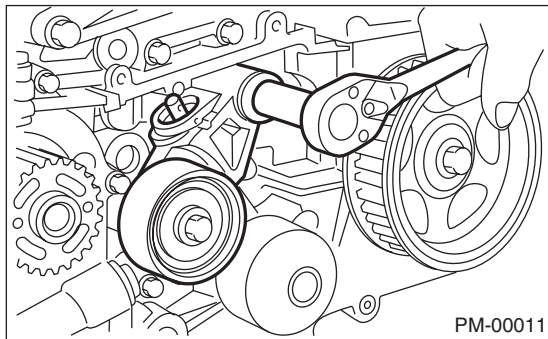

15) Install in the reverse order of removal. <Ref. to ME(H4SO)-41, INSTALLATION, Timing Belt.>

2. 2.5 L TURBO MODEL

1) Protect the radiator with cardboard and blanket.
2) Remove the V-belts. <Ref. to ME(H4DOTC)-36, V-belt.>

3) Remove the A/C compressor V-belt tensioner.

4) Remove the pulley bolt. Using the ST, lock the crankshaft.

ST 499977100 CRANK PULLEY WRENCH

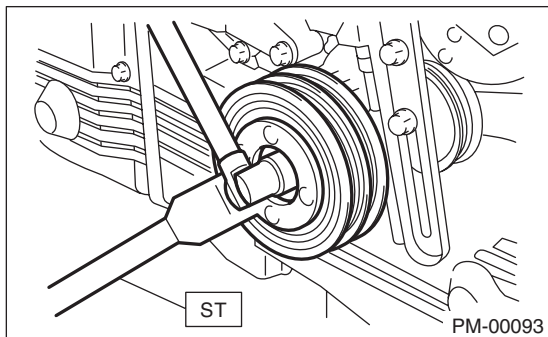

5) Remove the crank pulley.

6) Remove the belt cover (LH).

7) Remove the belt cover (RH).

8) Remove the front belt cover.

9) Remove the timing belt guide.

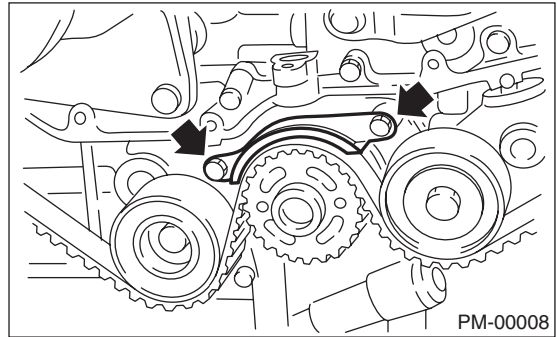

MT model

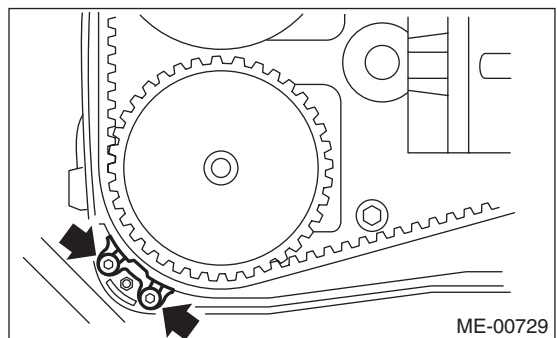
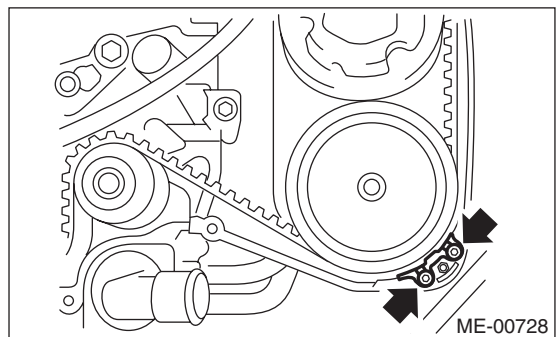
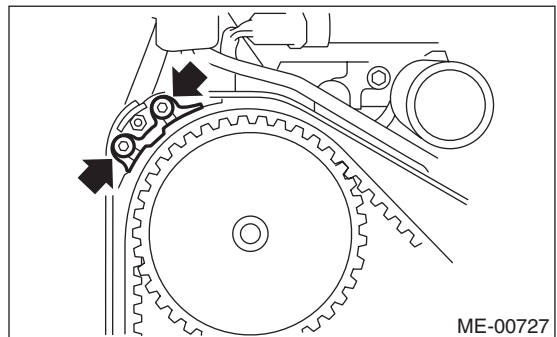

10) Turn the crankshaft and align the alignment marks on crankshaft, and left and right cam sprockets with notches of belt cover and cylinder block. Use the ST to turn crankshaft.

ST 499987500 CRANKSHAFT SOCKET

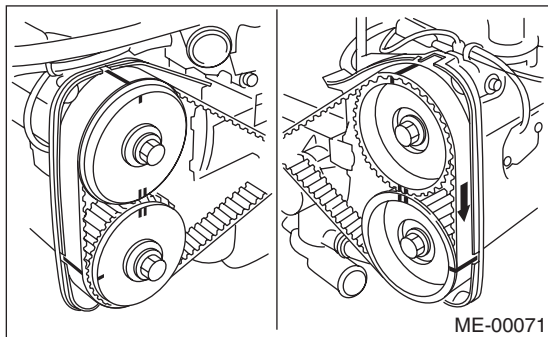
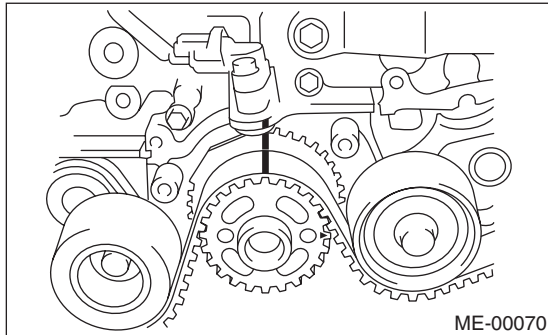

11) Remove the belt idler.

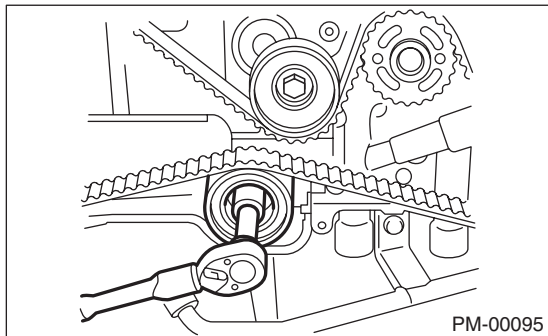

12) Remove the timing belt.

13) Remove the automatic belt tension adjuster assembly.

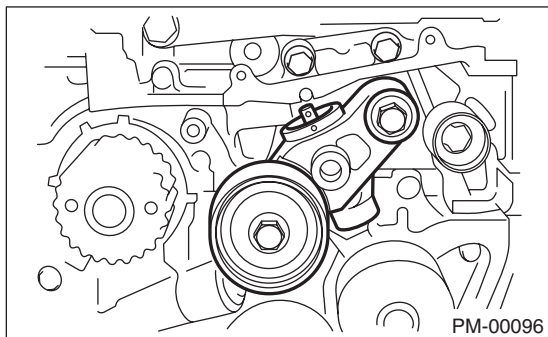

14) Install in the reverse order of removal. <Ref. to ME(H4DOTC)-42, Timing Belt.>

CAUTION:

When installing the timing belt, be sure to align all alignment marks on the belt with corresponding marks on the sprockets. If incorrectly installed, interference between pistons and valves may occur.

B: INSPECTION

1. 2.5 L NON-TURBO MODEL

- 1) Remove the front timing belt cover and timing belt cover (LH).
- 2) While cranking engine at least four rotations, check the timing belt back surface for cracks or damage. Replace the faulty timing belt as needed.
- 3) Measure the timing belt width W. If it is less than 27 mm (1.06 in), check the idlers, tensioner, water pump pulley and cam sprocket to determine idler alignment (squareness). Replace the worn timing belt.

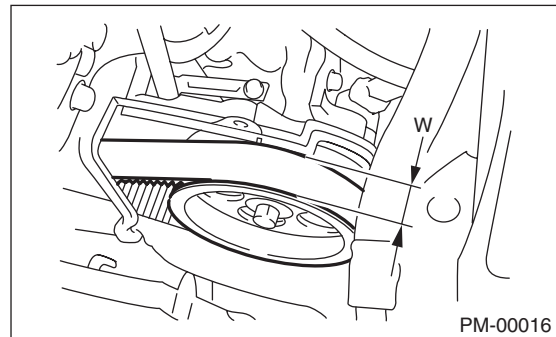

4) Install the front timing belt cover and timing belt cover (LH).

2. 2.5 L TURBO MODEL

- 1) Remove the timing belt cover (LH).
- 2) While cranking engine at least four rotations, check the timing belt back surface for cracks or damage. Replace the faulty timing belt as needed.
- 3) Measure the timing belt width W. If it is less than 29 mm (1.14 in), check the idlers, tensioner, water pump pulley and cam sprocket to determine idler alignment (squareness). Replace the worn timing belt.
- 4) Install the timing belt cover (LH).

