

Front Exhaust Pipe

EXHAUST

2. Front Exhaust Pipe

A: REMOVAL

1) Disconnect the ground cable from battery.

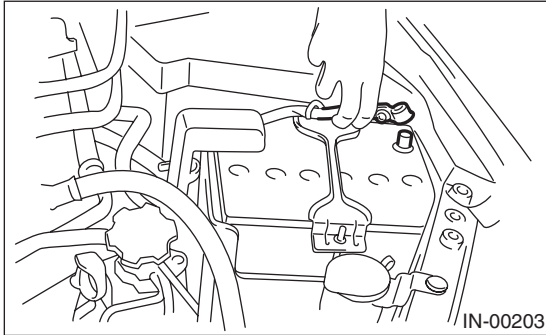

2) Lift-up the vehicle.

3) Remove the under cover.

4) Remove the front oxygen (A/F) sensor connector (A) and rear oxygen sensor connector (B).

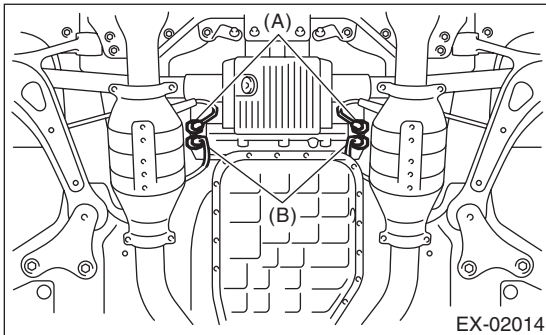

5) Separate the front exhaust pipe from the rear exhaust pipe.

CAUTION:

Be careful, exhaust pipe is hot.

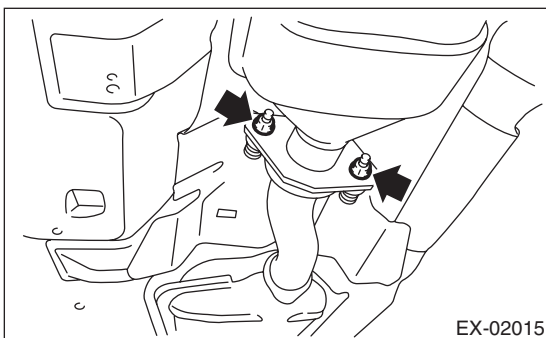

6) Remove the nuts which hold front exhaust pipe onto cylinder heads.

CAUTION:

Be careful not to pull down the front exhaust pipe assembly.

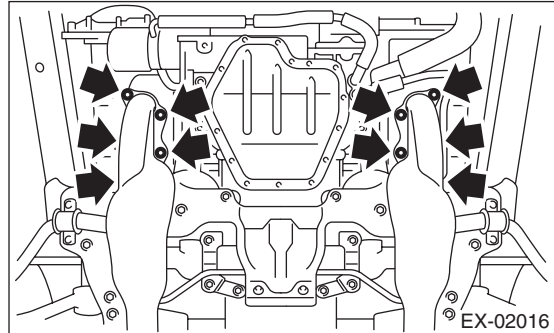

7) Remove the bolts which hold front exhaust pipe assembly to hanger bracket.

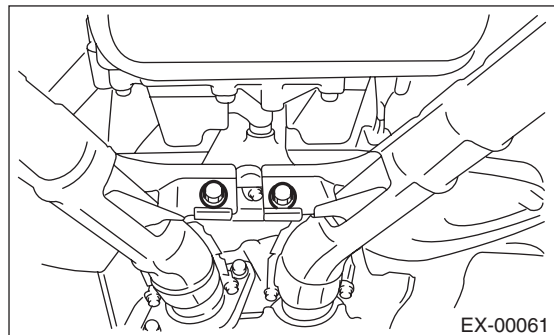

8) Remove the front exhaust pipe assembly from vehicle.

CAUTION:

- Be careful not to let the front exhaust pipe assembly fall off when removing, since it is very heavy.

- After removing the front exhaust pipe assembly, do not apply excessive pulling force on the rear exhaust pipe.

9) Separate the front exhaust pipe (RH) from front exhaust pipe assembly.

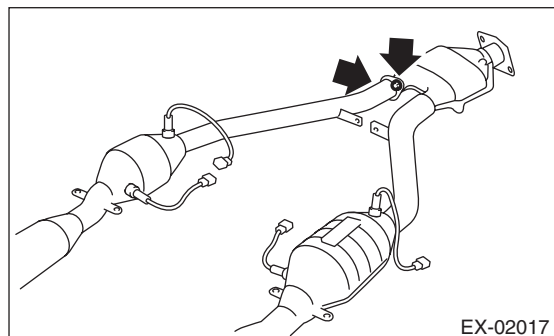

10) Remove the front oxygen (A/F) sensor and rear oxygen sensor. <Ref. to FU(H6DO)-29, REMOVAL, Front Oxygen (A/F) Sensor.> <Ref. to FU(H6DO)-31, REMOVAL, Rear Oxygen Sensor.>

B: INSTALLATION

1) Install the front oxygen (A/F) sensor and rear oxygen sensor. <Ref. to FU(H6DO)-30, INSTALLATION, Front Oxygen (A/F) Sensor.> <Ref. to FU(H6DO)-32, INSTALLATION, Rear Oxygen Sensor.>

2) Install the front exhaust pipe (RH) to front exhaust pipe assembly.

NOTE:

Use a new gasket.

Tightening torque:

30 N·m (3.1 kgf·m, 22.4 ft·lb)

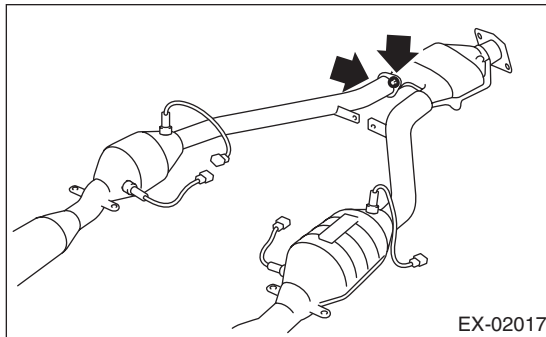

3) Install the front exhaust pipe assembly to vehicle.

4) Temporarily tighten the bolts which hold front exhaust pipe assembly to hanger bracket.

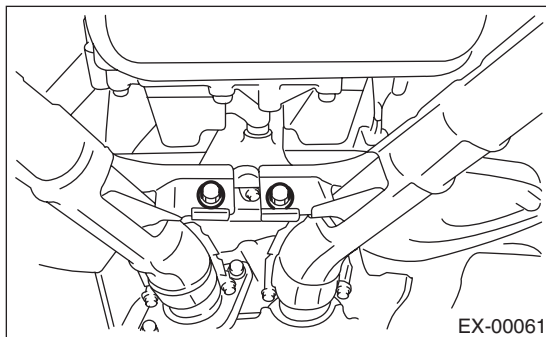

5) Install the nuts to cylinder head which hold front exhaust pipe.

Tightening torque:

70 N·m (7.1 kgf·m, 51.6 ft·lb)

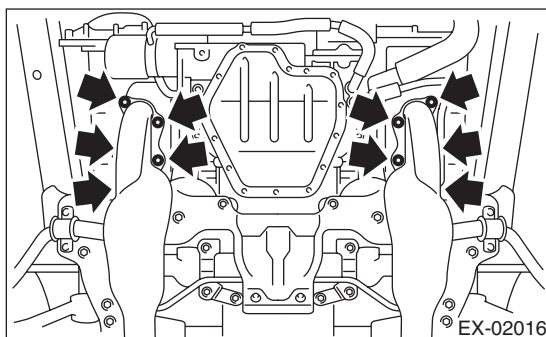

6) Install the under cover.

7) Tighten the bolts which install front exhaust pipe to rear exhaust pipe.

Tightening torque:

18 N·m (1.8 kgf·m, 13.0 ft·lb)



8) Tighten the bolts which hold front exhaust pipe assembly to hanger bracket.

Tightening torque:

35 N·m (3.6 kgf·m, 26.0 ft·lb)

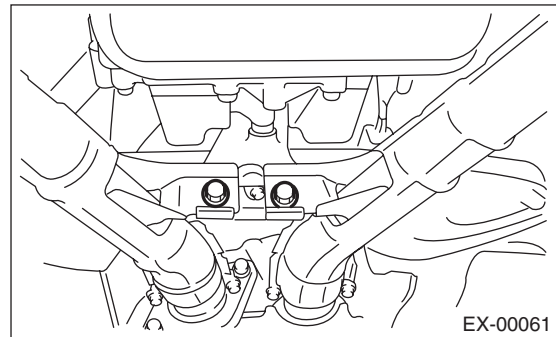

9) Connect the front oxygen (A/F) sensor connector (A) and rear oxygen sensor connector (B).

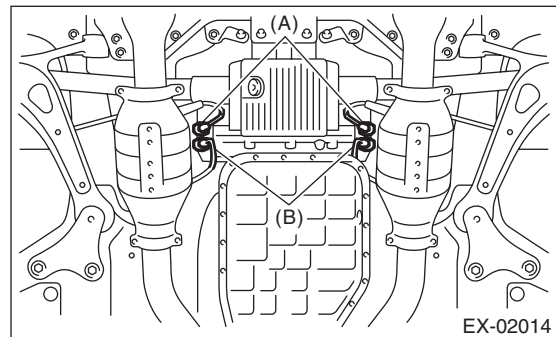

10) Lower the vehicle.

Front Exhaust Pipe

EXHAUST

11) Connect the battery ground cable to the battery.

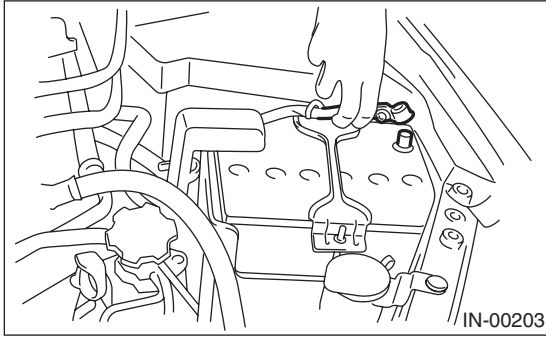

C: INSPECTION

- 1) Check the connections and welds for exhaust leaks.
- 2) Make sure there are no holes or rusting.