

14. Front Oxygen (A/F) Sensor

A: REMOVAL

- 1) Set the vehicle on a lift.
- 2) Disconnect the ground cable from battery.

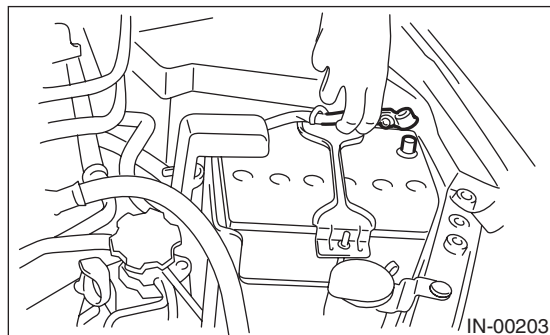

- 3) Lift-up the vehicle.
- 4) Disconnect the connector of front oxygen (A/F) sensor.

- LH side

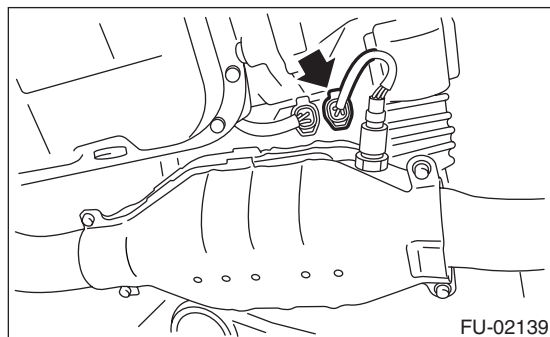

- RH side

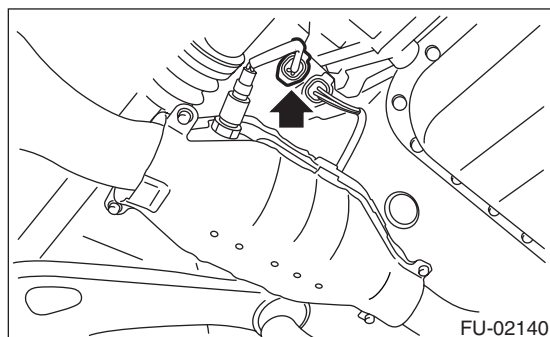

- 5) Remove the front oxygen (A/F) sensor.

NOTE:

If it is hard to remove the oxygen (A/F) sensor, apply spray type lubricant and leave it for one minute or more.

CAUTION:

When removing the front oxygen (A/F) sensor, wait until exhaust pipe cools, otherwise it will damage the exhaust pipe.

- LH side

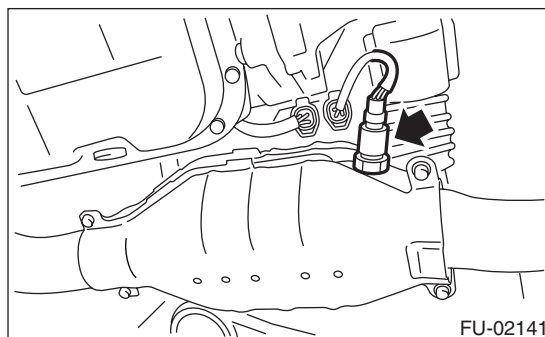

- RH side

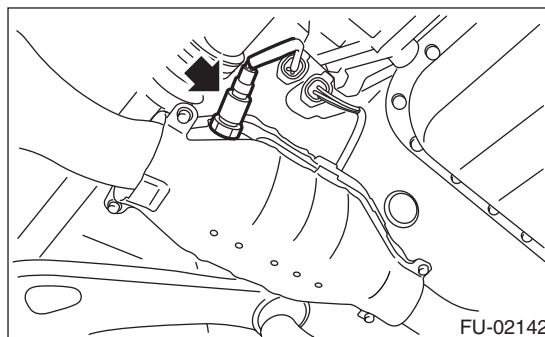

Front Oxygen (A/F) Sensor

FUEL INJECTION (FUEL SYSTEMS)

B: INSTALLATION

1) Before installing front oxygen (A/F) sensor, apply anti-seize compound only to the threaded portion of front oxygen (A/F) sensor to make the next removal easier.

Anti-seize compound:

NEVER-SEEZ NS-165 or the equivalent

CAUTION:

Never apply anti-seize compound to the protector of front oxygen (A/F) sensor.

2) Install the front oxygen (A/F) sensor.

Tightening torque:

21 N·m (2.1 kgf-m, 15.2 ft-lb)

• LH side

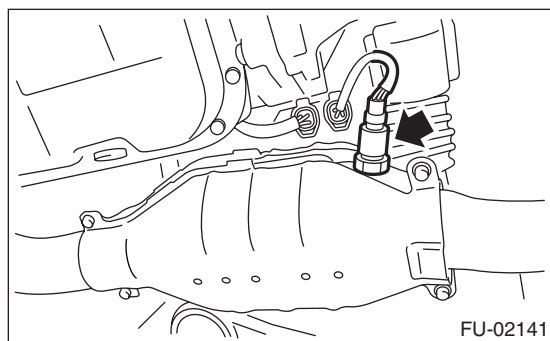

• RH side

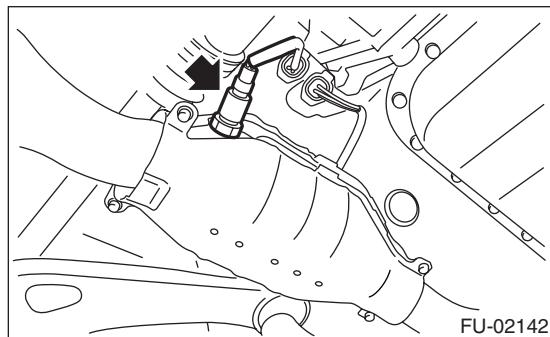

3) Connect the connector of front oxygen (A/F) sensor.

• LH side

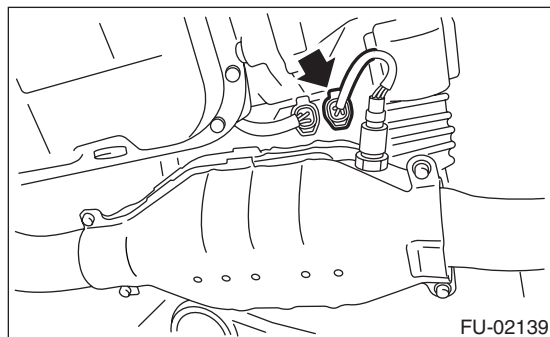

• RH side

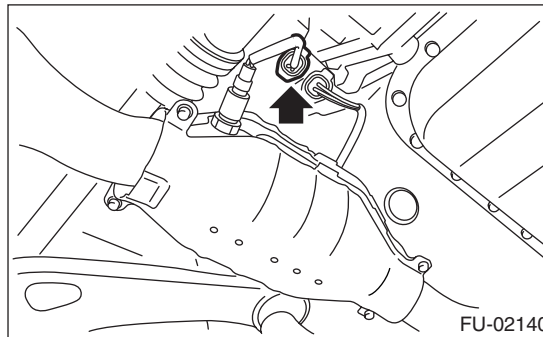

4) Lower the vehicle.

5) Connect the battery ground cable to the battery.

