

Drive Plate

AUTOMATIC TRANSMISSION

25. Drive Plate

A: REMOVAL

1) Remove the transmission assembly from the vehicle. <Ref. to 5AT-34, REMOVAL, Automatic Transmission Assembly.>

2) Use the ST to lock the crankshaft, and remove the drive plate.

ST 498497100 CRANKSHAFT STOPPER

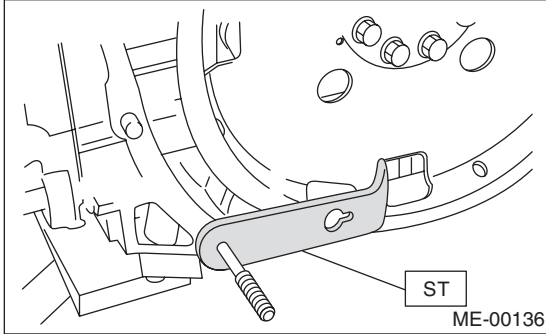

B: INSTALLATION

1) Temporarily tighten the drive plate.

2) Using the ST, lock the crankshaft.

ST 498497100 CRANKSHAFT STOPPER

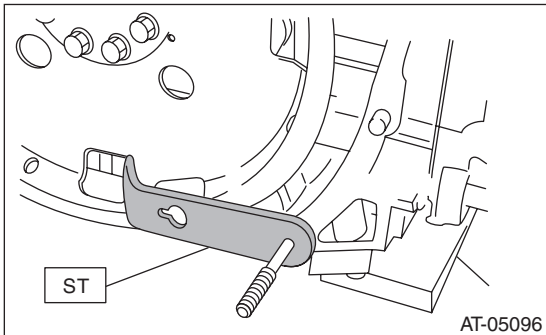

3) Tighten the drive plate in three stages. (turbo model)

(1) Tighten the drive plate mounting bolt.

Tightening torque:

10 N·m (1.0 kgf-m, 7.4 ft-lb)

(2) Additionally tighten the drive plate mounting bolts.

Tightening torque:

40 N·m (4.1 kgf-m, 29.5 ft-lb)

(3) While checking the tightening angle with the ST, further tighten the drive plate mounting bolts.

Tightening angle:

30°±5°

ST 18854AA000 ANGLE GAUGE

4) Tighten the drive plate to the specified torque. (non-turbo model)

NOTE:

Tighten the drive plate mounting bolts gradually. Each bolt should be tightened in a crisscross order.

Tightening torque:

81 N·m (8.3 kgf-m, 60 ft-lb)

5) Install the transmission assembly to the vehicle. <Ref. to 5AT-37, INSTALLATION, Automatic Transmission Assembly.>