

11. Clutch Switch

A: REMOVAL

- 1) Disconnect the ground cable from the battery.
- 2) Remove the instrument panel lower cover.
- 3) Disconnect the connector from clutch switch.
- 4) Remove the clutch switches.

B: INSTALLATION

1. CLUTCH SWITCH (WITH CRUISE CONTROL)

- 1) Install so that there is a gap of 0 mm (0 in) of the clutch switch and clutch pedal stopper.

Tightening torque:

8 N·m (0.8 kgf·m, 5.8 ft·lb)

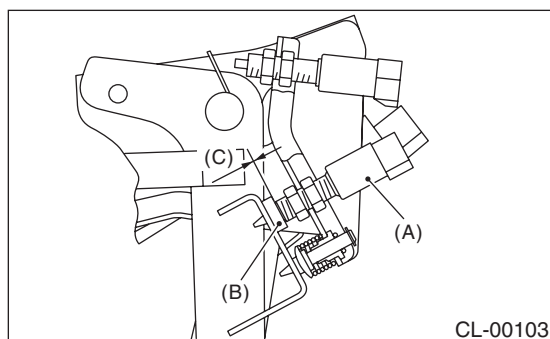

- (A) Clutch switch
- (B) Stopper
- (C) 0 mm (0 in)

- 2) Measure the stroke of the clutch pedal.

Clutch pedal standard full stroke: A

Non-turbo model

130 — 135 mm (5.12 — 5.31 in)

Turbo model

135 — 140 mm (5.31 — 5.51 in)

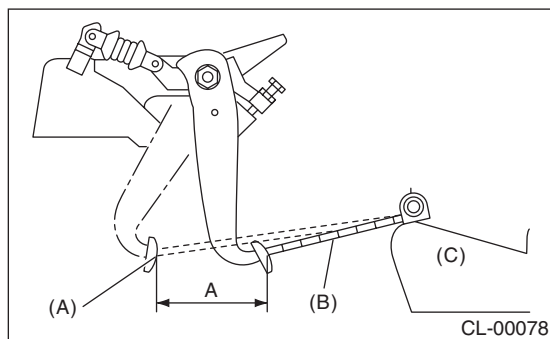

- (A) Clutch pedal (Full stroke condition)
- (B) Scale
- (C) Seat

- 3) If the clutch pedal stroke is out of specification, adjust the stroke. <Ref. to CL-24, ADJUSTMENT, Clutch Pedal.>

- 4) Connect the clutch switch connector.

2. CLUTCH SWITCH (CLUTCH START)

- 1) Fully depress the clutch and hold it.
- 2) Install the clutch pedal plate and clutch pedal so that the gap between them is 2 — 2.5 mm (0.08 — 0.10 in), and then tighten the lock nut.

Tightening torque:

8 N·m (0.8 kgf·m, 5.8 ft·lb)

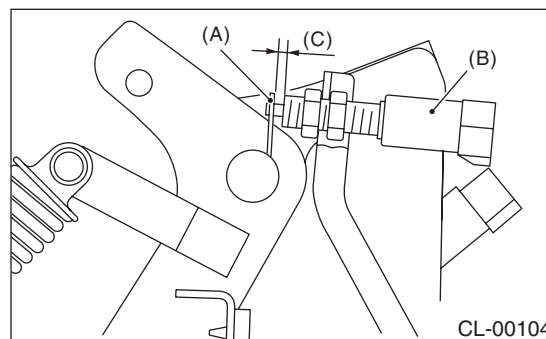

- (A) Plate
- (B) Clutch pedal
- (C) 2 — 2.5 mm (0.08 — 0.10 in)

- 3) Connect the clutch switch connector.
- 4) Make sure that engine does not start with clutch pedal not depressed.
- 5) Make sure that engine starts with clutch pedal fully depressed.

Clutch Switch

CLUTCH SYSTEM

C: INSPECTION

1) Make sure that engine does not start with clutch pedal not depressed. If the engine starts, adjust the clutch switch and inspect the starter interlock circuit.

2) Make sure that engine starts with clutch pedal fully depressed. If the engine does not start, adjust the clutch switch and inspect the starter interlock circuit.

3) Check the clutch switch for continuity. If the resistance is not at the standard value, replace the switch.

(1) Disconnect the clutch switch connector.

(2) Measure the resistance between terminal 1 and 2 of the switch.

Condition	Terminal No.	Specified resistance
When clutch pedal is depressed	1 and 2	Less than 1 Ω
When the clutch pedal is not depressed.	1 and 2	1 M Ω or more

Clutch switch (Clutch start)

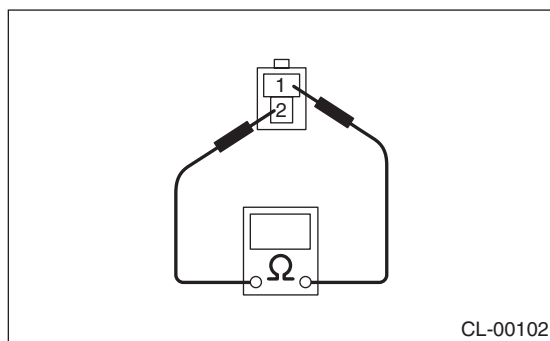

Clutch switch (Cruise control)

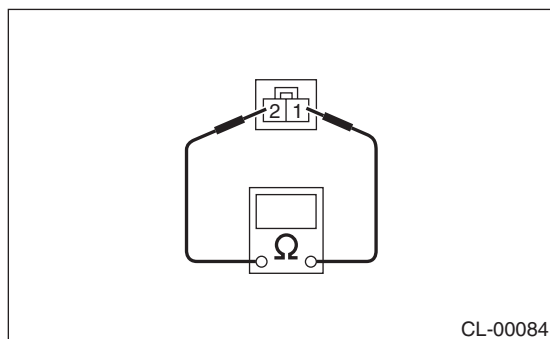

D: ADJUSTMENT

1) Loosen the lock nut of clutch switch (clutch start).

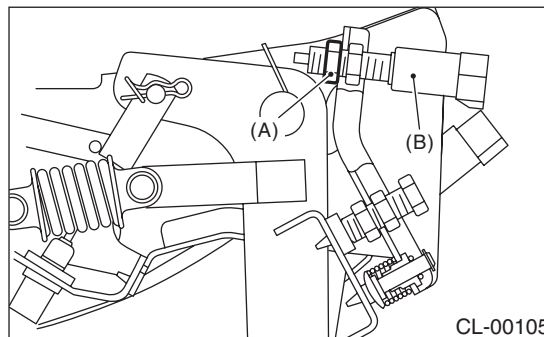

(A) Lock nut

(B) Clutch switch (Clutch start)

2) Fully depress the clutch and hold it.

3) Adjust the gap of the clutch pedal plate and the clutch switch to be 2 — 2.5 mm (0.08 — 0.10 in).

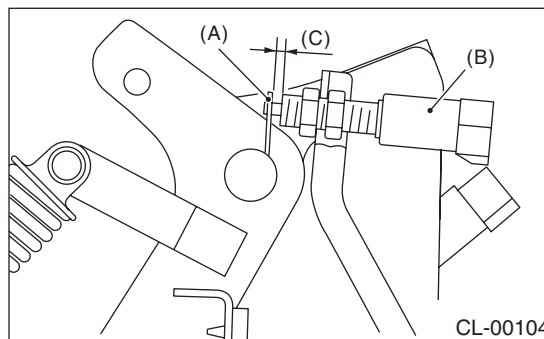

(A) Plate

(B) Clutch switch (Clutch start)

(C) 2 — 2.5 mm (0.08 — 0.10 in)

4) Tighten the lock nut.

Tightening torque:

8 N·m (0.8 kgf·m, 5.8 ft·lb)