

3. Select Lever

A: REMOVAL

- 1) Set the vehicle on a lift.
- 2) Disconnect the ground cable from battery.
- 3) Shift the select lever to "N" range.
- 4) Lift up the vehicle.
- 5) Remove the rear exhaust pipe and muffler.
 - SOHC model
<Ref. to EX(H4SO)-8, REMOVAL, Rear Exhaust Pipe.> <Ref. to EX(H4SO)-10, REMOVAL, Muffler.>
 - DOHC turbo model
<Ref. to EX(H4DOTC)-12, REMOVAL, Rear Exhaust Pipe.> <Ref. to EX(H4DOTC)-13, REMOVAL, Muffler.>
 - DOHC 3.0 L model
<Ref. to EX(H6DO)-7, REMOVAL, Rear Exhaust Pipe.> <Ref. to EX(H6DO)-9, REMOVAL, Muffler.>
- 6) Remove the heat shield cover.

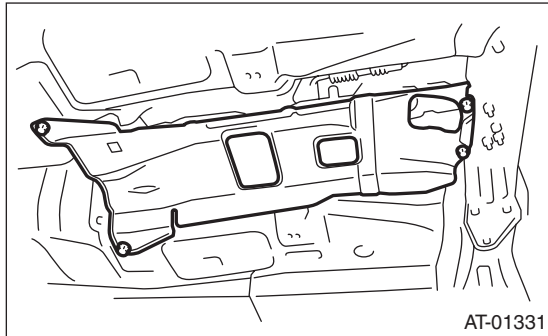

- 7) Remove the cable from arm assembly.

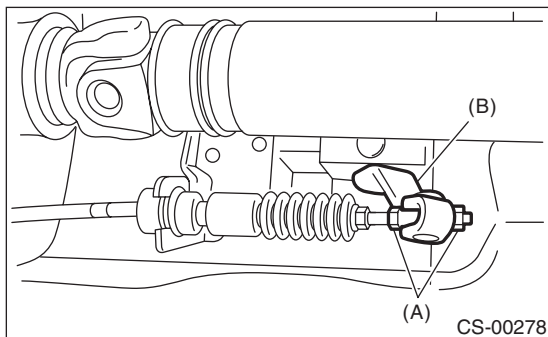

- (A) Adjusting nut
- (B) Arm ASSY

- 8) Raise the pawl of clamp to remove the cable.

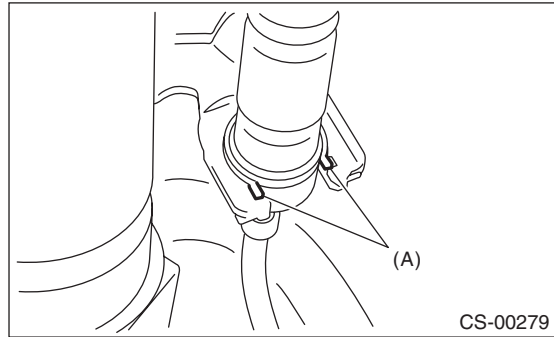

- (A) Claw

- 9) Lower the vehicle.
- 10) Remove the console box. <Ref. to EI-52, REMOVAL, Console Box.>
- 11) Remove the center console. <Ref. to EI-53, REMOVAL, Center Console.>
- 12) Remove the harness clips from the bracket.

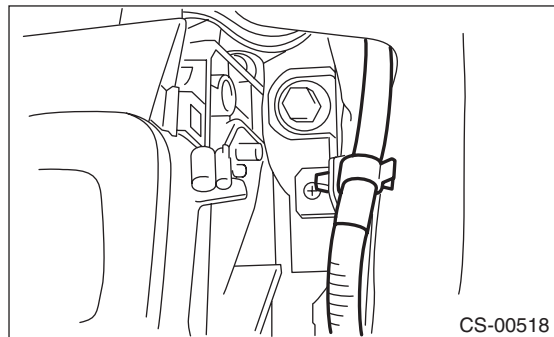

- 13) Disconnect the connectors, and then remove the four bolts to take out the select lever assembly from vehicle body.

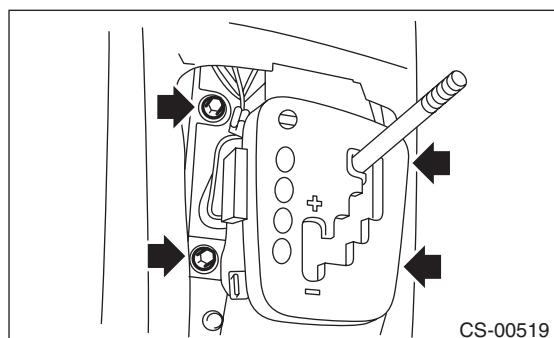

Select Lever

CONTROL SYSTEMS

B: INSTALLATION

- 1) Set the select lever to vehicle body.
- 2) Tighten the four bolts to install the select lever to vehicle body, and then connect the connector.
 - (1) Temporarily tighten the bolt A.
 - (2) Tighten the bolt B.
 - (3) Tighten the bolt A.
 - (4) Tighten the bolts C and D.

Tightening torque:

18 N·m (1.8 kgf-m, 13.3 ft-lb)

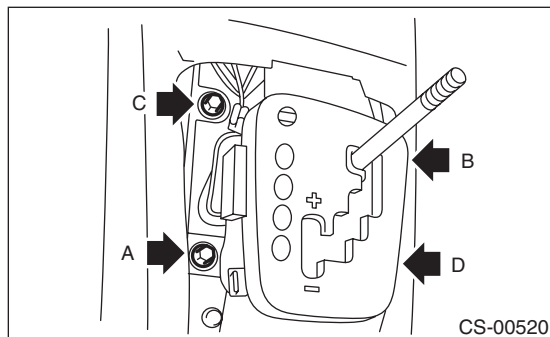

- 3) Install the harness clips to the bracket.

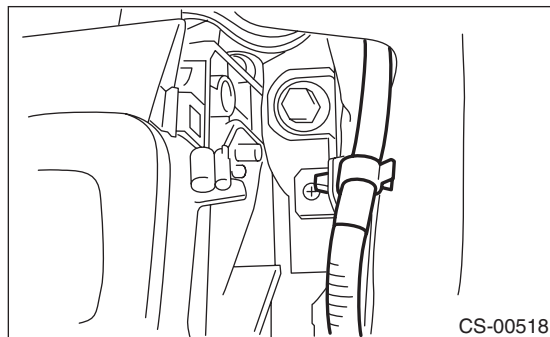

- 4) Install the center console. <Ref. to EI-54, INSTALLATION, Center Console.>
- 5) Install the console box. <Ref. to EI-52, INSTALLATION, Console Box.>
- 6) Shift the select lever to "N" range.
- 7) Lift up the vehicle.
- 8) Shift the range select lever to the "N" range.
- 9) Secure the cable to the bracket. <Ref. to CS-25, INSTALLATION, Select Cable.>
- 10) Adjust the select cable position. <Ref. to CS-27, ADJUSTMENT, Select Cable.>
- 11) After the completion of adjustment, confirm that the select lever operates properly at all range positions.
- 12) Install the heat shield cover.

- 13) Install the rear exhaust pipe and muffler.

- SOHC model
<Ref. to EX(H4SO)-8, INSTALLATION, Rear Exhaust Pipe.> <Ref. to EX(H4SO)-10, INSTALLATION, Muffler.>
- DOHC turbo model
<Ref. to EX(H4DOTC)-12, INSTALLATION, Rear Exhaust Pipe.> <Ref. to EX(H4DOTC)-13, INSTALLATION, Muffler.>
- DOHC 3.0 L model
<Ref. to EX(H6DO)-7, INSTALLATION, Rear Exhaust Pipe.> <Ref. to EX(H6DO)-9, INSTALLATION, Muffler.>

- 14) Inspect the following items. When a malfunction is found in the inspection, adjust the select cable and inhibitor switch.

NOTE:

Inhibitor switch for 5AT model is not adjustable. <Ref. to CS-27, ADJUSTMENT, Select Cable.> <Ref. to 4AT-46, ADJUSTMENT, Inhibitor Switch.>

- (1) Engine starts when the select lever is in "P" and "N" range, but not in other ranges.
- (2) Back-up light illuminates when the select lever is in the "R" range, but not in other ranges.
- (3) Select lever and indicator positions are matched.

C: DISASSEMBLY

- 1) Shift the select lever to "N" range.
- 2) Remove the indicator light.

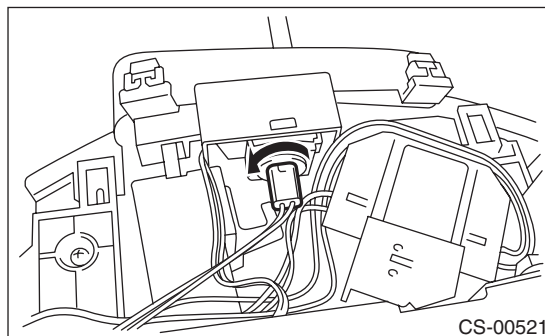

- 3) Remove the grip.
- 4) Remove the indicator assembly.

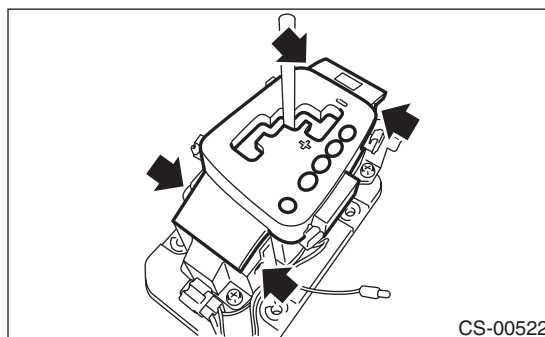

5) Remove the blind.

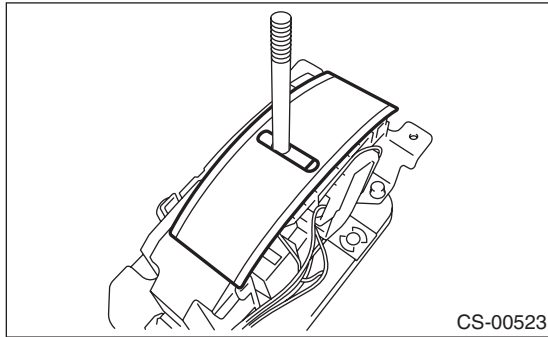

6) Shift the select lever to the N range, and then remove the detent spring.

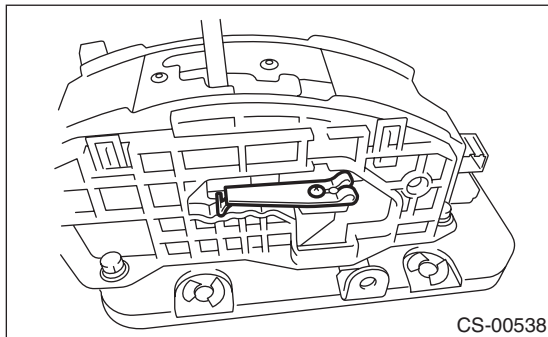

7) Remove the bolt, and separate the guide plate upper from plate lower.

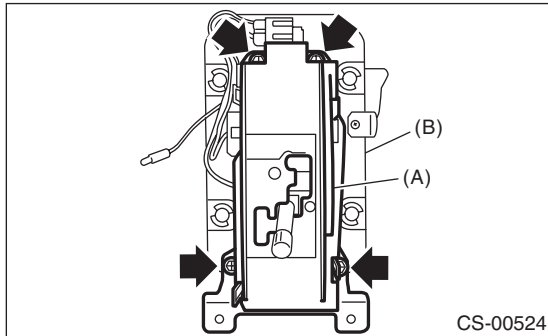

- (A) Guide plate upper
- (B) Plate lower

8) Remove the connector from the guide plate upper.

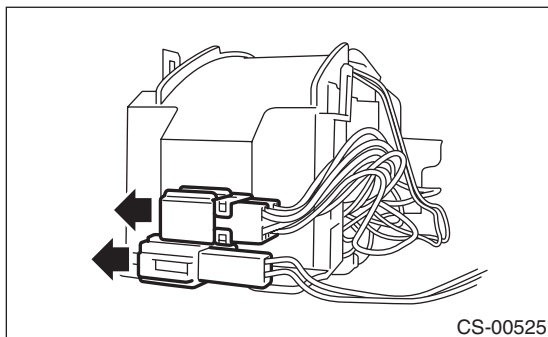

9) Remove the sheet, and remove the shift lock solenoid assembly.

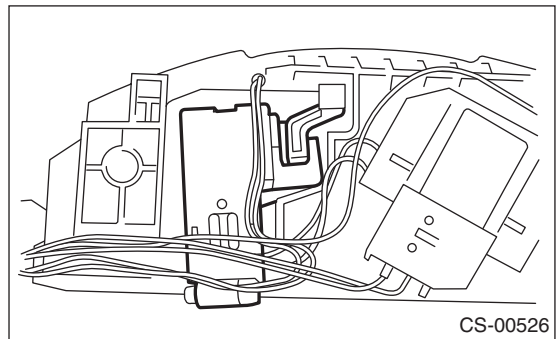

10) Remove the switch assembly.

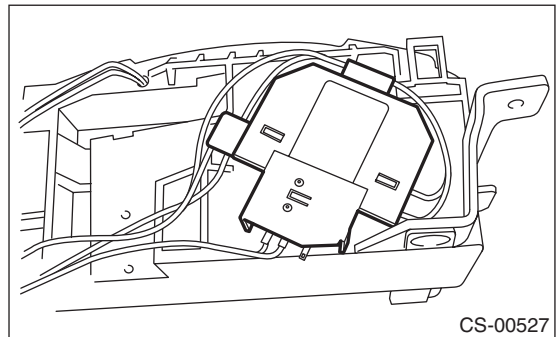

11) Remove the check plate.

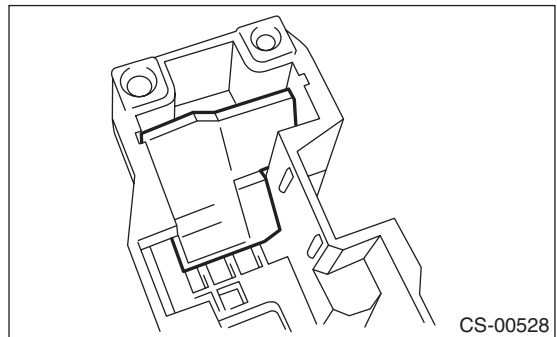

12) Raise the claw of connector.

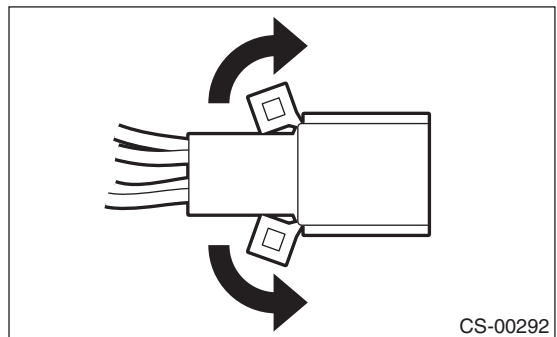

Select Lever

CONTROL SYSTEMS

13) Disconnect the terminals of the SPORT mode switch and shift lock solenoid assembly from the connector, using a flat-tip screwdriver with a thin tip.

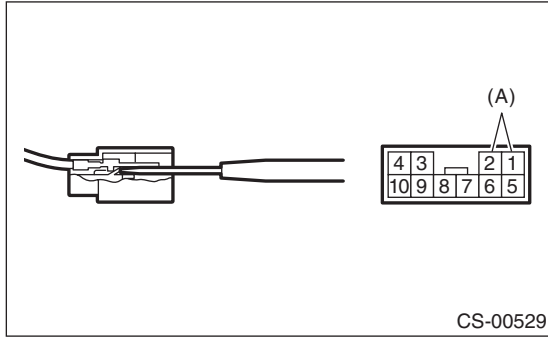

(A) "P" range switch

14) Remove the cable bracket.

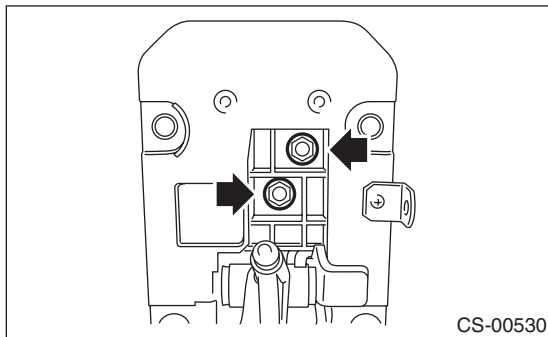

15) Remove the cover.

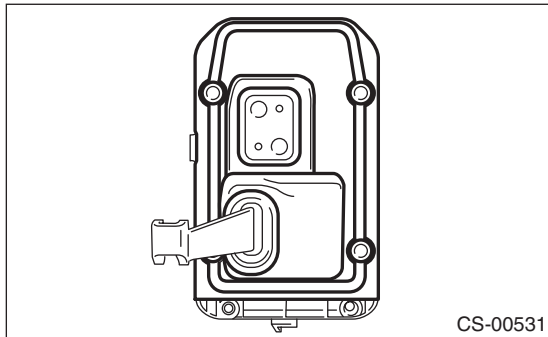

16) Remove the select lever assembly.

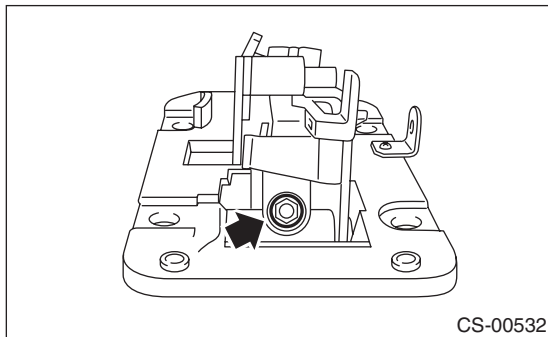

17) Remove the clamp, and remove the arm assembly and bushing plate.

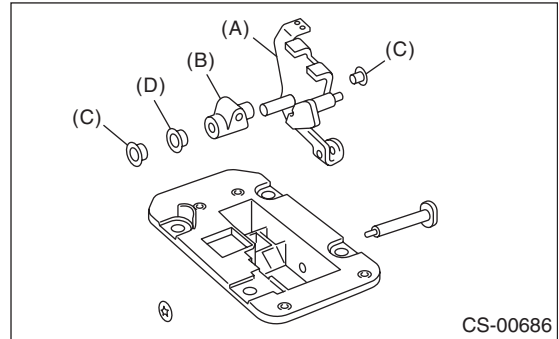

- (A) Arm ASSY
- (B) Bushing plate
- (C) Bushing A
- (D) Bushing B

D: ASSEMBLY

- 1) Clean all the parts before assembly.
- 2) Apply grease [Multemp AC-D or equivalent] to each part. <Ref. to CS-2, AT SELECT LEVER, COMPONENT, General Description.>
- 3) Assemble in the reverse order of disassembly.

NOTE:

- Refer to "COMPONENT" for each tightening torque. <Ref. to CS-2, AT SELECT LEVER, COMPONENT, General Description.>
- Connect the switch terminal to the connector.

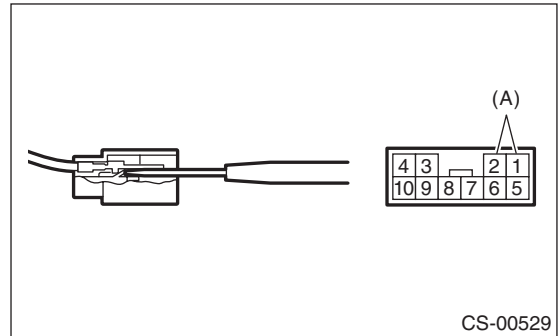

(A) "P" range switch

4) After completing installation, shift the select lever from "P" range to "D" range, then check whether the indicator and select lever matches, whether the pointer and position mark matches and what the operating force is.

E: INSPECTION

- 1) Inspect the removed parts by comparing with new parts for deformation, damage and wear. Repair or replace if defective.
- 2) Confirm the select lever operating condition before assembly. Normal if it operates smoothly.