

Transmission Gear Oil

MANUAL TRANSMISSION AND DIFFERENTIAL

2. Transmission Gear Oil

A: INSPECTION

- 1) Park the vehicle on a level surface.
- 2) Turn the ignition switch to OFF, and wait until the engine cools.
- 3) Remove the oil level gauge and wipe it clean.
- 4) Reinsert the level gauge all the way. Be sure that the level gauge is correctly inserted in the proper direction.
- 5) Pull out the oil level gauge again, and check the oil level. If it is below the lower level, add oil through the oil level gauge hole to bring the level up to the upper level.

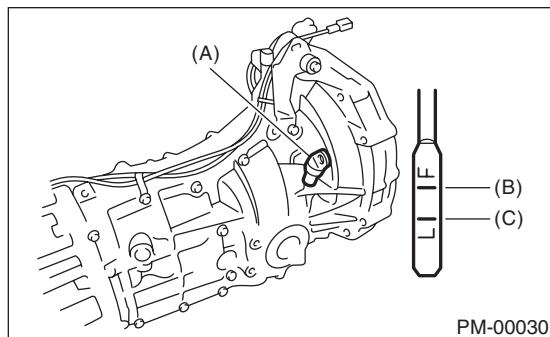

- (A) Oil level gauge
- (B) Upper level
- (C) Lower level

B: REPLACEMENT

- 1) Pull out the oil level gauge.
- 2) Lift-up the vehicle.
- 3) Drain transmission gear oil completely.

CAUTION:

Be careful not to burn yourself, because transmission gear oil becomes extremely hot after running.

NOTE:

- Tighten the drain plug of the transmission gear oil after draining the transmission gear oil.
- Use a new gasket.

Tightening torque:

44 N·m (4.5 kgf-m, 33 ft-lb) (Aluminum gasket)

70 N·m (7.1 kgf-m, 51 ft-lb) (Copper gasket)

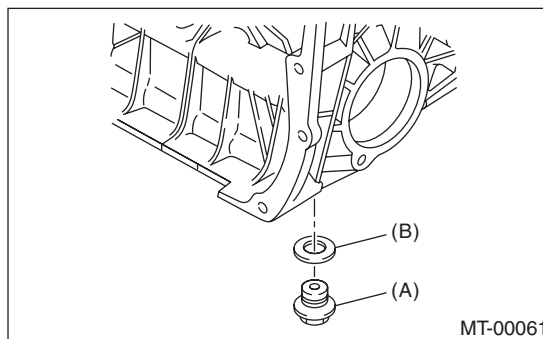

- (A) Drain plug
- (B) Gasket

- 4) Lower the vehicle.
- 5) Pour gear oil through the gauge hole.

Recommended gear oil:

GL-5 (75W-90) or equivalent

Gear oil capacity:

3.5 ℓ (3.7 US qt, 3.1 Imp qt)

- 6) Check the level of the transmission gear oil.

CAUTION:

The level should be within the specified range marked on the gauge.