

## 5. Upper Link

### A: REMOVAL

- 1) Lift up the vehicle, and then remove the rear wheels.
- 2) Support the rear arm horizontally using a transmission jack.

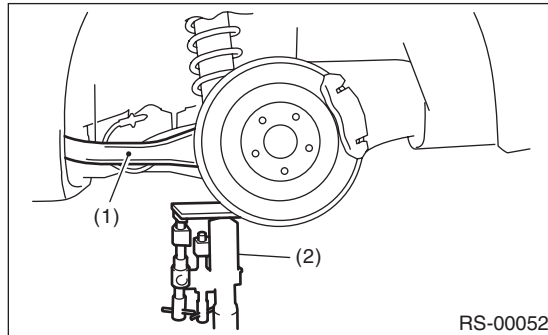

- (1) Rear arm
- (2) Transmission jack

- 3) Remove the bolt which secures the upper link to sub frame.

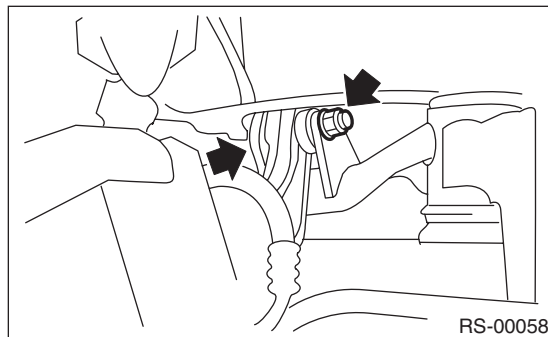

- 4) Remove the bolts which secure the upper link to the rear arm, and then remove the upper link.

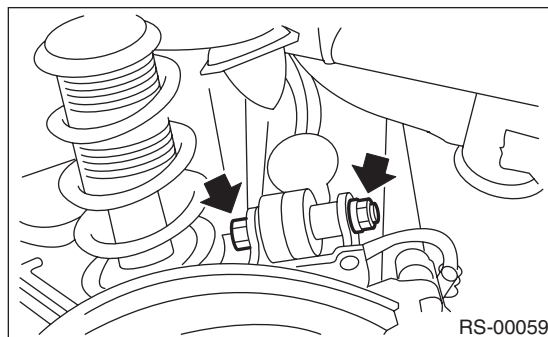

### B: INSTALLATION

- 1) Support the rear arm horizontally using a transmission jack.
- 2) Using new self-locking nuts, install the upper link.

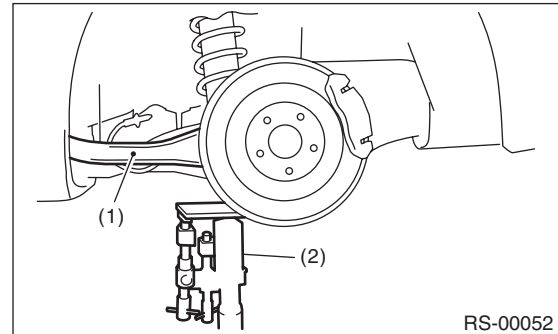

- (1) Rear arm
- (2) Transmission jack

#### NOTE:

Inspect the wheel alignment and adjust it if necessary.

#### Tightening torque:

*Upper link-to-Sub frame*

**120 N·m (12.2 kgf-m, 89 ft-lb)**

*Upper link-to-Rear arm*

**120 N·m (12.2 kgf-m, 89 ft-lb)**

### C: DISASSEMBLY

Using the ST, press the bushing out.

ST 20099AE010 INSTALLER & REMOVER

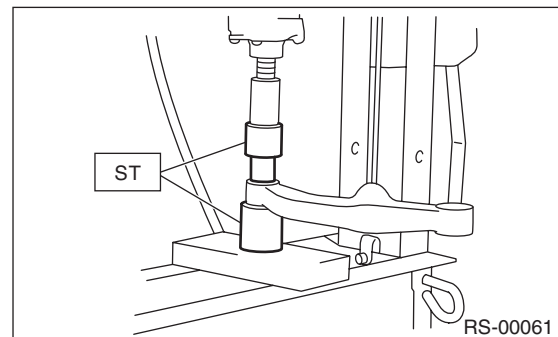

# Upper Link

## REAR SUSPENSION

### D: ASSEMBLY

Using the ST, press the bushing into place.

ST 20099AE010 INSTALLER & REMOVER

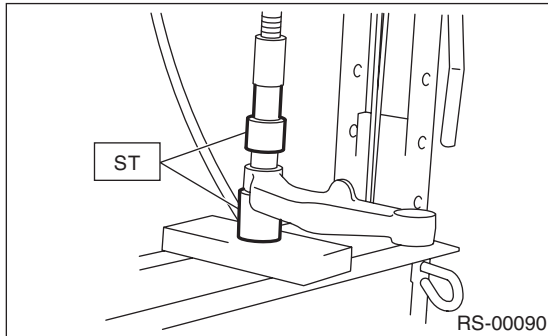

#### CAUTION:

Outer side bushing has an orientation. Assemble it with the longer protrusion faced to the rear side of vehicle.

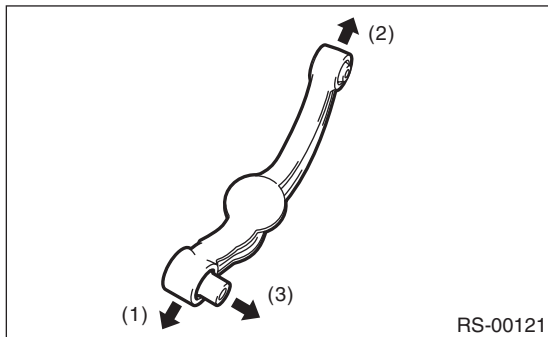

- (1) Rear arm
- (2) Rear sub frame
- (3) Rear side of vehicle

### E: INSPECTION

- 1) Visually check the upper link for damage and deformation.
- 2) Visually check the bushing for crack, damage and fatigue.