

6. Rear Shock Absorber

A: REMOVAL

- 1) Remove the luggage floor mat. (Wagon model)
- 2) Roll up the trunk side trim. (Sedan model)
- 3) Lift up the vehicle, and then remove the rear wheels.
- 4) Remove the bolts which secure the shock absorber to rear arm.

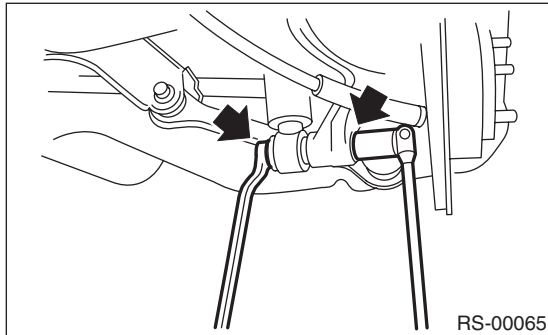

- 5) Support the shock absorber using a jack.
- 6) Remove the nuts which secure the shock absorber mount to vehicle.

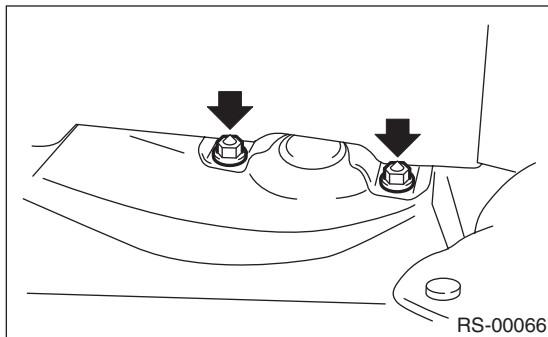

- 7) Remove the shock absorber.

B: INSTALLATION

- 1) Support the shock absorber using a jack.
- 2) Using new self-locking nuts, secure the shock absorber to vehicle.

Tightening torque:

30 N·m (3.1 kgf-m, 22.4 ft-lb)

- 3) Set the vehicle equipped jack upside down, between the rear link and sub frame. Adjust the position of the jack, and align the attachment position of the rear shock absorber and rear arm. Using new self-locking nuts, temporarily tighten the bolt.

CAUTION:

Protect the rear link and sub frame from being damaged by putting a waste cloth between the contact surface with the jack.

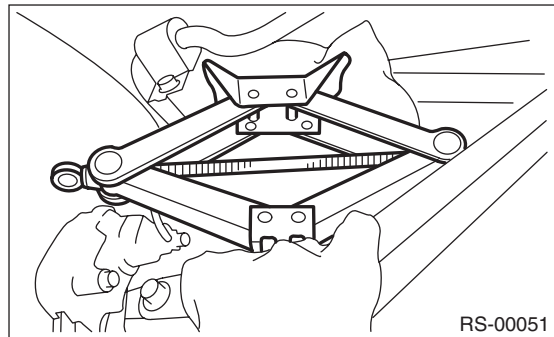

- 4) Support the rear arm horizontally using a transmission jack.
- 5) Using new self-locking nuts, tighten the bolt and nut which secures the shock absorber.

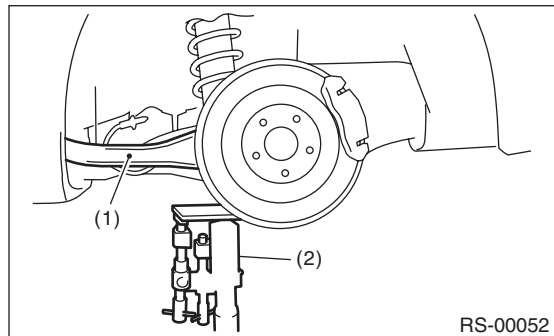

- (1) Rear arm
(2) Transmission jack

Tightening torque:

160 N·m (16.3 kgf-m, 118 ft-lb)

- 6) Install the luggage floor mat. (Wagon model)
- 7) Set the trunk side trim. (Sedan model)

NOTE:

Check the wheel alignment and adjust it if necessary.

Rear Shock Absorber

REAR SUSPENSION

C: DISASSEMBLY

Refer to “Front Strut” for disassembly procedure.
<Ref. to FS-21, DISASSEMBLY, Front Strut.>

D: ASSEMBLY

Refer to “Front Strut” for installation procedures.
<Ref. to FS-21, ASSEMBLY, Front Strut.>

E: INSPECTION

Refer to “Front Strut” for inspection procedures.
<Ref. to FS-22, INSPECTION, Front Strut.>

F: DISPOSAL

CAUTION:

- Before handling the shock absorber, be sure to wear goggles to protect eyes from gas, oil and cutting powder.
- Do not disassemble the shock absorber or place it into a fire.
- Drill a hole into shock absorbers in case of discarding shock absorbers filled with gas.
 - 1) Place the shock absorber on a level surface with the piston rod fully expanded.
 - 2) Make a hole into the specified position 30 mm (1.18 in) deep using a drill with 2 — 3 mm (0.08 — 0.12 in) diameter.

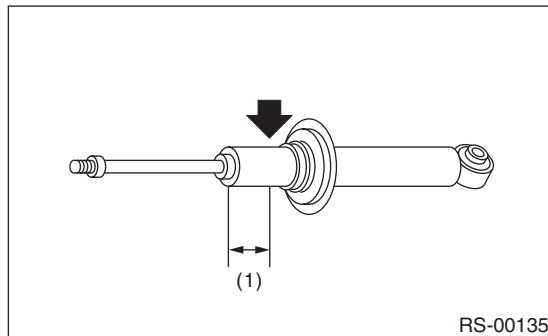

(1) 40 mm (1.57 in)