

7. Front Link

A: REMOVAL

- 1) Lift up the vehicle, and then remove the rear wheels.
- 2) Support the rear arm horizontally using a transmission jack.

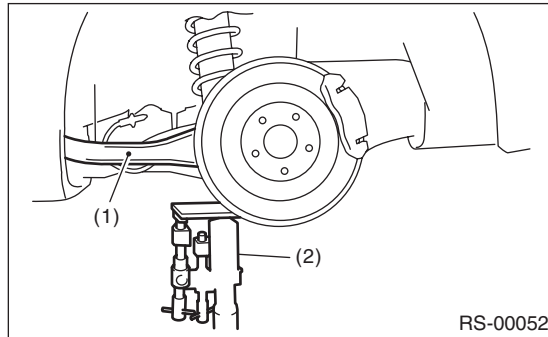

- (1) Rear arm
- (2) Transmission jack

- 3) Remove the bolt which secures the front link to the sub frame.

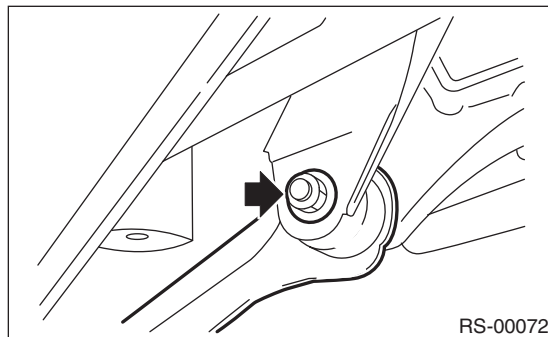

- 4) Remove the bolt which secures the front link to rear arm, then remove the front link.

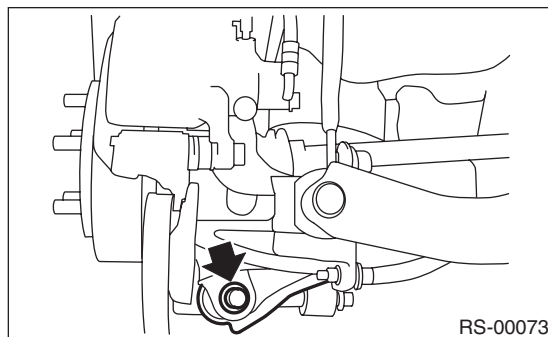

B: INSTALLATION

- 1) Support the rear arm horizontally using a transmission jack.
- 2) Using new self-locking nuts, install the front link.

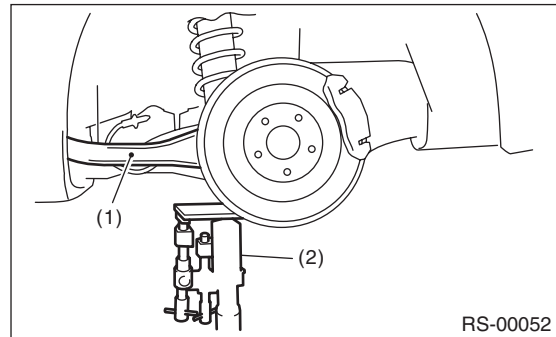

- (1) Rear arm
- (2) Transmission jack

CAUTION:

Install the front link with the protruding side facing the front side of the vehicle.

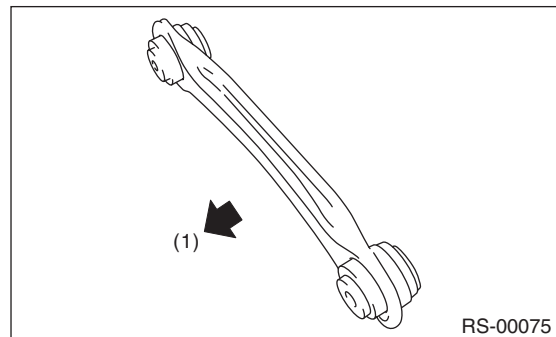

- (1) Front

NOTE:

Inspect the wheel alignment and adjust it if necessary.

Tightening torque:

120 N·m (12.2 kgf·m, 89 ft·lb)

C: INSPECTION

Visually check the front link for damage and deformation.