

8. Rear Link

A: REMOVAL

- 1) Lift up the vehicle, and then remove the rear wheels.
- 2) Remove the rear stabilizer. <Ref. to RS-8, REMOVAL, Rear Stabilizer.>
- 3) Support the rear arm horizontally using a transmission jack.

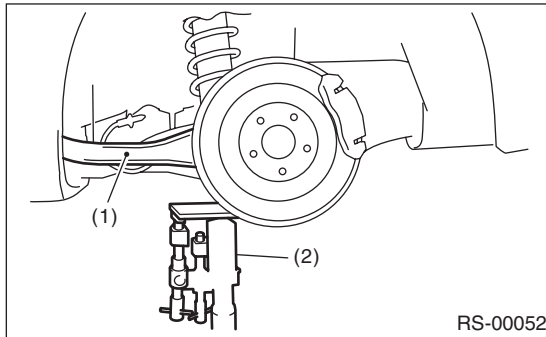

- (1) Rear arm
- (2) Transmission jack

- 4) Remove the bolts which secures the rear link to the rear arm.

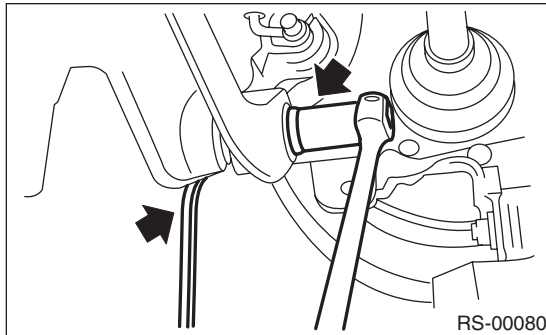

- 5) Place alignment marks on the rear link adjusting bolt and sub frame.
- 6) Remove the bolt which secures the rear link to the sub frame, then remove the rear link.

CAUTION:

When loosening the adjusting bolt, make sure to fix the bolt head in place when loosening the nut.

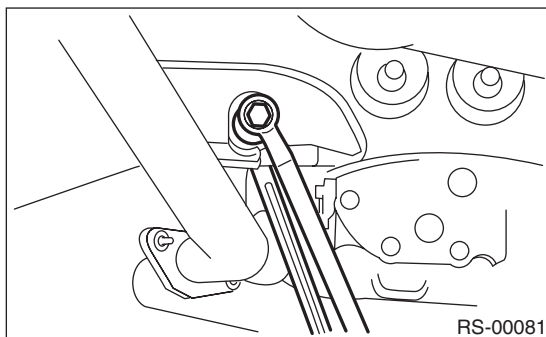

B: INSTALLATION

- 1) Support the rear arm horizontally using a transmission jack.
- 2) Using new self-locking nuts, install the rear link.

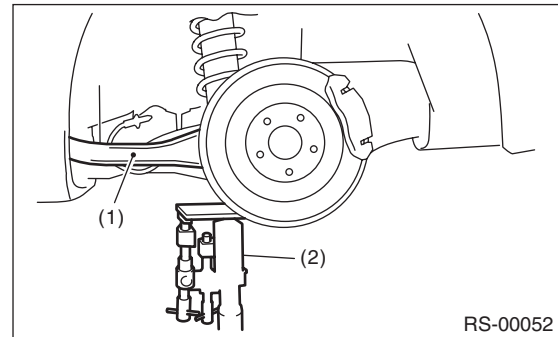

- (1) Rear arm
- (2) Transmission jack

NOTE:

- Tighten the self-locking nut with the bolt head fixed in place when installing the adjusting bolt.
- Inspect the wheel alignment and adjust it if necessary.

Tightening torque:

Rear link-to-Sub frame

120 N·m (12.2 kgf·m, 89 ft·lb)

Rear link-to-Rear arm

120 N·m (12.2 kgf·m, 89 ft·lb)

C: DISASSEMBLY

Using the ST A and ST B, press the bushing out.

ST-A 20099AE000INSTALLER & REMOVER

ST-B 20099AE000INSTALLER & REMOVER

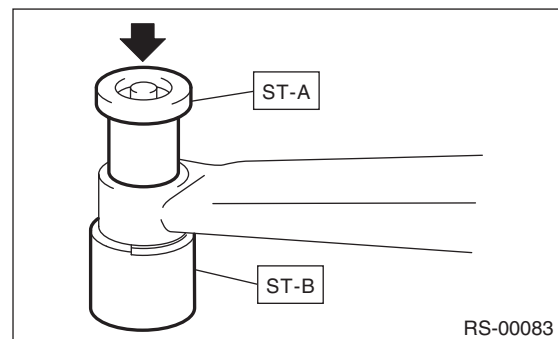

D: ASSEMBLY

Using the ST A and ST B, press-fit the bushing.

ST-A 20099AE000INSTALLER & REMOVER

ST-B 20099AE000INSTALLER & REMOVER

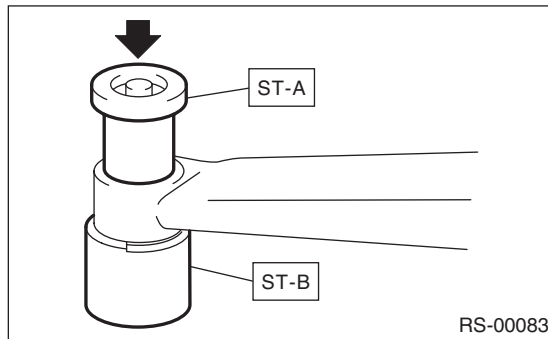

E: INSPECTION

Visually check the rear link for damage and deformation.