

# General Description

## WHEEL AND TIRE SYSTEM

### 1. General Description

#### A: SPECIFICATION

##### 1. WHEEL AND TIRE SYSTEM

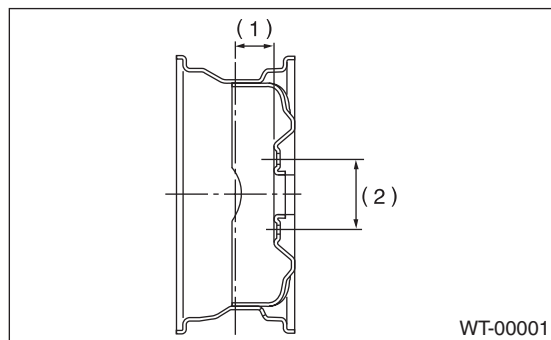

- (1) Offset  
(2) P.C.D.

Specification		Tire size	Wheel size	Offset mm (in)	P.C.D. mm (in)	Tire inflation pressure kPa (kgf/cm <sup>2</sup> , psi)	
						Front wheel	Rear wheel
Sedan	2.5 i, — LTD	P205/50 R17 88V	17 × 7JJ	55 (2.17)	100 (3.94)	230 (2.3, 33)	220 (2.2, 32)
	2.5 GT, — LTD	215/45 ZR17				240 (2.4, 35)	230 (2.3, 33)
	2.5 GT spec. B	215/45 R18 89Y	18 × 7JJ	55 (2.17)		230 (2.3, 33)	220 (2.2, 32)
	OUTBACK 3.0 R	P225/55 R17 95V	17 × 7JJ	48 (1.89)		230 (2.3, 33)	220 (2.2, 32)
Wagon	2.5 i, — LTD	P205/50 R17 88V		55 (2.17)		220 (2.2, 32)	210 (2.1, 30)
	2.5 GT, — LTD	215/45 ZR17	240 (2.4, 35)			230 (2.3, 33)	
	OUTBACK 2.5 i, — LTD	P225/55 R17 95V	48 (1.89)	220 (2.2, 32)		210 (2.1, 30)	
	OUTBACK 3.0 R, — LTD, — LLB						
"T-type" Tire	2.5 i, — LTD	T135/80 R16 101M	16 × 4T	50 (1.97)	420 (4.2, 60)		
	2.5 GT, — LTD	T135/70 D17 102M	17 × 4T	40 (1.57)			
	OUTBACK, 2.5 GT spec. B	T155/70 D17 110M	17 × 4T	40 (1.57)			

### 2. SERVICE DATA

Part	Axial runout	Radial runout
Steel wheel	1.5 mm (0.059 in)	
Aluminum wheel	1.0 mm (0.039 in)	

# General Description

## 3. ADJUSTING PARTS

Wheel balancing	Standard:	Service limit
Dynamic unbalance	10 g (0.35 oz) or less	

Balance weight part number (Knock-on type weight for steel wheels)	Weight
28101AA001	5 g (0.18 oz)
28101AA011	10 g (0.35 oz)
28101AA021	15 g (0.53 oz)
28101AA031	20 g (0.71 oz)
28101AA041	25 g (0.88 oz)
28101AA051	30 g (1.06 oz)
28101AA061	35 g (1.23 oz)
28101AA071	40 g (1.41 oz)
28101AA081	45 g (1.59 oz)
28101AA091	50 g (1.76 oz)
28101AA101	55 g (1.94 oz)
28101AA111	60 g (2.12 oz)

Balance weight part number (Knock-on type weight for aluminum wheel)	Weight
23141GA462	5 g (0.18 oz)
23141GA472	10 g (0.35 oz)
23141GA482	15 g (0.53 oz)
23141GA492	20 g (0.71 oz)
23141GA502	25 g (0.88 oz)
23141GA512	30 g (1.06 oz)
23141GA522	35 g (1.23 oz)
23141GA532	40 g (1.41 oz)
23141GA542	45 g (1.59 oz)
23141GA552	50 g (1.76 oz)
23141GA562	55 g (1.94 oz)
23141GA572	60 g (2.12 oz)

Balance weight part number (Adhesive type weight for aluminum wheel)	Weight
28101AE00B	5 g (0.18 oz)
28101AE01B	7.5 g (0.26 oz)
28101AE02B	10 g (0.35 oz)
28101AE03B	12.5 g (0.44 oz)
28101AE04B	15 g (0.53 oz)
28101AE05B	17.5 g (0.62 oz)
28101AE06B	20 g (0.71 oz)
28101AE07B	22.5 g (0.79 oz)
28101AE08B	25 g (0.88 oz)
28101AE09B	27.5 g (0.97 oz)
28101AE10B	30 g (1.06 oz)
28101AE11B	32.5 g (1.15 oz)
28101AE12B	35 g (1.23 oz)
28101AE13B	37.5 g (1.32 oz)
28101AE14B	40 g (1.41 oz)
28101AE15B	42.5 g (1.50 oz)
28101AE16B	45 g (1.59 oz)
28101AE17B	47.5 g (1.68 oz)
28101AE18B	50 g (1.76 oz)
28101AE19B	52.5 g (1.85 oz)
28101AE20B	55 g (1.94 oz)
28101AE21B	57.5 g (2.03 oz)
28101AE22B	60 g (2.12 oz)
28101AE23B	62.5 g (2.20 oz)
28101AE24B	65 g (2.29 oz)
28101AE25B	67.5 g (2.38 oz)
28101AE26B	70 g (2.47 oz)
28101AE27B	72.5 g (2.56 oz)
28101AE28B	75 g (2.65 oz)
28101AE29B	77.5 g (2.73 oz)
28101AE30B	80 g (2.82 oz)
28101AE31B	82.5 g (2.91 oz)
28101AE32B	85 g (3.00 oz)
28101AE33B	87.5 g (3.09 oz)
28101AE34B	90 g (3.17 oz)
28101AE35B	92.5 g (3.26 oz)
28101AE36B	95 g (3.35 oz)
28101AE37B	97.5 g (3.44 oz)
28101AE38B	100 g (3.53 oz)
28101AG50B	102.5 g (3.62 oz)
28101AG51B	105 g (3.70 oz)
28101AG52B	107.5 g (3.79 oz)
28101AG53B	110 g (3.88 oz)
28101AG54B	112.5 g (3.97 oz)
28101AG55B	115 g (4.06 oz)
28101AG56B	117.5 g (4.14 oz)
28101AG57B	120 g (4.23 oz)

# General Description

## WHEEL AND TIRE SYSTEM

### B: COMPONENT

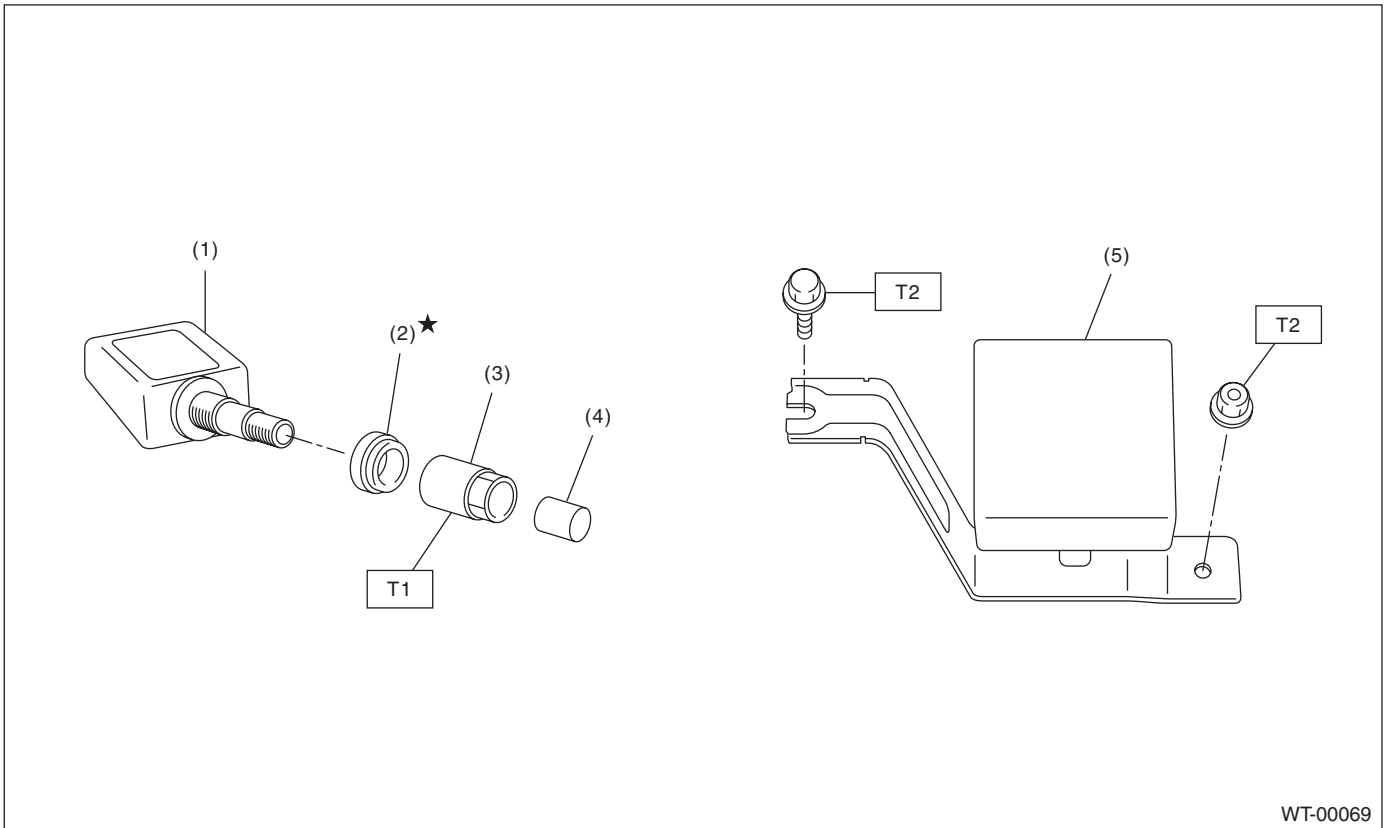

WT-00069

- |                 |                                             |
|-----------------|---------------------------------------------|
| (1) Transmitter | (4) Cap                                     |
| (2) Grommet     | (5) Tire pressure monitoring control module |
| (3) Nut         |                                             |

**Tightening torque: N·m (kgf·m, ft·lb)**

**T1: 7.5 (0.76, 5.53)**

**T2: 8 (0.8, 5.8)**

### C: PREPARATION TOOL

#### 1. GENERAL TOOL

TOOL NAME	REMARKS
Air pressure gauge	Used for measuring tire air pressure.
Dial gauge with magnet stand	Used for measuring wheel runout.
Wheel balancer	Used for adjusting wheel balance.