

General Description

CRUISE CONTROL SYSTEM

1. General Description

A: COMPONENT

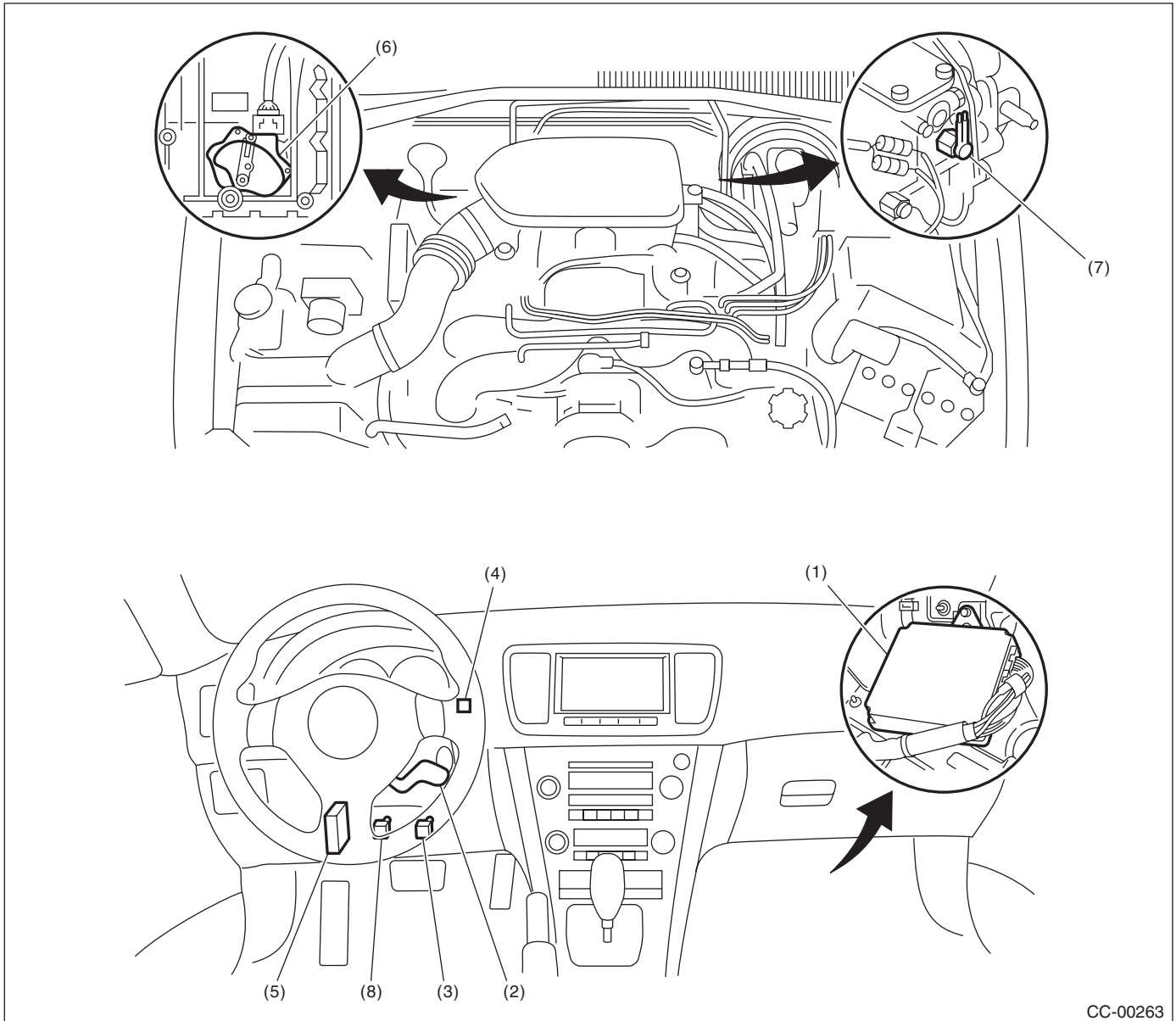

CC-00263

- | | | |
|---|--|--|
| (1) Engine control module (ECM) | (5) Transmission control module (TCM) (AT model) | (7) Neutral position switch (MT model) |
| (2) Cruise control command switch | (6) Inhibitor switch (AT model) | (8) Clutch switch (MT model) |
| (3) Stop light & brake switch | | |
| (4) Cruise indicator light and cruise set indicator light | | |

B: CAUTION

- Before disassembling or reassembling parts, always disconnect the battery ground cable from battery. When repairing the audio, control module, etc. which are provided with memory functions, record the memory contents before disconnecting the ground cable from battery. Otherwise, the memory will be cleared.
- Reassemble the parts in the reverse order of disassembly unless otherwise indicated.
- Adjust the parts to specifications specified in this manual.
- Connect the connectors securely during reassembly.
- After reassembly, ensure functional parts operate properly.

C: PREPARATION TOOL

TOOL NAME	REMARKS
Circuit tester	Used for measuring resistance and voltage.