

4. Seat Heater System

A: REMOVAL

1. SEAT HEATER UNIT

- 1) Remove the front seats. <Ref. to SE-9, REMOVAL, Front Seat.>
- 2) Remove the backrest cover of front seat and seat cushion cover. <Ref. to SE-9, DISASSEMBLY, Front Seat.>
- 3) Remove the hog rings, and then remove the seat heater unit.

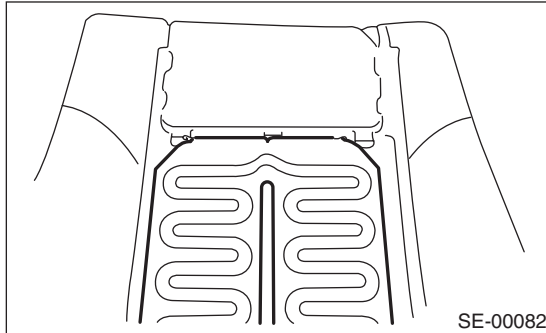

2. SEAT HEATER SWITCH

- 1) Remove the console box. <Ref. to EI-52, REMOVAL, Console Box.>
- 2) Remove the seat heater switch from the console box.

B: INSTALLATION

Install in the reverse order of removal.

C: INSPECTION

1. WIRING DIAGRAM

<Ref. to WI-108, WIRING DIAGRAM, Power Seat System.>

2. SEAT HEATER UNIT

Disconnect the seat heater unit connector, and check the continuity between terminals of connector.

Connector & terminal

- No. 1 — No. 3:**
- No. 1 — No. 4:**
- No. 3 — No. 4:**

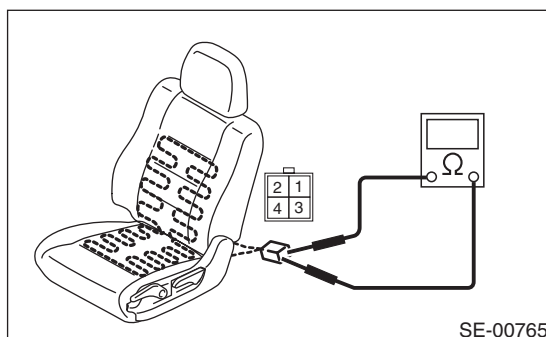

If no continuity exists, replace the seat heater unit with a new part.

3. SEAT HEATER SWITCH

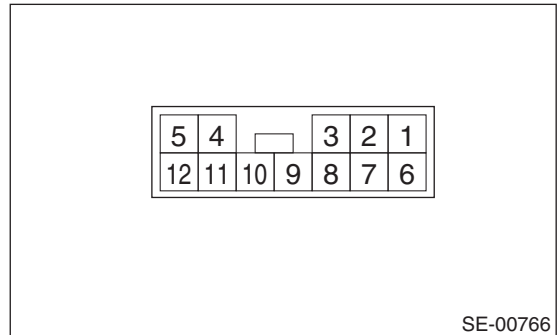

• CHECK THERMISTOR OUTPUT VOLTAGE

- 1) Connect the battery to the connector.
Connector terminals No. 11 (+):
- 2) Measure the voltage between connector and chassis ground.

Connector & terminal:

LHD side seat

(C2) No. 2 (+) — Chassis ground (-):

RHD side seat

(C2) No. 4 (+) — Chassis ground (-):

If voltage is not 1.5 V or more, replace the seat heater switch.

• CHECK SWITCH OUTPUT VOLTAGE

- 1) Connect the battery to the connector.
Connector terminals No. 11 (+):
- 2) Measure the voltage between connector and chassis ground when turning the switch to other than OFF position.

Connector & terminal:

LHD side seat

(C2) No. 10 (+) — Chassis ground (-):

RHD side seat

(C2) No. 5 (+) — Chassis ground (-):

If voltage does not change from 10 V or more to zero, replace the seat heater switch.

SECURITY AND LOCKS

SL

	Page
1. General Description	2
2. Door Lock Control System	7
3. Keyless Entry System	10
4. Security System	25
5. Front Inner Remote	34
6. Front Outer Handle	35
7. Front Door Latch and Door Lock Actuator Assembly	36
8. Front Door Lock Actuator	37
9. Rear Inner Remote	38
10. Rear Outer Handle	39
11. Rear Door Latch and Door Lock Actuator Assembly	40
12. Rear Door Lock Actuator	41
13. Rear Gate Outer Handle	42
14. Rear Gate Latch Assembly	43
15. Trunk Lid Lock Assembly	44
16. Trunk Lid Release Handle	45
17. Front Hood Lock Assembly	46
18. Remote Openers	47
19. Ignition Key Lock	49
20. Key Lock Cylinders	50
21. Security Control Unit	51
22. Impact Sensor	52
23. Keyless Entry Control Module	53
24. Keyless Buzzer	54
25. Body Integrated Unit	55
26. Transmitter	56
27. Immobilizer Control Module	57
28. Immobilizer Antenna	58